



Western Michigan University
ScholarWorks at WMU

Legacy Scout Tickets from Pure Oil Company

8-20-2021

MGRRE_PureOilScoutTickets_State of Michigan_1_21085119500000

MGRRE

Western Michigan University

Follow this and additional works at: <https://scholarworks.wmich.edu/pure>



Part of the Geology Commons

WMU ScholarWorks Citation

MGRRE, "MGRRE_PureOilScoutTickets_State of Michigan_1_21085119500000" (2021). *Legacy Scout Tickets from Pure Oil Company*. 4578.

<https://scholarworks.wmich.edu/pure/4578>

This Document is brought to you for free and open access via ScholarWorks at WMU. It has been accepted for inclusion in Legacy Scout Tickets from Pure Oil Company by an authorized administrator of ScholarWorks at WMU. See the National Digital Catalogue - Science Base Catalogue for more collections submitted by MGRRE.



MGRRE_PureOilScoutTickets_State of Michigan_1_21085119500000

API 21085119500000

Permit Number 11950

Lease Name State of Michigan

Well Number 1

County Lake

Township 17N

Range 12W

Section 27

2021 DEQ or Pure co_name MacCallum, Byron and Craft, Fred W. Trustees

Pure Number 88

Latitude 43.83586

Longitude -85.73581

THE PURE OIL COMPANY

LOCATION REPORT

Date November 7, 1945

A.F.E. No. _____

Division Mich. Producing District _____

State of Mich.
State of Michigan

Acres _____ Lease No. _____ Elevation _____ Well No. 1 (Serial No. 88)

Quadrangle NE-NW-SW Sec. 27 Twp. 17 N Rge. 12 W ~~HICK~~ ~~CURTIS~~ Twp. Yates

Survey _____ County Lake State Michigan

Operator B. MacCallum & F. W. Craft, Tr. Map Yates Township, Lake County

330 330 Feet from North Line of Lease

_____ " " East " " "

_____ " " South " " "

330 330 " " West " " "

330 330 Feet from North Line of Section

_____ " " East " " "

_____ " " South " " "

990 990 " " West " " "

LEGEND

○ Location

☀ Gas Well

● Oil Well

☀ Gas - Distillate Well

○ or ○ Dry Hole

● Dry Showing Oil

☀ Dry Showing Gas

⊗ Abandoned Location

☀ or ☀ Abandoned Gas Well

● or ● Abandoned Oil Well

● or ○ Input Well

map

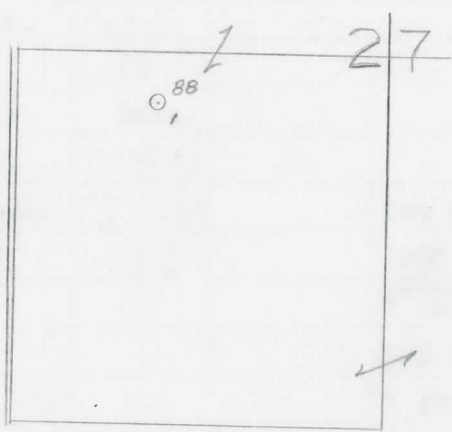

Scale _____

Remarks: _____

Submitted by CB Civil Engineer Approved by _____ Division Manager

Approved by _____ Vice-President - General Manager

LOCATION BEBOKI
THE PURE OIL COMPANY
The Pure Oil Company

COMPLETION RECORD OF WELLS DRILLED BY OTHER OPERATORS

Michigan Producing Division

Date March 27, 1946 No. 88
 State Michigan Co. Lake Dist. Yates Twp. 27 Sec. 17 N Rge. 12 W
 Well No. 1 Serial No. 88 Farm State Acres
 Operator MacCallum & Craft, Tr.
 Date started 12-2-45 Date completed 2-14-46 Elevation 955.6

PRODUCTION RECORD

1st 24 hours natural
 Date of shot No. of quarts From To From to
 Date of acid No. of gallons shot
 1st 24 hours after acid
 Completed as: Oil Well Gas Well Dry Hole X

FORMATION AND CASING RECORD

Formation	Top	Bottom	Top Pay	Bottom Pay	Remarks	Casing	
						Size	Set at
Brown Dolomite	953	Schl.	(+3)			10"	97
Mich. Stray	1048	"	(-92)			6-5/8"	1360
Marshall (-220)	1176	1313	Schl.			5-3/16"	3269
Antrim	2430	2695	(-1474)			5-3/16"	3354
Traverse Lime	2732	S.L.M.	(-1776)		See remarks below.		
Dundee	3269	"	(-2313)		1200 ft. salt water in 6 hrs. 3277-3287. Small show oil and gas 3405-3406. (-2449) ? Inc. in oil show 3409-3413. (-2453)		
					500 ft. fluid 12 hrs. at 3414-1/3rd. oil ? Inc. in oil at 3423. (-2467)		
					1200 ft. salt water & 90 ft. oil in 16 hrs. 3426-3444. (-2470)		
Total Depth		3444	(-2488)				
Plugged back:		3414	(-2458) (-1778)		Swabbed dry at 3426.		(-1787)

Remarks Small show oil and salt water 2734 to 2738 - hole full salt water 2743-2745.
 Treated on 3-20-46 with 500 gals. acid after plugging back to 3414 - no results.
 3265' equals 3265' S.L.M.

Signed D. C. Shackelford