



Western Michigan University
ScholarWorks at WMU

Legacy Scout Tickets from Pure Oil Company

8-20-2021

MGRRE_PureOilScoutTickets_Welke, Harland & Margaret_1_21087107450000

MGRRE

Western Michigan University

Follow this and additional works at: <https://scholarworks.wmich.edu/pure>



Part of the Geology Commons

WMU ScholarWorks Citation

MGRRE, "MGRRE_PureOilScoutTickets_Welke, Harland & Margaret_1_21087107450000" (2021). *Legacy Scout Tickets from Pure Oil Company*. 4625.
<https://scholarworks.wmich.edu/pure/4625>

This Document is brought to you for free and open access via ScholarWorks at WMU. It has been accepted for inclusion in Legacy Scout Tickets from Pure Oil Company by an authorized administrator of ScholarWorks at WMU. See the National Digital Catalogue - Science Base Catalogue for more collections submitted by MGRRE.



MGRRE_PureOilScoutTickets_Welke, Harland & Margaret_1_21087107450000

API 21087107450000

Permit Number 10745

Lease Name Welke, Harland & Margaret

Well Number 1

County Lapeer

Township 10N

Range 10E

Section 21

2021 DEQ or Pure co_name Wilkinson Chemical Corporation

Pure Number 47

Latitude 43.2741647

Longitude -83.3148947

THE PURE OIL COMPANY

LOCATION REPORT

Date May 3, 1944 A.F.E. No. _____
 Division Mich. Producing District _____ Lease Harland & Margaret Welke
 Acres _____ Lease No. _____ Elevation _____ Well No. 1 (Serial No. 47)
 Quadrangle CW 1/2 SW - NW Sec. 21 Twp. 10 N Rge. 10 E Twp. Rich
 Survey _____ County Lapeer State Michigan
 Operator Mammoth Producing Company Map Rich Twp. Lapeer Co.

660 660 Feet from North Line of Lease
 " " East " " "
660 660 " " South " " "
330 330 " " West " " "
 Feet from North Line of Section
 " " East " " "
660 660 " " South " 1/4 "
330 330 " " West " " "

LEGEND

- Location
- ☀ Gas Well
- Oil Well
- ☀ Gas - Distillate Well
- or ○ Dry Hole
- Dry Showing Oil
- ☀ Dry Showing Gas
- ⊗ Abandoned Location
- ☀ or ☀ Abandoned Gas Well
- or ● Abandoned Oil Well
- or ○ Input Well

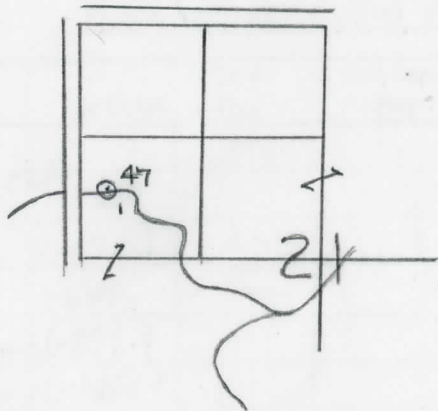

Remarks: _____

Scale _____

Submitted by RN Civil Engineer Approved by _____ Division Manager
 Approved by _____ Vice-President - General Manager

Division

Michigan Producing

Date September 13, 1944 No. 47
 State Mich. County Lapeer Dist. xxxx Sec. 21 Twp. 10 N Rge. 10 E
 Well No. 1 xxxxxxxxxx 47 Farm H. & M. Welke Acres xxxx
 Operator Mammoth Producing Company Information secured from xxxx Scouting Department
 Date well started 5-27-44 Date well completed 9-7-44 Elevation 801.0

PRODUCTION BOARD

1st 24 hours natural Dry Hole
 2nd 24 hours natural
 Date of shot No. of quarts From to From to
 Date of acid No. of gallons
 1st 24 hours after acid shot
 2nd 24 hours after acid shot

FORMATION AND CASING RECORD

Formation	Top	Bottom	Top Pay	Bottom Pay	Remarks	Casing	
						Size	Set at
Marshall	190 <i>(+64)</i>	350				10"	116
Sunbury	1375	1574 <i>(-199)</i>				8-1/4"	411
Berea	1430	1629 <i>(-199)</i>			H.F.W. in Berea.	6-5/8"	1655
Antrim	1680	1879 <i>(-199)</i>				5-3/16"	3268
Traverse Lime	1889	1088 <i>(-1801)</i>			Show salt water 1890-exhausted.		
Dundee	2400	1599 <i>(-801)</i>			V. Small show oil at	2459.	1658 <i>(-1801)</i>
Monroe	2625	1824 <i>(-801)</i>			Water (2500 ft.) at 2605. <i>(-1804)</i>		
Total Depth		3315		12514 <i>(-1801)</i>	See remarks below.		

Remarks Hole full black salt water 2896 - Sylvania 3305-3315 - 3000 ft. salt water from 3305-3315.
3001' CTM equals 3001' SLM.

Signed D. C. Shackelford