



Western Michigan University  
ScholarWorks at WMU

---

Legacy Scout Tickets from Pure Oil Company

---

8-20-2021

**MGRRE\_PureOilScoutTickets\_Busey, Samuel  
T.\_1\_21091037930000**

MGRRE  
*Western Michigan University*

Follow this and additional works at: <https://scholarworks.wmich.edu/pure>



Part of the Geology Commons

---

#### **WMU ScholarWorks Citation**

MGRRE, "MGRRE\_PureOilScoutTickets\_Busey, Samuel T.\_1\_21091037930000" (2021). *Legacy Scout Tickets from Pure Oil Company*. 4647.  
<https://scholarworks.wmich.edu/pure/4647>

This Document is brought to you for free and open access via ScholarWorks at WMU. It has been accepted for inclusion in Legacy Scout Tickets from Pure Oil Company by an authorized administrator of ScholarWorks at WMU. See the National Digital Catalogue - Science Base Catalogue for more collections submitted by MGRRE.



---

**MGRRE\_PureOilScoutTickets\_Busey, Samuel T.\_1\_21091037930000**

API 21091037930000

Permit Number 3793

Lease Name Busey, Samuel T.

Well Number 1

County Lenawee

Township 06S

Range 05E

Section 25

2021 DEQ or Pure co\_name Michigan Pacific Oil and Gas Company

Pure Number 21

Latitude 41.92494

Longitude -83.77105

THE PURE OIL COMPANY

DATE January 14, 1937

LOCATION REPORT

No. 21

STATE Michigan COUNTY Lenawee DIST. Deerfield TWP. Deerfield SEC. 25 TOWN 6 S RANGE 5 E

WELL No. 11 (SERIAL No. 21) FARM Samuel T. Busey ACRES

NAME OF STREAM OR WATERS QUADRANGLE NE-SE-SE, NE SE SE

OPERATOR Michigan Pacific Oil & Gas Company Map Deerfield Township, Lenawee County  
Mich. Pacific Oil & Gas Co. Deerfield - Lenawee Co.

Feet from North Line of Farm  
225225 " " East " " "  
225225 " " South " " "  
 " " West " " "

Feet from North Line of Section  
225225 " " East " " "  
885885 " " South " " "  
 " " West " " "

*Low.*

LEGEND

- LOCATION
- ⊙ RIG
- ⊕ DRILLING
- ☀ GAS WELL
- OIL WELL
- ⦿ SMALL OIL WELL
- ⊖ DRY HOLE
- ⊙ DRY SHOWING OIL
- ☀ DRY SHOWING GAS
- ⊖ ABANDONED LOCATION
- ☀ ABANDONED GAS WELL
- ⦿ ABANDONED OIL WELL

NOTE: Below make tracing from map, (when no map is obtainable make sketch) showing farm, center of section, this location with measurements and also wells, dry holes, or other locations in the vicinity of this location.

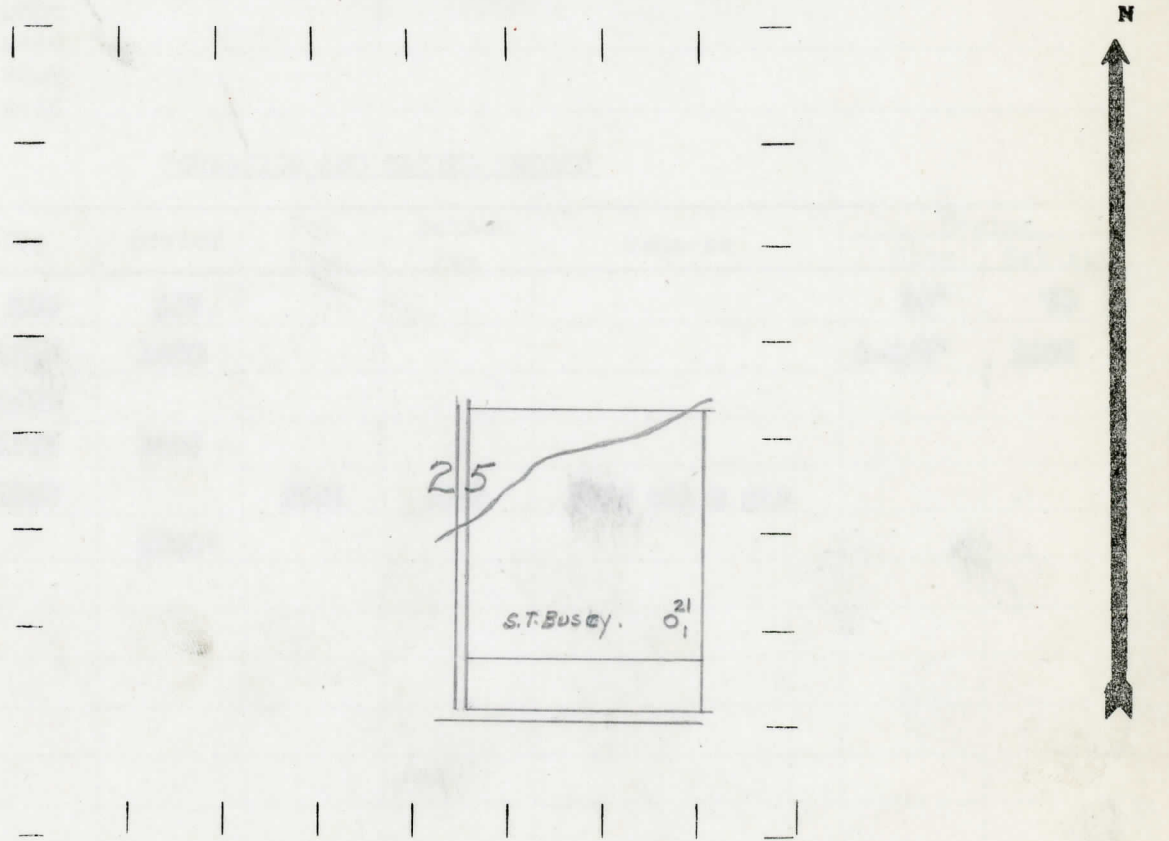

REMARKS:

SIGNED

*R.L. Yeager*

Superintendent or Foreman.

COMPLETION RECORD OF WELLS DRILLED BY OTHER OPERATORS

Michigan Producing Division

Date March 25, 1937 No. 21  
 State Michigan County Lenawee Dist. \_\_\_\_\_  
 Twp. Deerfield Sec. 25 Twp. 7 S Rge. 5 E  
 Well No. 1 (Serial No.) \_\_\_\_\_  
 (County No.) 21 Farm Samuel T. Bussey Acres \_\_\_\_\_  
 Operator Michigan Pacific Oil & Gas Co. Information secured by Scouting Department  
 Date well started 1-23-37 Date well completed 3-20-37 Elevation 681.5

PRODUCTION RECORD

1st 24 hours natural Dry Hole  
 2nd 24 hours natural \_\_\_\_\_  
 Date of shot \_\_\_\_\_ No. of quarts \_\_\_\_\_ From \_\_\_\_\_ to \_\_\_\_\_ From \_\_\_\_\_ to \_\_\_\_\_  
 Date of acid \_\_\_\_\_ No. of gallons \_\_\_\_\_  
 shot \_\_\_\_\_  
 1st 24 hours after acid \_\_\_\_\_  
 shot \_\_\_\_\_  
 2nd 24 hours after acid \_\_\_\_\_

FORMATION AND CASING RECORD

Formation	Top	Bottom	Top Pay	Bottom Pay	Remarks	Casing	
						Size	Set At
Sylvania	240	367				10"	74
Niagaran	1313	1480				8-5/8"	1483
Clinton	1480						
Red Rock	1685	1695					
Trenton	2250		2263	2269	Show oil & gas		
Total Depth		2540'					

Remarks Water 60'-water 80'-sulphur water 240'.

Signed \_\_\_\_\_ Geo. H. Bell