



Western Michigan University
ScholarWorks at WMU

Legacy Scout Tickets from Pure Oil Company

8-20-2021

MGRRE_PureOilScoutTickets_Gove, Irving_1_21091075980000

MGRRE

Western Michigan University

Follow this and additional works at: <https://scholarworks.wmich.edu/pure>



Part of the Geology Commons

WMU ScholarWorks Citation

MGRRE, "MGRRE_PureOilScoutTickets_Gove, Irving_1_21091075980000" (2021). *Legacy Scout Tickets from Pure Oil Company*. 4649.

<https://scholarworks.wmich.edu/pure/4649>

This Document is brought to you for free and open access via ScholarWorks at WMU. It has been accepted for inclusion in Legacy Scout Tickets from Pure Oil Company by an authorized administrator of ScholarWorks at WMU. See the National Digital Catalogue - Science Base Catalogue for more collections submitted by MGRRE.



MGRRE_PureOilScoutTickets_Gove, Irving_1_21091075980000

API 21091075980000

Permit Number 7598

Lease Name Gove, Irving

Well Number 1

County Lenawee

Township 05S

Range 04E

Section 8

2021 DEQ or Pure co_name Voorhees Drilling Company

Pure Number 23

Latitude 42.05241

Longitude -83.98265

DATE May 1, 1940

LOCATION REPORT

No. 23

STATE Michigan COUNTY Lenawee DIST. Clinton TWP. Clinton SEC. 88 TOWN 585 RANGE 4 E
WELL No. 1 (SERIAL No. 233) FARM Irving Gove ACRES

NAME OF STREAM OR WATERS _____ QUADRANGLE NE SW SW

OPERATOR Voorhees Drilling Company, et al Map Clinton Township, Lenawee County

330 330 Feet from North Line of Farm

“ “ East “ “ “

“ “ South “ “ “

330 330 “ “ West “ “ “

Feet from North Line of Section

“ “ East “ “ “

990 990 “ “ South “ 1/4 “

990 990 “ “ West “ “ “

Rig

LEGEND

○ LOCATION

⊕ RIG

⊕ DRILLING

☀ GAS WELL

● OIL WELL

● SMALL OIL WELL

⊙ DRY HOLE

◆ DRY SHOWING OIL

⊙ DRY SHOWING GAS

⊙ ABANDONED LOCATION

☀ ABANDONED GAS WELL

● ABANDONED OIL WELL

NOTE: Below make tracing from map. (when no map is obtainable make sketch) showing farm, center of section, this location with measurements and also wells, dry holes, or other locations in the vicinity of this location.

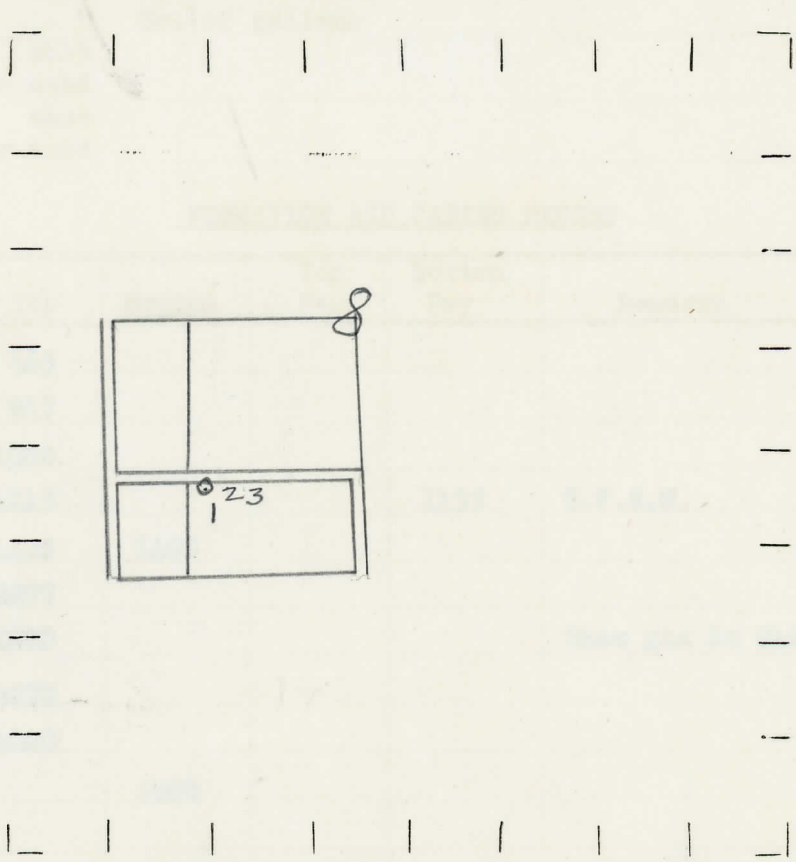

REMARKS:

SIGNED

W

Subintendent or Foreman.

Michigan Producing Division

Date September 11, 1940 No. 23
 State Mich. County Lenawee Dist. Clinton
 (Serial No.) Twp. Clinton Sec. 8 Twp. 5 S Rge. 4 E
 Well No. 1 (County No.) 23 Farm Irving Gove Acres _____
 Operator Voorhees Drilling Co., et al Information secured from Scouting Department
 Date well started 4-29-40 Dated well completed 9-5-40 Elevation 833.9

PRODUCTION RECORD

1st 24 hours natural Dry Hole
 2nd 24 hours natural _____
 Date of shot _____ No. of quarts _____ From _____ to _____
 Date of acid _____ No. of gallons _____
 1st 24 hours after acid shot _____
 2nd 24 hours after acid shot _____

FORMATION AND CASING RECORD

Formation	Top	Bottom	Top Pay	Bottom Pay	Remarks	Casing	
						Size	Set at
Antrim	665					10"	183
Traverse Form.	947					6-5/8"	2675
Traverse Lime	1000						
Dundee	1115			1135	H.F.S.W.		
Sylvania	1420	1495					
Niagaran	2297						
Clinton	2480				Show gas in Clinton.		
Trenton	3270						
St. Peters ??	4040						
Total Depth		4060					

Remarks _____

Signed D. C. Shackelford