



Western Michigan University
ScholarWorks at WMU

Legacy Scout Tickets from Pure Oil Company

8-20-2021

**MGRRE_PureOilScoutTickets_R. J. & M.
McCarbery_1_21091075990000**

MGRRE
Western Michigan University

Follow this and additional works at: <https://scholarworks.wmich.edu/pure>



Part of the Geology Commons

WMU ScholarWorks Citation

MGRRE, "MGRRE_PureOilScoutTickets_R. J. & M. McCarbery_1_21091075990000" (2021). *Legacy Scout Tickets from Pure Oil Company*. 4650.
<https://scholarworks.wmich.edu/pure/4650>

This Document is brought to you for free and open access via ScholarWorks at WMU. It has been accepted for inclusion in Legacy Scout Tickets from Pure Oil Company by an authorized administrator of ScholarWorks at WMU. See the National Digital Catalogue - Science Base Catalogue for more collections submitted by MGRRE.



MGRRE_PureOilScoutTickets_R. J. & M. McCarbery_1_21091075990000

API 21091075990000

Permit Number 7599

Lease Name R. J. & M. McCarbery

Well Number 1

County Lenawee

Township 05S

Range 05E

Section 36

2021 DEQ or Pure co_name Lenawee Oil and Gas Company

Pure Number 24

Latitude 42.00871

Longitude -83.7856

DATE May 1, 1940

LOCATION REPORT

No. 24

STATE Michigan COUNTY Lenawee DIST. Macon TWP. Macon SEC. 36 TOWN 5 S RANGE 5 E
WELL No. 1 (SERIAL No. 24) FARM R. J. & M. McCarbery ACRES

NAME OF STREAM OR WATERS _____ QUADRANGLE NW NE NW

OPERATOR Lenawee Oil & Gas Company Map Macon Township, Lenawee County

330 330 Feet from North Line of Farm

" " East " " "

" " South " " "

220 220 " " West " " "

330 330 Feet from North Line of Section

1090 1090 " " East " " "

" " South " " "

" " West " " "

Low

LEGEND

- LOCATION
- ⊕ RIG
- ⊕ DRILLING
- ☀ GAS WELL
- OIL WELL
- SMALL OIL WELL
- ⊖ DRY HOLE
- DRY SHOWING OIL
- ☀ DRY SHOWING GAS
- ⊖ ABANDONED LOCATION
- ☀ ABANDONED GAS WELL
- ABANDONED OIL WELL

NOTE: Below make tracing from map, (when no map is obtainable make sketch) showing farm, center of section, this location with measurements and also wells, dry holes, or other locations in the vicinity of this location.

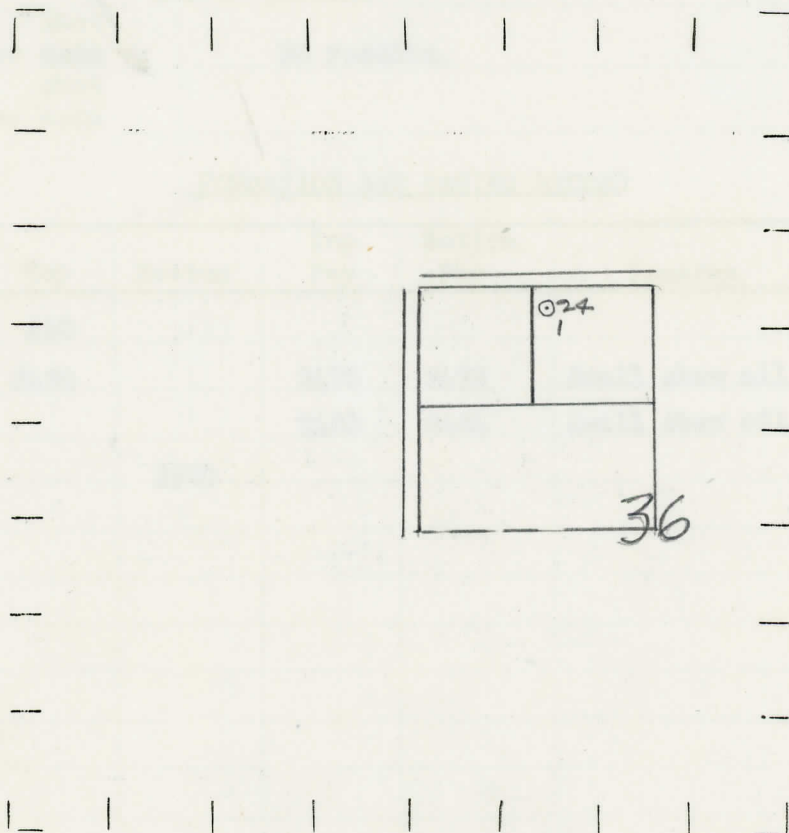

REMARKS:

SIGNED

W

Subintendent or Foreman.

