



Western Michigan University  
ScholarWorks at WMU

---

Legacy Scout Tickets from Pure Oil Company

---

8-20-2021

**MGRRE\_PureOilScoutTickets\_White, Henry\_1\_21093004819000**

MGRRE

*Western Michigan University*

Follow this and additional works at: <https://scholarworks.wmich.edu/pure>



Part of the Geology Commons

---

#### **WMU ScholarWorks Citation**

MGRRE, "MGRRE\_PureOilScoutTickets\_White, Henry\_1\_21093004819000" (2021). *Legacy Scout Tickets from Pure Oil Company*. 4661.

<https://scholarworks.wmich.edu/pure/4661>

This Document is brought to you for free and open access via ScholarWorks at WMU. It has been accepted for inclusion in Legacy Scout Tickets from Pure Oil Company by an authorized administrator of ScholarWorks at WMU. See the National Digital Catalogue - Science Base Catalogue for more collections submitted by MGRRE.



---

**MGRRE\_PureOilScoutTickets\_White, Henry\_1\_21093004819000**

API 21093004819000

Permit Number 481

Lease Name White, Henry

Well Number 1

County Livingston

Township 03N

Range 04E

Section 6

2021 DEQ or Pure co\_name Fowlerville Oil Well

Pure Number 2

Latitude 42.67973

Longitude -84.02484

7-10-34

THE PURE OIL COMPANY

DATE 7/10/34 *Completion* LOCATION REPORT COMPLETION No. 2  
*Mich* *Livingston* DIST. *Howell* SEC. 66 TOWN 3N RANGE 4E  
 STATE Michigan COUNTY Livingston TWP. Howell PREC. Henry White FARM Henry White ACRES  
 WELL No. 1 (SERIAL No. 2)

NAME OF STREAM OR WATERS \_\_\_\_\_ QUADRANGLE NW-NW-NW  
NW-NW-NW

OPERATOR Fowlerville Oil Well MAP Howell Township, Livingston County  
Fowlerville Oil Well Howell Twp- Livingston Co.

Feet from North Line of Farm

----- " " East " " "

----- " " South " " "

----- " " West " " "

330 330 Feet from North Line of Section

----- " " East " " "

----- " " South " " "

330 330 " " West " " "

LEGEND

- O LOCATION
- ① RIG
- ⊕ DRILLING
- ⊗ GAS WELL
- OIL WELL
- ⊙ SMALL OIL WELL
- ⊛ DRY HOLE
- ⊕ DRY SHOWING OIL
- ⊗ DRY SHOWING GAS
- ⊙ ABANDONED LOCATION
- ⊗ ABANDONED GAS WELL
- ⊙ ABANDONED OIL WELL

NOTE: Below make tracing from map, (when no map is obtainable make sketch) showing farm, center of section, this location with measurements and also wells, dry holes, or other locations in the vicinity of this location. Make copy to keep for reference and send original to Columbus office.

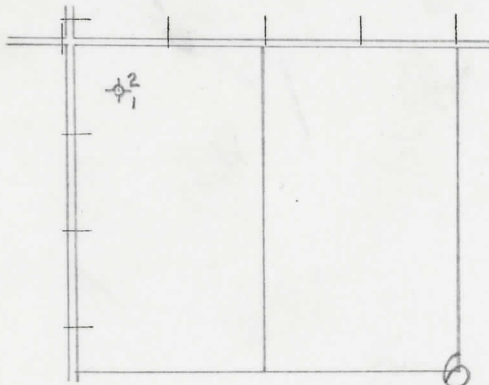

Elev. 915' Est.  
 Pleistocene - 0-128  
 Sandrock - 128-136  
 Blue sh. 136-166.  
 30' Oil + gas flow  
 Est. 1/2 bbl day.

Elevation 915' Est.  
 Pleistocene — 0-128  
 Sandrock 128-136  
 Blue Shale 136-166  
 30' Oil & Gas Flow - Est. 1/2 bbl. per day.



REMARKS:

SIGNED

*R. L. Yager*  
 Superintendent or Foreman.