



Western Michigan University  
ScholarWorks at WMU

---

Legacy Scout Tickets from Pure Oil Company

---

8-20-2021

## MGRRE\_PureOilScoutTickets\_Allen, J. B.\_1\_unk

MGRRE

*Western Michigan University*

Follow this and additional works at: <https://scholarworks.wmich.edu/pure>



Part of the Geology Commons

---

### WMU ScholarWorks Citation

MGRRE, "MGRRE\_PureOilScoutTickets\_Allen, J. B.\_1\_unk" (2021). *Legacy Scout Tickets from Pure Oil Company*. 4689.

<https://scholarworks.wmich.edu/pure/4689>

This Document is brought to you for free and open access via ScholarWorks at WMU. It has been accepted for inclusion in Legacy Scout Tickets from Pure Oil Company by an authorized administrator of ScholarWorks at WMU. See the National Digital Catalogue - Science Base Catalogue for more collections submitted by MGRRE.



---

MGRRE\_PureOilScoutTickets\_Allen, J. B.\_1\_unk

API unk

Permit Number unk

Lease Name Allen, J. B.

Well Number 1

County Livingston

Township 04N

Range 03E

Section 19

2021 DEQ or Pure co\_name F. Chapman

Pure Number 53

Latitude 42.721353

Longitude -84.1440914

THE PURE OIL COMPANY

DATE February 5, 1934 COMPLETION & LOCATION REPORT

No. 53

STATE Michigan COUNTY Livingston DIST. Conway TWP. Conway SEC. 19 TOWN 4 N RANGE 3 E

WELL No. 1 (SERIAL No. 53) FARM J. B. Allen (4" Water Well) ACRES

NAME OF STREAM OR WATERS QUADRANGLE NW-NE-NW

OPERATOR Drilled by F. Chapman MAP Conway Township, Livingston County

Feet from North Line of Farm

" " East " " "

" " South " " "

" " West " " "

300 Feet from North Line of Section

" " East " " "

" " South " " "

1060 " " West " " "

**LEGEND**

- LOCATION
- ⊕ RIG
- ⊕ DRILLING
- ⊙ GAS WELL
- OIL WELL
- ◆ SMALL OIL WELL
- ⊙ DRY HOLE
- ◆ DRY SHOWING OIL
- ⊙ DRY SHOWING GAS
- ⊙ ABANDONED LOCATION
- ⊙ ABANDONED GAS WELL
- ⊙ ABANDONED OIL WELL

NOTE: Below make tracing from map, (when no map is obtainable make sketch) showing farm, center of section, this location with measurements and also wells, dry holes, or other locations in the vicinity of this location. Make copy to keep for reference and send original to Columbus office.

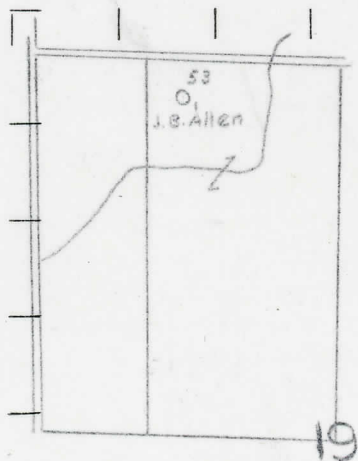

Drift - 91'

Lower Marshall - 91'

REMARKS: Of Geological Importance

SIGNED

Superintendent or Foreman.