



Western Michigan University  
ScholarWorks at WMU

---

Legacy Scout Tickets from Pure Oil Company

---

8-20-2021

**MGRRE\_PureOilScoutTickets\_Curdy, Isabel\_1\_21093035100000**

MGRRE

*Western Michigan University*

Follow this and additional works at: <https://scholarworks.wmich.edu/pure>



Part of the Geology Commons

---

#### **WMU ScholarWorks Citation**

MGRRE, "MGRRE\_PureOilScoutTickets\_Curdy, Isabel\_1\_21093035100000" (2021). *Legacy Scout Tickets from Pure Oil Company*. 4692.

<https://scholarworks.wmich.edu/pure/4692>

This Document is brought to you for free and open access via ScholarWorks at WMU. It has been accepted for inclusion in Legacy Scout Tickets from Pure Oil Company by an authorized administrator of ScholarWorks at WMU. See the National Digital Catalogue - Science Base Catalogue for more collections submitted by MGRRE.



---

**MGRRE\_PureOilScoutTickets\_Curdy, Isabel\_1\_21093035100000**

API 21093035100000

Permit Number 3510

Lease Name Curdy, Isabel

Well Number 1

County Livingston

Township 03N

Range 05E

Section 18

2021 DEQ or Pure co\_name Flanigan, James E.

Pure Number 56

Latitude 42.65006

Longitude -83.89792

DATE August 27, 1936

LOCATION REPORT

No. 56

STATE Michigan COUNTY Livingston DIST. Oceola SEC. 18 TOWN 3 N RANGE 5 E

WELL No. 1 (SERIAL No. 56) FARM Isabel Curdy ACRES

NAME OF STREAM OR WATERS \_\_\_\_\_ QUADRANGLE NE-NE-SE, NE NE SE

OPERATOR James E. Flannigan Map Oceola Township, Livingston County  
James E. Flannigan

575 Feet from North Line of Farm

550 " " East " " "

" " South " " "

" " West " " "

575 Feet from North Line of Section

550 " " East " " "

" " South " " "

" " West " " "

*Loc.*

LEGEND

- LOCATION
- ⊕ RIG
- ⊕ DRILLING
- ☀ GAS WELL
- OIL WELL
- SMALL OIL WELL
- ⊙ DRY HOLE
- DRY SHOWING OIL
- ☀ DRY SHOWING GAS
- ⊙ ABANDONED LOCATION
- ☀ ABANDONED GAS WELL
- ABANDONED OIL WELL

NOTE: Below make tracing from map, (when no map is obtainable make sketch) showing farm, center of section, this location with measurements and also wells, dry holes, or other locations in the vicinity of this location.

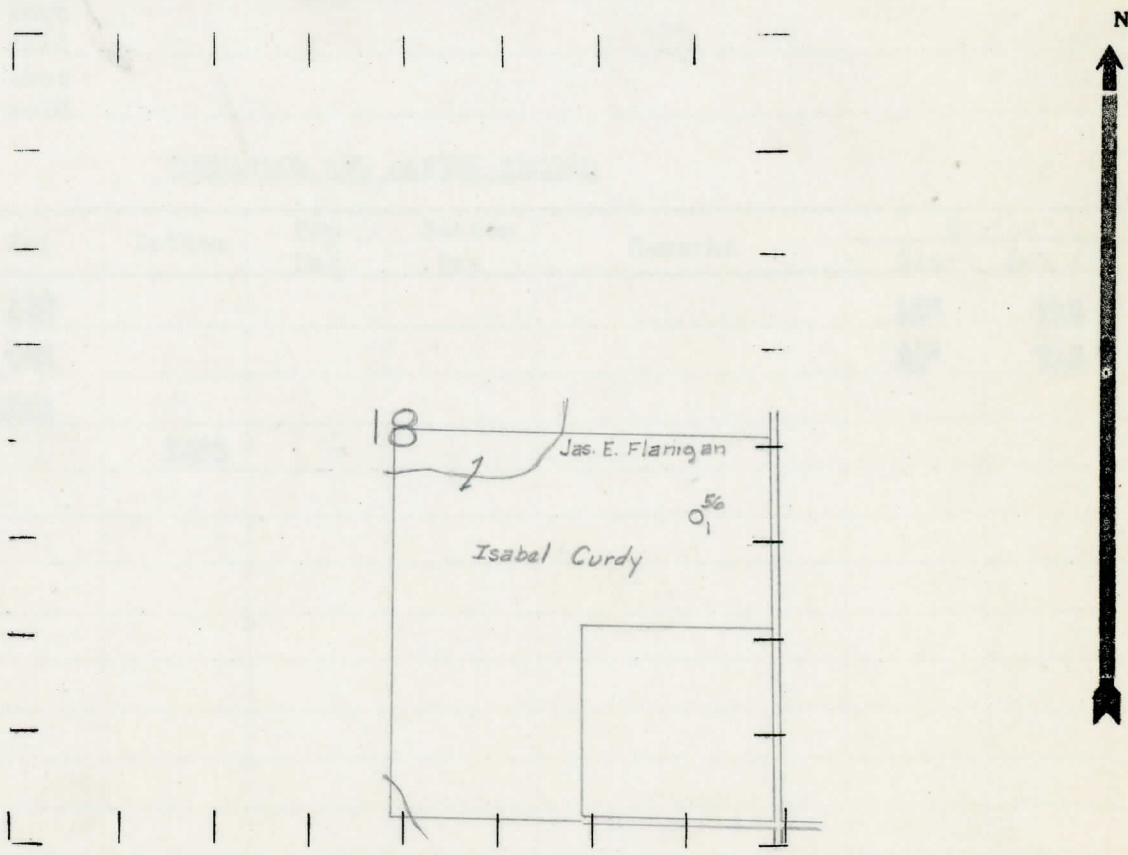

REMARKS:

SIGNED

R. L. Yeager  
 Superintendent or Foreman.

