



Western Michigan University
ScholarWorks at WMU

Legacy Scout Tickets from Pure Oil Company

8-20-2021

MGRRE_PureOilScoutTickets_Herbst, L._1_21093088480000

MGRRE

Western Michigan University

Follow this and additional works at: <https://scholarworks.wmich.edu/pure>



Part of the Geology Commons

WMU ScholarWorks Citation

MGRRE, "MGRRE_PureOilScoutTickets_Herbst, L._1_21093088480000" (2021). *Legacy Scout Tickets from Pure Oil Company*. 4696.

<https://scholarworks.wmich.edu/pure/4696>

This Document is brought to you for free and open access via ScholarWorks at WMU. It has been accepted for inclusion in Legacy Scout Tickets from Pure Oil Company by an authorized administrator of ScholarWorks at WMU. See the National Digital Catalogue - Science Base Catalogue for more collections submitted by MGRRE.



MGRRE_PureOilScoutTickets_Herbst, L._1_21093088480000

API 21093088480000

Permit Number 8848

Lease Name Herbst, L.

Well Number 1

County Livingston

Township 02N

Range 05E

Section 24

2021 DEQ or Pure co_name Fisher McCall Oil and Gas, Incorporated and Strom, E. B. Trustee

Pure Number 60

Latitude 42.55156

Longitude -83.8099

THE PURE OIL COMPANY

DATE August 20, 1941

LOCATION REPORT

No. 60

COMPLETION RECORD OF WELLS DRILLED BY OTHER OPERATORS

STATE Michigan COUNTY Livingston DIST. Genoa TWP. Genoa SEC. 24 TOWN 2N RANGE 5E
WELL No. 1 (SERIAL No. 60) FARM L. Herbst ACRES

NAME OF STREAM OR WATERS QUADRANGLE SE-SW-NW

OPERATOR Fisher-McCall Oil and Gas, Inc., and E.B. Strom, Tr. Map Genoa Township, Livingston County
Fisher-McCall Oil & Gas Inc + E.B. Strom Tr. Genoa - Livingston

Feet from North Line of Farm
330 330 " " East " " "
330 330 " " South " " "
" " West " " "

Feet from North Line of Section
" " East " " "
330 330 " " South " 1/4 "
990 990 " " West " " "

LEGEND

- LOCATION
- ⊕ RIG
- ⊕ DRILLING
- ☀ GAS WELL
- OIL WELL
- ⬮ SMALL OIL WELL
- ⊖ DRY HOLE
- ⬮ DRY SHOWING OIL
- ☀ DRY SHOWING GAS
- ⊖ ABANDONED LOCATION
- ☀ ABANDONED GAS WELL
- ⬮ ABANDONED OIL WELL

NOTE: Below make tracing from map, (when no map is obtainable make sketch) showing farm, center of section, this location with measurements and also wells, dry holes, or other locations in the vicinity of this location.

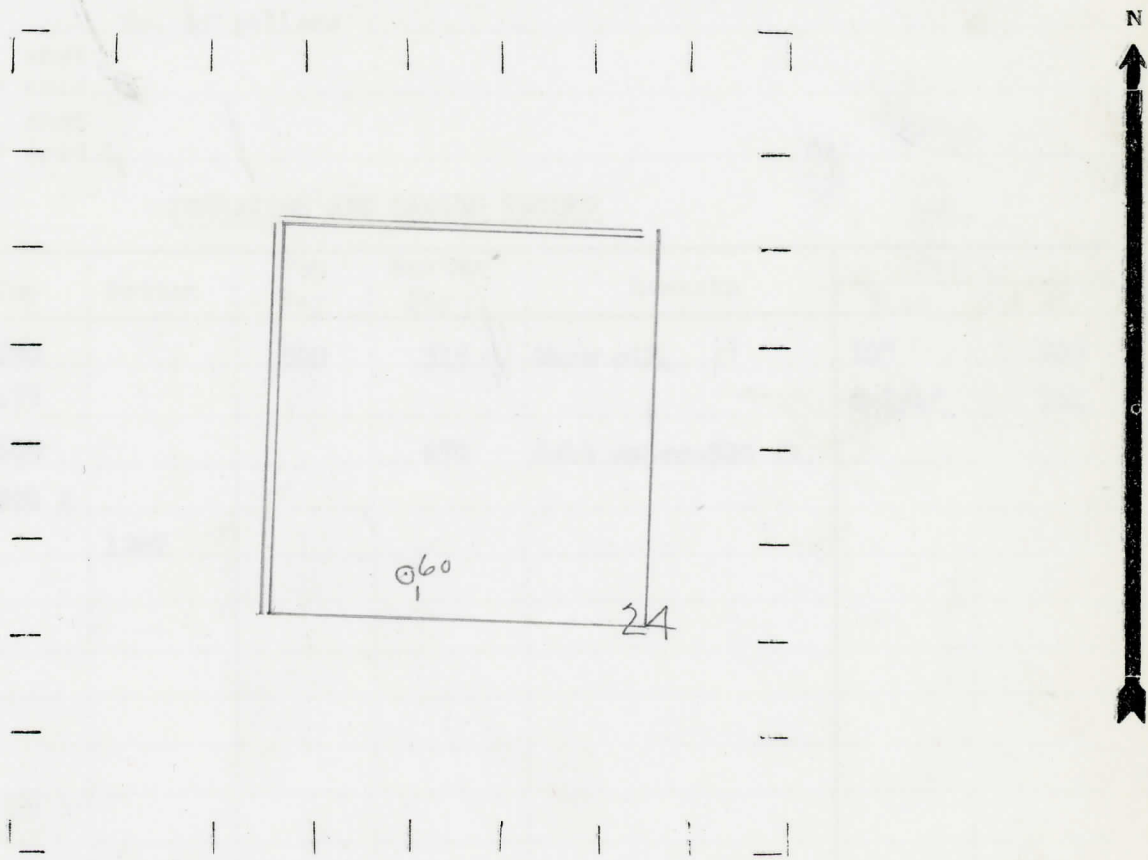

REMARKS:

SIGNED W
Superintendent or Foreman.

Date September 24, 1941 No. 60
 State Mich. County Livingston Dist. Genoa
 (Serial No.) Twp. Genoa Sec. 24 Twp. 2 N Rge. 5 E
 Well No. 1 (County No.) 60 Farm Herbst Acres _____
 Operator Fisher-McCall Oil & Gas, Inc., et al Information secured By Scoutng Department
 Date well started 8-19-41 Date well completed 9-6-41 Elevation 970.0

PRODUCTION RECORD

1st 24 hours natural _____ Temporarily abandoned.
 2nd 24 hours natural _____ (Well has been plugged)
 Date of shot _____ No. of quarts _____ From _____ to _____ From _____ to _____
 Date of acid _____ No. of gallons _____
 1st 24 hours after acid _____ shot
 2nd 24 hours after acid _____ shot

FORMATION AND CASING RECORD

Formation	Top	Bottom	Top Pay	Bottom Pay	Remarks	Casing	
						Size	Set at
Berea	290		300	315	Show oil.	10"	203
Antrim	475					8-1/4"	761
Traverse Lime	669			670	Salt water-500 ft.		
Dundee	998 ?						
Total Depth		1207					

Remarks _____

Signed D. C. Shackelford *J*