



Western Michigan University
ScholarWorks at WMU

Legacy Scout Tickets from Pure Oil Company

8-20-2021

**MGRRE_PureOilScoutTickets_Bauer, Gerald E &
Marie_1_21093118180000**

MGRRE

Western Michigan University

Follow this and additional works at: <https://scholarworks.wmich.edu/pure>



Part of the Geology Commons

WMU ScholarWorks Citation

MGRRE, "MGRRE_PureOilScoutTickets_Bauer, Gerald E & Marie_1_21093118180000" (2021). *Legacy Scout Tickets from Pure Oil Company*. 4706.
<https://scholarworks.wmich.edu/pure/4706>

This Document is brought to you for free and open access via ScholarWorks at WMU. It has been accepted for inclusion in Legacy Scout Tickets from Pure Oil Company by an authorized administrator of ScholarWorks at WMU. See the National Digital Catalogue - Science Base Catalogue for more collections submitted by MGRRE.



MGRRE_PureOilScoutTickets_Bauer, Gerald E & Marie_1_21093118180000

API 21093118180000

Permit Number 11818

Lease Name Bauer, Gerald E & Marie

Well Number 1

County Livingston

Township 02N

Range 05E

Section 25

2021 DEQ or Pure co_name Panhandle Eastern Pipeline Company

Pure Number 70

Latitude 42.54147

Longitude -83.81187

THE PURE OIL COMPANY

LOCATION REPORT

Date September 12, 1945

A.F.E. No. _____

Division Mich. Producing District _____

Lease G. E. & M. Bauer

Acres _____ Lease No. 25 Elevation _____ Well No. 1 (Serial No. 70)

Quadrangle C W 1/2 NW NW Sec. 25 Twp. 2 N Rge. 2 E ~~X Dist~~ Genoa

Survey _____ County Livingston State Michigan

Operator Panhandle Eastern Pipe Line Company Map Genoa Township, Livingston County

660 660 Feet from North Line of Lease

" " East " " "

" " South " " "

" " West " " "

330 330 Feet from North Line of Section

" " East " " "

" " South " " "

330 330 " " West " " "

LEGEND

○ Location

☀ Gas Well

● Oil Well

☀ Gas - Distillate Well

○ or ○ Dry Hole

● Dry Showing Oil

☀ Dry Showing Gas

⊗ Abandoned Location

☀ or ⊗ Abandoned Gas Well

● or ● Abandoned Oil Well

⊗ or ⊗ Input Well

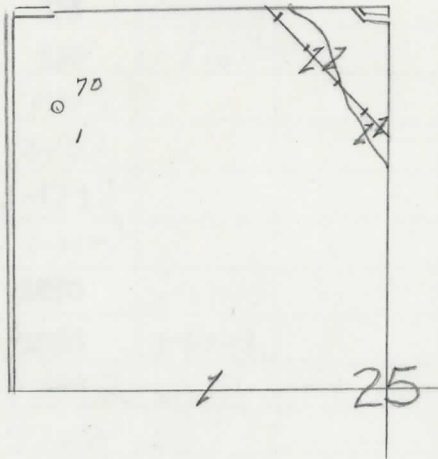

N



Scale _____

Remarks: _____

Submitted by _____ Civil Engineer Approved by _____ Division Manager

Approved by _____ Vice-President - General Manager

COMPLETION RECORD OF WELLS DRILLED BY OTHER OPERATORS

WC

Michigan Producing Division

Date November 28, 1945 No. 70
 State Michigan Co. Livingston Twp. Genea Sec. 25 Twp. 2 N Rge. 5 E
 Well No. 1 Serial No. 70 Farm G.E. & M. Bauer Acres
 Operator Panhandle Eastern Pipe Line Company
 Date started 9-20-45 Date completed 11-23-45 Elevation 967.5

PRODUCTION RECORD

1st 24 hours natural
 Date of shot No. of quarts From To From to
 Date of acid No. of gallons shot
 1st 24 hours after acid
 Completed as: Oil Well Gas Well Dry Hole X

FORMATION AND CASING RECORD

Formation	Top	Bottom	Top Pay	Bottom Pay	Remarks	Casing	
						Size	Set at
Sunbury	223	(+745)				16"	175
Berea	235	355	(+733)		Oil Stain 250.	13"	671
Antrim	440	550	(+528)		(-718)	10"	1228
Traverse Lime	621	(+347)			See remarks below.	8-1/4"	1914
Dundee	954	(+14)			" " "		
Detroit River Dol.	1141	(-173)			" " "		
Det. River Anhyd.	1180	(-212)			" " "		
Sylvania	1507	1870	(-539)		" " "		
Beau Blanc	1870	1950	(-902)		" " "		
Bass Island	1950	(-982)					
Salina Dol.	3580	(-2617)			Oil Odor 3585-3635.	(-2617)	
Niagaran	4037	(-3009)					
Clinton	4170	(-3202)					
Total Depth		4214	(-3246)		(+272)		

(-114) Remarks Traverse: H.F.S.W. 625-630; show salt water 696-702; Dundee: 400 ft. salt water 1082-1100 - rainbow oil 1002-1015; Detroit River Anhyd.: 1 bailer salt water per hour at 1355; Sylvania: show salt water 1507' - 1300 ft. salt water at 1800; Beau Blanc: 1 bailer salt water per hour from 1941 to 1966. (-973) (-932)

Signed D. C. Shackelford