



Western Michigan University  
ScholarWorks at WMU

---

Legacy Scout Tickets from Pure Oil Company

---

8-20-2021

**MGRRE\_PureOilScoutTickets\_Leith Thomas S. and ethel  
M.\_1\_21093127370000**

MGRRE  
*Western Michigan University*

Follow this and additional works at: <https://scholarworks.wmich.edu/pure>



Part of the Geology Commons

---

#### **WMU ScholarWorks Citation**

MGRRE, "MGRRE\_PureOilScoutTickets\_Leith Thomas S. and ethel M.\_1\_21093127370000" (2021).  
*Legacy Scout Tickets from Pure Oil Company*. 4713.  
<https://scholarworks.wmich.edu/pure/4713>

This Document is brought to you for free and open access via ScholarWorks at WMU. It has been accepted for inclusion in Legacy Scout Tickets from Pure Oil Company by an authorized administrator of ScholarWorks at WMU. See the National Digital Catalogue - Science Base Catalogue for more collections submitted by MGRRE.



---

**MGRRE\_PureOilScoutTickets\_Leith Thomas S. and ethel M.\_1\_21093127370000**

API 21093127370000

Permit Number 12737

Lease Name Leith Thomas S. and ethel M.

Well Number 1

County Livingston

Township 02N

Range 06E

Section 32

2021 DEQ or Pure co\_name Leith Thomas S. and Leith, Ethel M.

Pure Number 77

Latitude 42.52735

Longitude -83.75592

# THE PURE OIL COMPANY LOCATION REPORT

Date November 6, 1946 A.F.E. No. Thomas S. Leith & Ethel M. Leith  
 Division Mich. Producing District \_\_\_\_\_ Lease Thos. S. Leith & Ethel M. Leith  
 Acres \_\_\_\_\_ Lease No. \_\_\_\_\_ Elevation \_\_\_\_\_ Well No. 1 (Serial No. 77)  
 Quadrangle SE NW NE Sec. 32 Twp. 2 N Rge. 6 E Brighton  
 Survey \_\_\_\_\_ County Livingston State Michigan  
 Operator Thomas S. Leith & Ethel M. Leith Map Brighton Township, Livingston County

990	990	Feet from North Line of Lease
		" " East " " "
		" " South " " "
990	990	" " West " " "
990	990	Feet from North Line of Section
		" " East " " "
		" " South " " "
990	990	" " West " " "

**LEGEND**

- Gas Well
- Oil Well
- Gas - Distillate Well
- Dry Hole
- Dry Showing Oil
- Location
- Dry Showing Gas
- Abandoned Location
- Abandoned Gas Well
- Abandoned Oil Well
- Input Well

*Low*

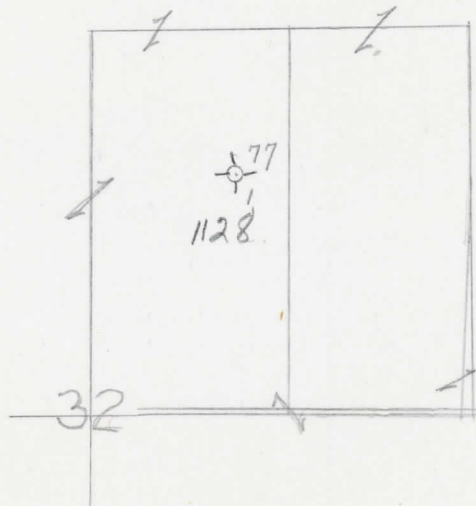

Remarks: \_\_\_\_\_  
 \_\_\_\_\_  
 \_\_\_\_\_

Scale \_\_\_\_\_

Submitted by CB Civil Engineer Approved by \_\_\_\_\_ Division Manager  
 Approved by \_\_\_\_\_ Vice-President - General Manager