



Legacy Scout Tickets from Pure Oil Company

8-20-2021

MGRRE_PureOilScoutTickets_Brayton, L N Comm_1_21093127660000

MGRRE

Western Michigan University

Follow this and additional works at: <https://scholarworks.wmich.edu/pure>



Part of the Geology Commons

WMU ScholarWorks Citation

MGRRE, "MGRRE_PureOilScoutTickets_Brayton, L N Comm_1_21093127660000" (2021). *Legacy Scout Tickets from Pure Oil Company*. 4714.

<https://scholarworks.wmich.edu/pure/4714>

This Document is brought to you for free and open access via ScholarWorks at WMU. It has been accepted for inclusion in Legacy Scout Tickets from Pure Oil Company by an authorized administrator of ScholarWorks at WMU. See the National Digital Catalogue - Science Base Catalogue for more collections submitted by MGRRE.



MGRRE_PureOilScoutTickets_Brayton, L N Comm_1_21093127660000

API 21093127660000

Permit Number 12766

Lease Name Brayton, L N Comm

Well Number 1

County Livingston

Township 02N

Range 04E

Section 1

2021 DEQ or Pure co_name C M S. Pan Gas Storage Company dba Southwest Gas Storage

Pure Number 78

Latitude 42.5928151

Longitude -83.9297367

THE PURE OIL COMPANY

LOCATION REPORT

Date November 19, 1946 A.F.E. No. L. N. Brayton (Comm.)
 Division Mich. Producing District _____ Lease L. N. Brayton (Comm.)
 Acres _____ Lease No. _____ Elevation _____ Well No. 1 (Serial No. 78)
 Quadrangle NE SW NW Sec. 1 Twp. 2 N Rge. 4 E Blk. Dist. Marion
 Survey _____ County Livingston State Michigan
 Operator Panhandle Eastern Pipe Line Co. Map Marion Township, Livingston County

Feet from North Line of Lease	
<u>1090</u>	<u>1090</u>
<u>990</u>	<u>990</u>
“ “ East “ “ “	“ “ South “ “ “
“ “ West “ “ “	
Feet from North Line of Section	
<u>1090</u>	<u>1090</u>
<u>990</u>	<u>990</u>
“ “ East “ “ “	“ “ South “ “ <u>1/4</u>
“ “ West “ “ “	

LEGEND

- Location
- ☀ Gas Well
- Oil Well
- ☀ Gas - Distillate Well
- ∅ or ○ Dry Hole
- Dry Showing Oil
- ☀ Dry Showing Gas
- ⊗ Abandoned Location
- ☀ or ⊗ Abandoned Gas Well
- or ● Abandoned Oil Well
- or ○ Input Well

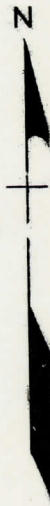
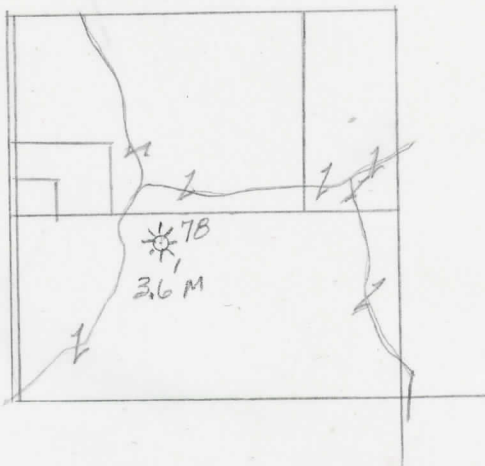

Scale _____

Remarks: _____

Submitted by CB Civil Engineer Approved by _____ Division Manager
 Approved by _____ Vice-President - General Manager