



Western Michigan University
ScholarWorks at WMU

Legacy Scout Tickets from Pure Oil Company

8-20-2021

**MGRRE_PureOilScoutTickets_Denewelt
Brothers_1_21099000069000**

MGRRE
Western Michigan University

Follow this and additional works at: <https://scholarworks.wmich.edu/pure>



Part of the Geology Commons

WMU ScholarWorks Citation

MGRRE, "MGRRE_PureOilScoutTickets_Denewelt Brothers_1_21099000069000" (2021). *Legacy Scout Tickets from Pure Oil Company*. 4718.
<https://scholarworks.wmich.edu/pure/4718>

This Document is brought to you for free and open access via ScholarWorks at WMU. It has been accepted for inclusion in Legacy Scout Tickets from Pure Oil Company by an authorized administrator of ScholarWorks at WMU. See the National Digital Catalogue - Science Base Catalogue for more collections submitted by MGRRE.



MGRRE_PureOilScoutTickets_Denewelt Brothers_1_21099000069000

API 21099000069000

Permit Number 6

Lease Name Denewelt Brothers

Well Number 1

County Macomb

Township 03N

Range 13E

Section 35

2021 DEQ or Pure co_name Spence, F.E.

Pure Number 3

Latitude 42.63684

Longitude -82.886314

THE PURE OIL COMPANY

LOCATION REPORT

No. 3DATE 7-13-34

STATE Michigan COUNTY Macomb DIST. Macomb SEC. 35 TOWN 3N RANGE 13E
 WELL No. _____ (SERIAL No. 3) FARM Donewelt Bros. ACRES _____
 NAME OF STREAM OR WATERS _____ QUADRANGLE SW corner SE-SW

OPERATOR F. E. Spencer (driller) MAP Macomb Township, Macomb County

Feet from North Line of Farm

" " East " " "

" " South " " "

" " West " " "

Feet from North Line of Section

" " East " " "

" " South " " "

" " West " " "

LEGEND

O LOCATION

① RIG

⊗ DRILLING

⊗ GAS WELL

● OIL WELL

⊙ SMALL OIL WELL

⊙ DRY HOLE

⊙ DRY SHOWING OIL

⊙ DRY SHOWING GAS

⊙ ABANDONED LOCATION

⊙ ABANDONED GAS WELL

⊙ ABANDONED OIL WELL

NOTE: Below make tracing from map, (when no map is obtainable make sketch) showing farm, center of section, this location with measurements and also wells, dry holes, or other locations in the vicinity of this location. Make copy to keep for reference and send original to Columbus office.

Elev. 594

(Typed Log)

Drilled by F.E. Spencer.

Pub. 24, Pp. 233

Completed 1913.

Traverse 300'

Dundee 575'

Not to Trenton

T.D. 3182

(Typed log)

Elevation 594'

Pub. #24 - Pp. 233

Completed 1913

Traverse 300'

Dundee 575'

Not to Trenton

Total Depth 3182'

Completed 1913

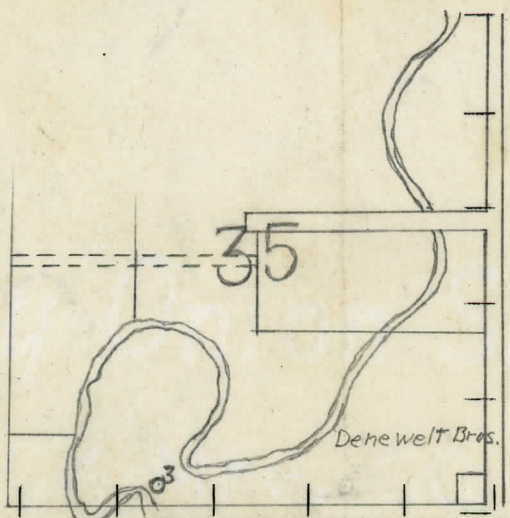

REMARKS:

SIGNED

Superintendent or Foreman.