



Western Michigan University  
ScholarWorks at WMU

---

Legacy Scout Tickets from Pure Oil Company

---

8-20-2021

## MGRRE\_PureOilScoutTickets\_Romeo Village\_unk\_unk

MGRRE

*Western Michigan University*

Follow this and additional works at: <https://scholarworks.wmich.edu/pure>



Part of the Geology Commons

---

### WMU ScholarWorks Citation

MGRRE, "MGRRE\_PureOilScoutTickets\_Romeo Village\_unk\_unk" (2021). *Legacy Scout Tickets from Pure Oil Company*. 4722.

<https://scholarworks.wmich.edu/pure/4722>

This Document is brought to you for free and open access via ScholarWorks at WMU. It has been accepted for inclusion in Legacy Scout Tickets from Pure Oil Company by an authorized administrator of ScholarWorks at WMU. See the National Digital Catalogue - Science Base Catalogue for more collections submitted by MGRRE.



---

## MGRRE\_PureOilScoutTickets\_Romeo Village\_unk\_unk

API unk

Permit Number unk

Lease Name Romeo Village

Well Number unk

County Macomb

Township 04N

Range 12E

Section 2

2021 DEQ or Pure co\_name Nat Porter, contractor

Pure Number 7

Latitude 42.7947192

Longitude -83.0091022

THE PURE OIL COMPANY

## LOCATION REPORT

No. 7DATE 7-14-34

STATE Michigan COUNTY Macomb DIST. Washington SEC. 2 TOWN 4N RANGE 12E  
 WELL No. \_\_\_\_\_ (SERIAL No. 7) FARM \_\_\_\_\_ PREC. Romeo Village ACRES \_\_\_\_\_

NAME OF STREAM OR WATERS \_\_\_\_\_ QUADRANGLE SW-NW-NW SW-NW-NWOPERATOR Nat Porter Contractor MAP Washington Township, Macomb County

\_\_\_\_\_ Feet from North Line of Farm

\_\_\_\_\_ " " East " " "

\_\_\_\_\_ " " South " " "

\_\_\_\_\_ " " West " " "

800 800' Feet from North Line of Section

\_\_\_\_\_ " " East " " "

\_\_\_\_\_ " " South " " "

200 200 " " West " " "**LEGEND**

O LOCATION

① RIG

⊕ DRILLING

⊗ GAS WELL

● OIL WELL

⊙ SMALL OIL WELL

⊕ DRY HOLE

⊕ DRY SHOWING OIL

⊕ DRY SHOWING GAS

⊗ ABANDONED LOCATION

⊗ ABANDONED GAS WELL

⊗ ABANDONED OIL WELL

NOTE: Below make tracing from map, (when no map is obtainable make sketch) showing farm, center of section, this location with measurements and also wells, dry holes, or other locations in the vicinity of this location. Make copy to keep for reference and send original to Columbus office.

Pub. 14 Pp. 116  
 Nat Porter Contr.  
 Berea 750'  
 Dundee 1050'-1300'  
 Monroe 1300'? (Shell)  
 T.D. 1576.  
 Elev 827'  
 Pub. #14 - Pp. 116  
 Berea 750'  
 Dundee 1050-1300'  
 Monroe 1300'  
 Total Depth 1576'

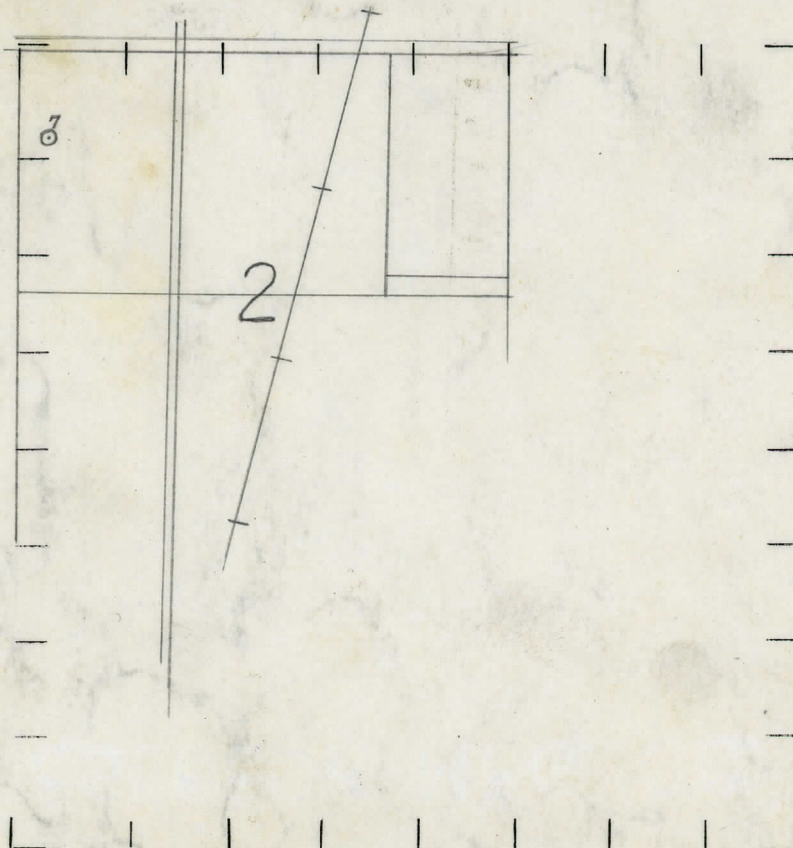

REMARKS:

SIGNED

*R. L. Meager*  
 Superintendent or Foreman.