



Western Michigan University  
ScholarWorks at WMU

---

Legacy Scout Tickets from Pure Oil Company

---

8-20-2021

**MGRRE\_PureOilScoutTickets\_Coulon\_2\_21099003410000**

MGRRE

*Western Michigan University*

Follow this and additional works at: <https://scholarworks.wmich.edu/pure>



Part of the Geology Commons

---

#### WMU ScholarWorks Citation

MGRRE, "MGRRE\_PureOilScoutTickets\_Coulon\_2\_21099003410000" (2021). *Legacy Scout Tickets from Pure Oil Company*. 4727.

<https://scholarworks.wmich.edu/pure/4727>

This Document is brought to you for free and open access via ScholarWorks at WMU. It has been accepted for inclusion in Legacy Scout Tickets from Pure Oil Company by an authorized administrator of ScholarWorks at WMU. See the National Digital Catalogue - Science Base Catalogue for more collections submitted by MGRRE.



---

## MGRRE\_PureOilScoutTickets\_Coulon\_2\_21099003410000

API 21099003410000

Permit Number 341

Lease Name Coulon

Well Number 2

County Macomb

Township 02N

Range 13E

Section 4

2021 DEQ or Pure co\_name St. Clair Oil and Gas Corporation

Pure Number 13

Latitude 42.61843

Longitude -82.93044

THE PURE OIL COMPANY

## LOCATION REPORT

No. 13

DATE Dec 15th 1928

STATE Michigan COUNTY Macomb DIST TWP. Clinton SEC. 4 TOWN 2N RANGE 13E  
 WELL No. 2 (SERIAL No. 13) FARM Otto Coulton ACRES

NAME OF STREAM OR WATERS \_\_\_\_\_ QUADRANGLE \_\_\_\_\_  
 OPERATOR St. Clair Oil Co MAP 4" = 1 mile

Feet from North Line of Farm

" " East " " "

" " South " " "

" " West " " "

Feet from North Line of Section

" " East " " "

" " South " " "

" " West " " "

1720

450

LEGEND

O LOCATION

① RIG

⊕ DRILLING

⊙ GAS WELL

● OIL WELL

⦿ SMALL OIL WELL

⦿ DRY HOLE

⦿ DRY SHOWING OIL

⦿ DRY SHOWING GAS

⦿ ABANDONED LOCATION

⦿ ABANDONED GAS WELL

⦿ ABANDONED OIL WELL

NOTE: Below make tracing from map (when no map is obtainable make sketch), showing farm, center of section, this location with measurements and also wells, dry holes, or other locations in the vicinity of this location. Make copy to keep for reference and send original to Columbus office.

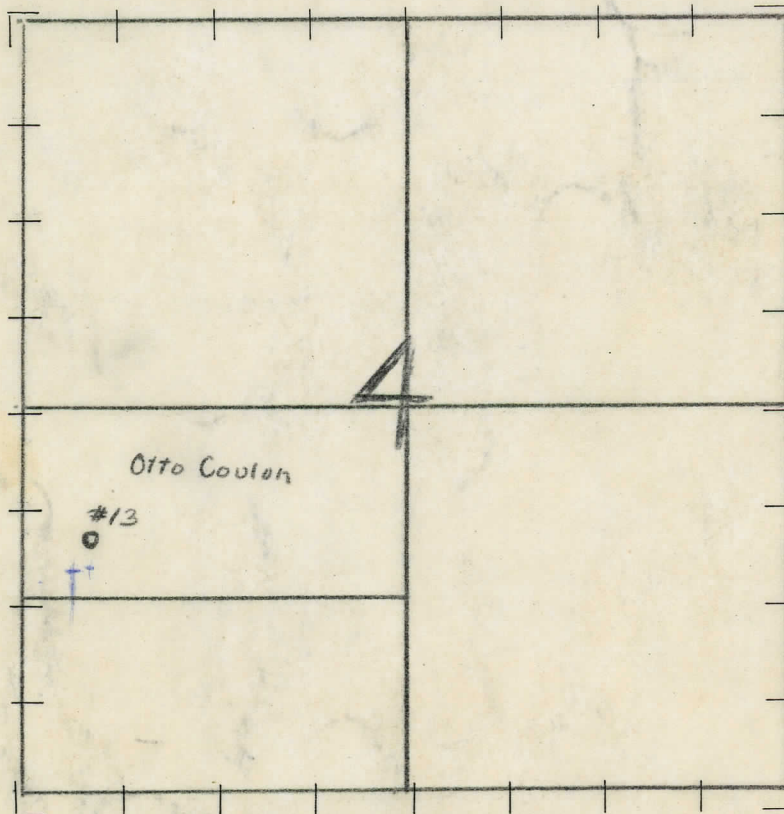

REMARKS:

SIGNED

Superintendent or Foreman.

