



Western Michigan University
ScholarWorks at WMU

Legacy Scout Tickets from Pure Oil Company

8-20-2021

MGRRE_PureOilScoutTickets_Harrison SchoolDistrict #3_3_unk

MGRRE

Western Michigan University

Follow this and additional works at: <https://scholarworks.wmich.edu/pure>



Part of the Geology Commons

WMU ScholarWorks Citation

MGRRE, "MGRRE_PureOilScoutTickets_Harrison SchoolDistrict #3_3_unk" (2021). *Legacy Scout Tickets from Pure Oil Company*. 4733.

<https://scholarworks.wmich.edu/pure/4733>

This Document is brought to you for free and open access via ScholarWorks at WMU. It has been accepted for inclusion in Legacy Scout Tickets from Pure Oil Company by an authorized administrator of ScholarWorks at WMU. See the National Digital Catalogue - Science Base Catalogue for more collections submitted by MGRRE.



MGRRE_PureOilScoutTickets_Harrison SchoolDistrict #3_3_unk

API unk

Permit Number unk

Lease Name Harrison SchoolDistrict #3

Well Number 3

County Macomb

Township 02N

Range 14E

Section unk

2021 DEQ or Pure co_name Chapman

Pure Number 19

Latitude 42.6269641

Longitude -82.8509057

7-20-34

THE PURE OIL COMPANY

LOCATION REPORT

No. 19

DATE 7-10-34

STATE Michigan COUNTY Macomb DIST. Harrison TWP. Harrison SEC. P.C. 616 TOWN 2N RANGE 14E WELL No. (SERIAL No. 19) FARM Harrison School District #3 ACRES

NAME OF STREAM OR WATERS QUADRANGLE

OPERATOR MAP Harrison Township, Macomb County Harrison Twp. - Macomb Co.

Feet from North Line of Farm East South West

Feet from North Line of Section East South West

Near North of South River Drive Road

LEGEND

- O LOCATION
DRY HOLE
RIG
DRY SHOWING OIL
DRILLING
DRY SHOWING GAS
GAS WELL
ABANDONED LOCATION
OIL WELL
ABANDONED GAS WELL
SMALL OIL WELL
ABANDONED OIL WELL

NOTE: Below make tracing from map, (when no map is obtainable make sketch) showing farm, center of section, this location with measurements and also wells, dry holes, or other locations in the vicinity of this location. Make copy to keep for reference and send original to Columbus office.

Elev. 582
Log R.B. Newcombe
Drilled by F Chapman
Year 1928
Pleistocene drift 86'
Show gas in Antrim 263'
Elevation 582'
Log by R.B. Newcombe
Drilled by Chapman - 1918
Pleistocene Drift 86'
Show Gas in Antrim 263'

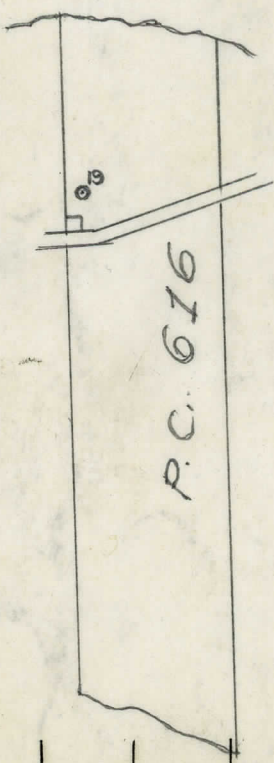

REMARKS:

SIGNED

Handwritten signature of R. A. J. J. J.

Superintendent or Foreman.