



Western Michigan University
ScholarWorks at WMU

Legacy Scout Tickets from Pure Oil Company

8-20-2021

**MGRRE_PureOilScoutTickets_Kraft, Chas. and Maas, Louis
(comm.)_1_21099088130000**

MGRRE
Western Michigan University

Follow this and additional works at: <https://scholarworks.wmich.edu/pure>



Part of the Geology Commons

WMU ScholarWorks Citation

MGRRE, "MGRRE_PureOilScoutTickets_Kraft, Chas. and Maas, Louis (comm.)_1_21099088130000" (2021). *Legacy Scout Tickets from Pure Oil Company*. 4743.
<https://scholarworks.wmich.edu/pure/4743>

This Document is brought to you for free and open access via ScholarWorks at WMU. It has been accepted for inclusion in Legacy Scout Tickets from Pure Oil Company by an authorized administrator of ScholarWorks at WMU. See the National Digital Catalogue - Science Base Catalogue for more collections submitted by MGRRE.



**MGRRE_PureOilScoutTickets_Kraft, Chas. and Maas, Louis
(comm.)_1_21099088130000**

API 21099088130000

Permit Number 8813

Lease Name Kraft, Chas. and Maas, Louis (comm.)

Well Number 1

County Macomb

Township 02N

Range 12E

Section 27

2021 DEQ or Pure co_name Devonian Testing and Leasing Company

Pure Number 29

Latitude 42.56525

Longitude -83.01986

THE PURE OIL COMPANY

LOCATION REPORT

No. 239

DATE August 20, 1941

STATE Michigan COUNTY Macomb

TWP. Sterling

SEC. 27

TOWN 2nd NRANGE 12th E

WELL No. 1/ (SERIAL No. 29) FARM

PRECE Chas. W. Kraft & Louis Maas (Comm.)

ACRES

NAME OF STREAM OR WATERS

QUADRANGLE NE NE NW

OPERATOR Devonian Testing and Leasing Co.

Map

Sterling Township, Macomb County

328 328 Feet from North Line of Farm

Sterling - Macomb

" " East " " "

" " South " " "

663 663 " " West " " "

330 330 Feet from North Line of Section

3 3 " " East " " "

" " South " " "

" " West " " "

LEGEND

○ LOCATION

⊕ RIG

⊕ DRILLING

☼ GAS WELL

● OIL WELL

● SMALL OIL WELL

⊙ DRY HOLE

⊙ DRY SHOWING OIL

⊙ DRY SHOWING GAS

⊙ ABANDONED LOCATION

⊙ ABANDONED GAS WELL

⊙ ABANDONED OIL WELL

NOTE: Below make tracing from map, (when no map is obtainable make sketch) showing farm, center of section, this location with measurements and also wells, dry holes, or other locations in the vicinity of this location.

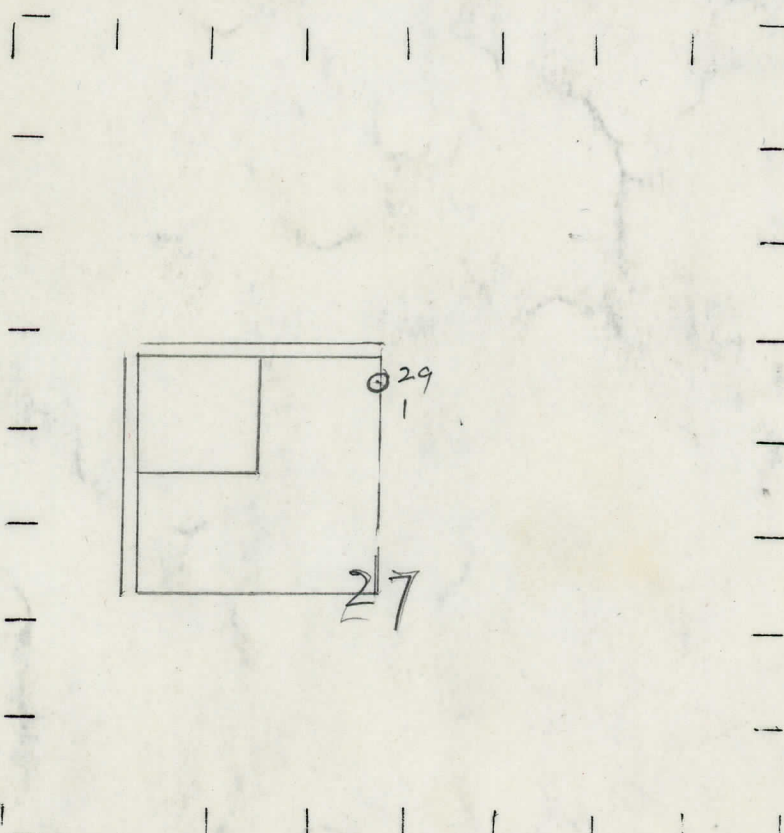

REMARKS: Correcting location.

SIGNED

Superintendent or Foreman

NAME OF STREAM OR WATERS

QUADRANGLE

NE NE NW

WELL No. 1 (SERIAL No. 29) FARM

Chas. W. Kraft & Louis Maas (Comm.) (Comm.)

ACRES

NAME OF STREAM OR WATERS

QUADRANGLE

NW NW NE

OPERATOR Devonian Testing and Leasing Company

Map

Sterling Township, Macomb County

330 320 Feet from North Line of Farm

320 320 " " East " " "

" " South " " "

" " West " " "

330 320 Feet from North Line of Section

" " East " " "

" " South " " "

10 10 " " West " " "

LEGEND

○ LOCATION

⊙ RIG

⊕ DRILLING

☼ GAS WELL

● OIL WELL

● SMALL OIL WELL

⊙ DRY HOLE

● DRY SHOWING OIL

☼ DRY SHOWING GAS

⊙ ABANDONED LOCATION

☼ ABANDONED GAS WELL

● ABANDONED OIL WELL

NOTE: Below make tracing from map, (when no map is obtainable make sketch) showing farm, center of section, this location with measurements and also wells, dry holes, or other locations in the vicinity of this location.

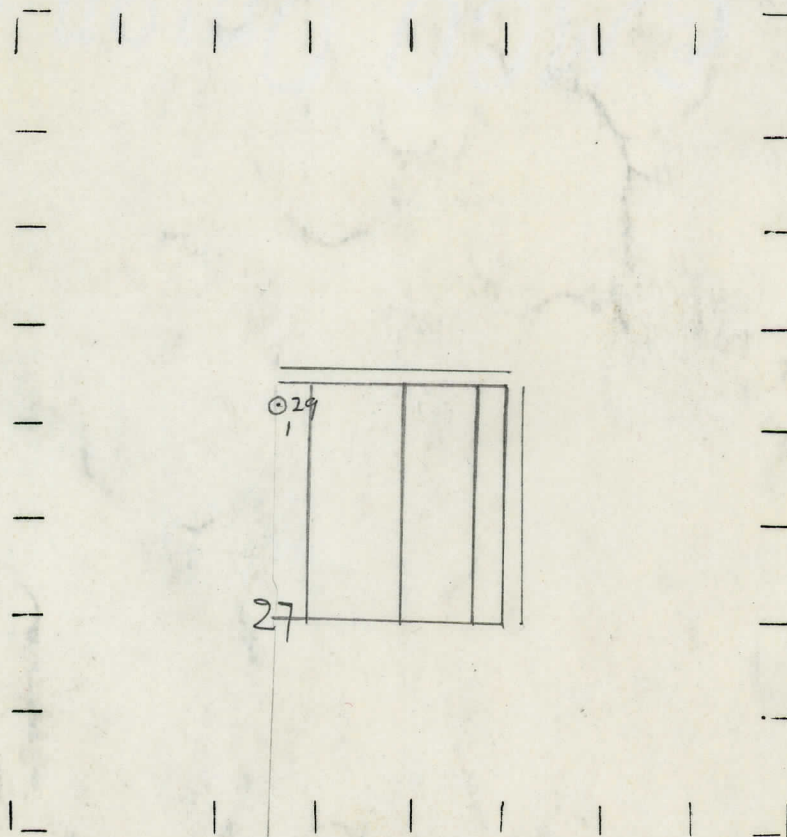

REMARKS:

SIGNED

W

Superintendent or Foreman.

Signed D. C. Shackelford