



Western Michigan University
ScholarWorks at WMU

Legacy Scout Tickets from Pure Oil Company

8-20-2021

MGRRE_PureOilScoutTickets_Starks, Scheibe & Starks_1_21107082720000

MGRRE
Western Michigan University

Follow this and additional works at: <https://scholarworks.wmich.edu/pure>



Part of the Geology Commons

WMU ScholarWorks Citation

MGRRE, "MGRRE_PureOilScoutTickets_Starks, Scheibe & Starks_1_21107082720000" (2021). *Legacy Scout Tickets from Pure Oil Company*. 4981.
<https://scholarworks.wmich.edu/pure/4981>

This Document is brought to you for free and open access via ScholarWorks at WMU. It has been accepted for inclusion in Legacy Scout Tickets from Pure Oil Company by an authorized administrator of ScholarWorks at WMU. See the National Digital Catalogue - Science Base Catalogue for more collections submitted by MGRRE.



MGRRE_PureOilScoutTickets_Starks, Scheibe & Starks_1_21107082720000

API 21107082720000

Permit Number 8272

Lease Name Starks, Scheibe & Starks

Well Number 1

County Mecosta

Township 15N

Range 07W

Section 13

2021 DEQ or Pure co_name Starks, Robert L. Sr.

Pure Number 218

Latitude 43.68714

Longitude -85.10326

DATE May 21, 1941

Corrected

LOCATION REPORT

No. 218STATE Michigan COUNTY Mecosta ~~DIST~~ TWP Sheridan SEC. 13 TOWN 15 N RANGE 7 WWELL No. 1 (SERIAL No. 218) FARM Starks, Scheibe, and Starks ACRESNAME OF STREAM OR WATERS QUADRANGLE SE NW SWOPERATOR Gould and Cross Map Sheridan Township, Mecosta County

Feet from North Line of Farm

" " East " " "

" " South " " "

" " West " " "

Feet from North Line of Section

" " East " " "

" " South " " "

" " West " " "

LEGEND

○ LOCATION

① RIG

⊕ DRILLING

☼ GAS WELL

● OIL WELL

● SMALL OIL WELL

⊙ DRY HOLE

⊙ DRY SHOWING OIL

⊙ DRY SHOWING GAS

⊙ ABANDONED LOCATION

⊙ ABANDONED GAS WELL

⊙ ABANDONED OIL WELL

NOTE: Below make tracing from map. (when no map is obtainable make sketch) showing farm, center of section, this location with measurements and also wells, dry holes, or other locations in the vicinity of this location.

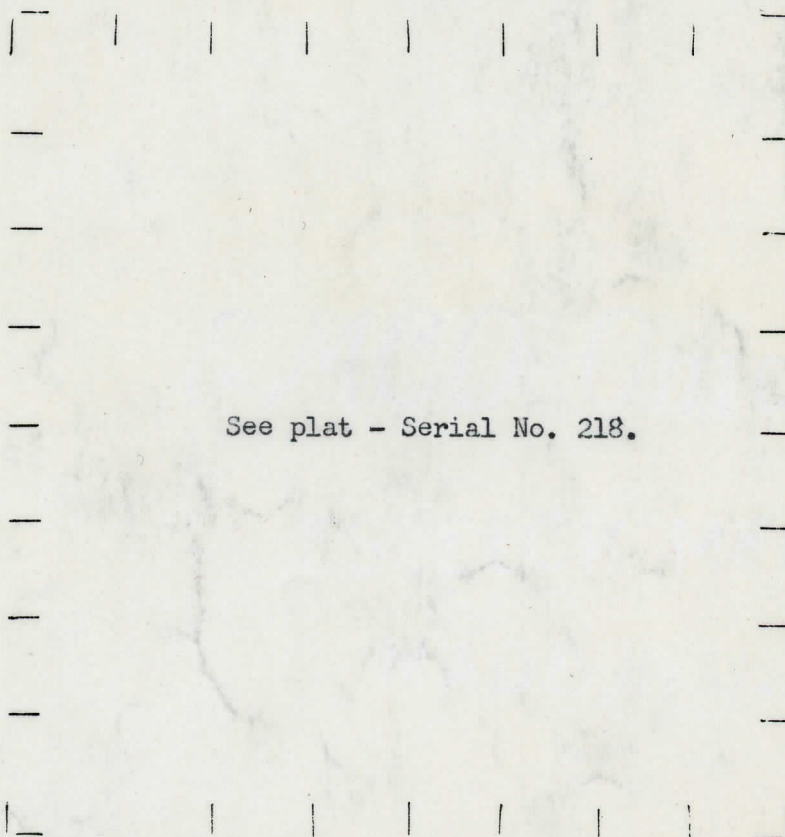
REMARKS: Change of operator.

SIGNED

Superintendent or Foreman.

WELL NO. 1 (SERIAL NO. 218) FARM

Starks, Scheibe, and Starks

ACRES

STATE Michigan

COUNTY Mecosta

TWP. Sheridan

SEC. 17

TOWN 17

RANGE 17

WELL No. 1 (SERIAL No. 218) FARM

Starks, Scheibe, and Starks

ACRES

NAME OF STREAM OR WATERS

QUADRANGLE

SE NW SW - SW

OPERATOR Red-Man Oil Company

Map Sheridan Township, Mecosta County

990 990 Feet from North Line of Farm

Sheridan - Mecosta

" " East " " "

" " South " " "

990 990 " " West " " "

990 990 Feet from North Line of Section $\frac{1}{4}$ 1/4

" " East " " "

" " South " " "

990 990 " " West " " "

LEGEND

O LOCATION

① RIG

⊕ DRILLING

☼ GAS WELL

● OIL WELL

● SMALL OIL WELL

⊙ DRY HOLE

● DRY SHOWING OIL

⊙ DRY SHOWING GAS

⊙ ABANDONED LOCATION

☼ ABANDONED GAS WELL

● ABANDONED OIL WELL

NOTE: Below make tracing from map. (when no map is obtainable make sketch) showing farm, center of section, this location with measurements and also wells, dry holes, or other locations in the vicinity of this location.

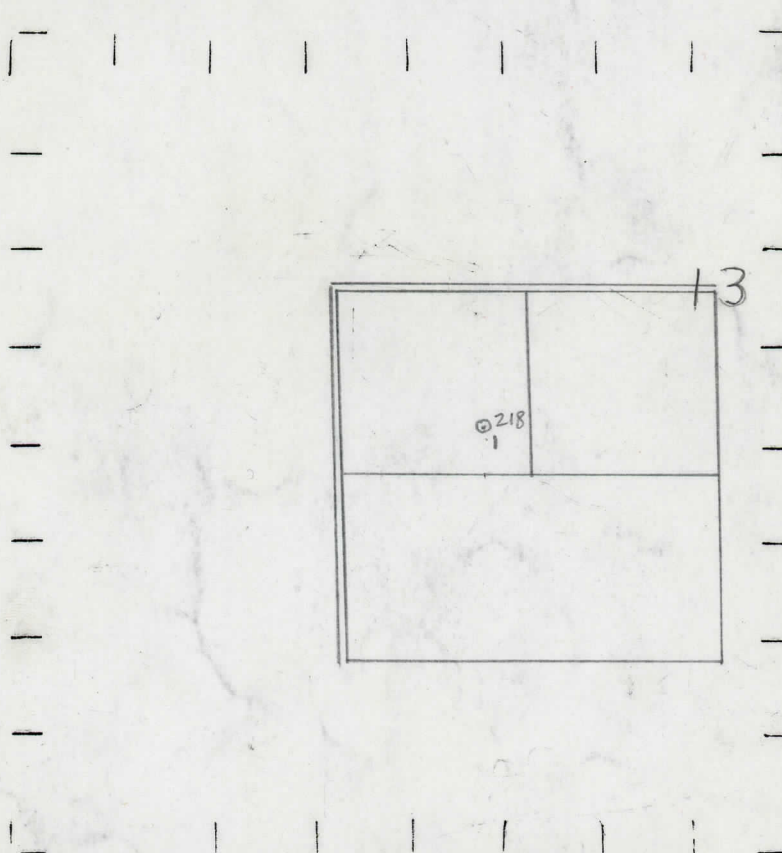

REMARKS: Correcting location. Correcting location.

SIGNED

Superintendent or Foreman.

DEPT NO. 1 (SERIAL NO. 218) LVMH
STATE Michigan COUNTY Mecosta TWP. Sheridan SEC. 13 TOWN 15 N RANGE 74 W
WELL No. 1 (SERIAL No. 218) FARM Starks, Scheibe, and Starks ACRES

NAME OF STREAM OR WATERS QUADRANGLE 6 SW
OPERATOR Red-Man Oil Company Map Sheridan Township, Mecosta County
Red-Man Oil Co. Sheridan - Mecosta

Feet from North Line of Farm
" " East " " "
1320/320 " " South " " "
1320/320 " " West " " "
Feet from North Line of Section
" " East " " "
1320/320 " " South " 1/4 "
1320/320 " " West " " "

- LEGEND
- LOCATION
 - ⊕ RIG
 - ⊕ DRILLING
 - ☼ GAS WELL
 - OIL WELL
 - SMALL OIL WELL
 - ⊕ DRY HOLE
 - DRY SHOWING OIL
 - ☼ DRY SHOWING GAS
 - ⊕ ABANDONED LOCATION
 - ☼ ABANDONED GAS WELL
 - ABANDONED OIL WELL

NOTE: Below make tracing from map. (when no map is obtainable make sketch) showing farm, center of section, this location with measurements and also wells, dry holes, or other locations in the vicinity of this location.

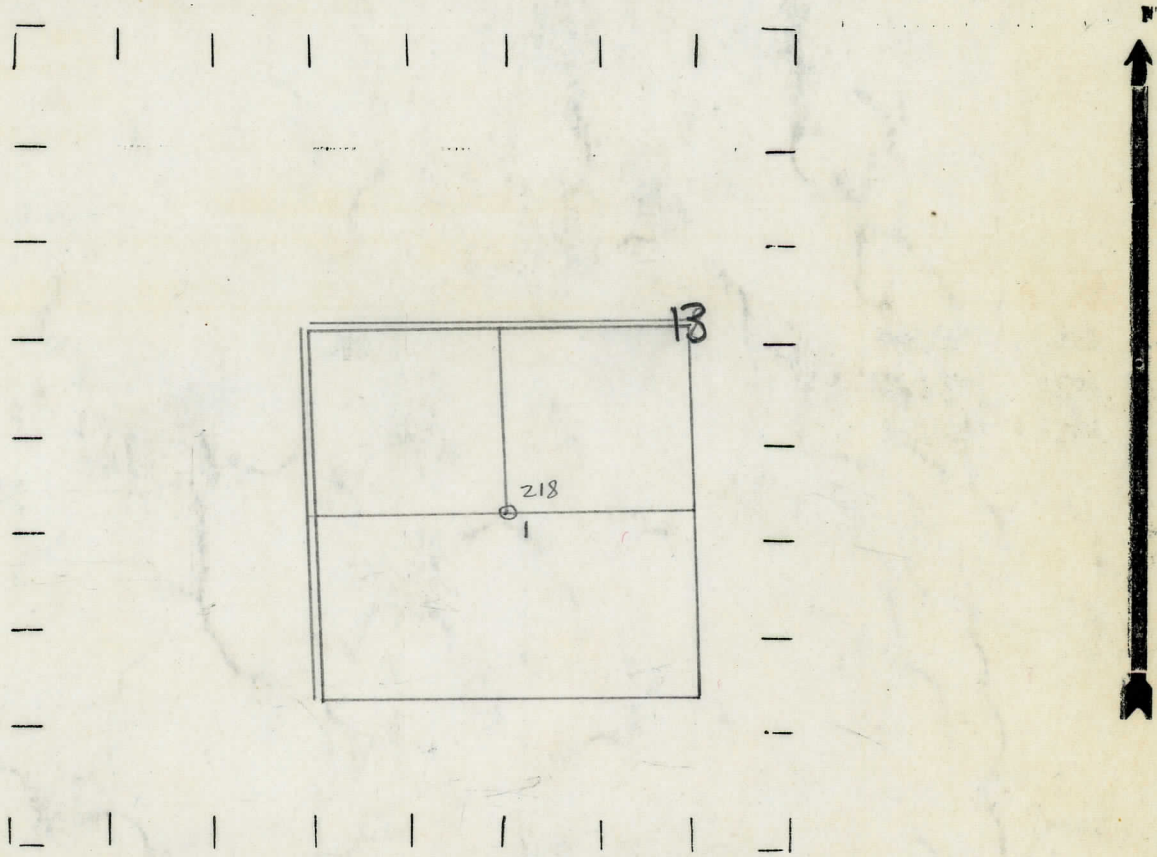

REMARKS:

SIGNED

W
Superintendent or Foreman.

D. C. Shackelford