



Western Michigan University
ScholarWorks at WMU

Legacy Scout Tickets from Pure Oil Company

8-20-2021

MGRRE_PureOilScoutTickets_Dow Marshall Brine - Jasper Group_35_None

MGRRE

Western Michigan University

Follow this and additional works at: <https://scholarworks.wmich.edu/pure>



Part of the Geology Commons

WMU ScholarWorks Citation

MGRRE, "MGRRE_PureOilScoutTickets_Dow Marshall Brine - Jasper Group_35_None" (2021). *Legacy Scout Tickets from Pure Oil Company*. 5137.
<https://scholarworks.wmich.edu/pure/5137>

This Document is brought to you for free and open access via ScholarWorks at WMU. It has been accepted for inclusion in Legacy Scout Tickets from Pure Oil Company by an authorized administrator of ScholarWorks at WMU. See the National Digital Catalogue - Science Base Catalogue for more collections submitted by MGRRE.



MGRRE_PureOilScoutTickets_Dow Marshall Brine - Jasper Group_35_None

API None

Permit Number None

Lease Name Dow Marshall Brine - Jasper Group

Well Number 35

County Midland

Township 13N

Range 01W

Section 19

2021 DEQ or Pure co_name Dow Chemical Company

Pure Number 24

Latitude 43.502593

Longitude -84.4789746

DATE Nov. 22nd, 1929

THE PURE OIL COMPANY
LOCATION REPORT

No. 24

STATE Michigan COUNTY Midland DIST. Porter TWP. Porter SEC. 19 TOWN 13 N RANGE 1 W

WELL No. 35 (SERIAL No. 24) FARM Dow Chemical Company, Jasper Group ACRES

NAME OF STREAM OR WATERS _____ QUADRANGLE SW $\frac{1}{4}$ - NW $\frac{1}{4}$

OPERATOR Dow Chemical Company MAP Porter Township, Midland County

_____ Feet from North Line of Farm
_____ " " East " " "
_____ " " South " " "
_____ " " West " " "
_____ 1875 Feet from North Line of Section
_____ " " East " " "
_____ " " South " " "
_____ 100 " " West " " "

LEGEND

- LOCATION
- ⊙ RIG
- ⊕ DRILLING
- ⊗ GAS WELL
- OIL WELL
- ⊖ SMALL OIL WELL
- ◇ DRY HOLE
- ◆ DRY SHOWING OIL
- ⊗ DRY SHOWING GAS
- ⊖ ABANDONED LOCATION
- ⊗ ABANDONED GAS WELL
- ⊖ ABANDONED OIL WELL

NOTE: Below make tracing from map, (when no map is obtainable make sketch) showing farm, center of section, this location with measurements and also wells, dry holes, or other locations in the vicinity of this location. Make copy to keep for reference and send original to Columbus office.

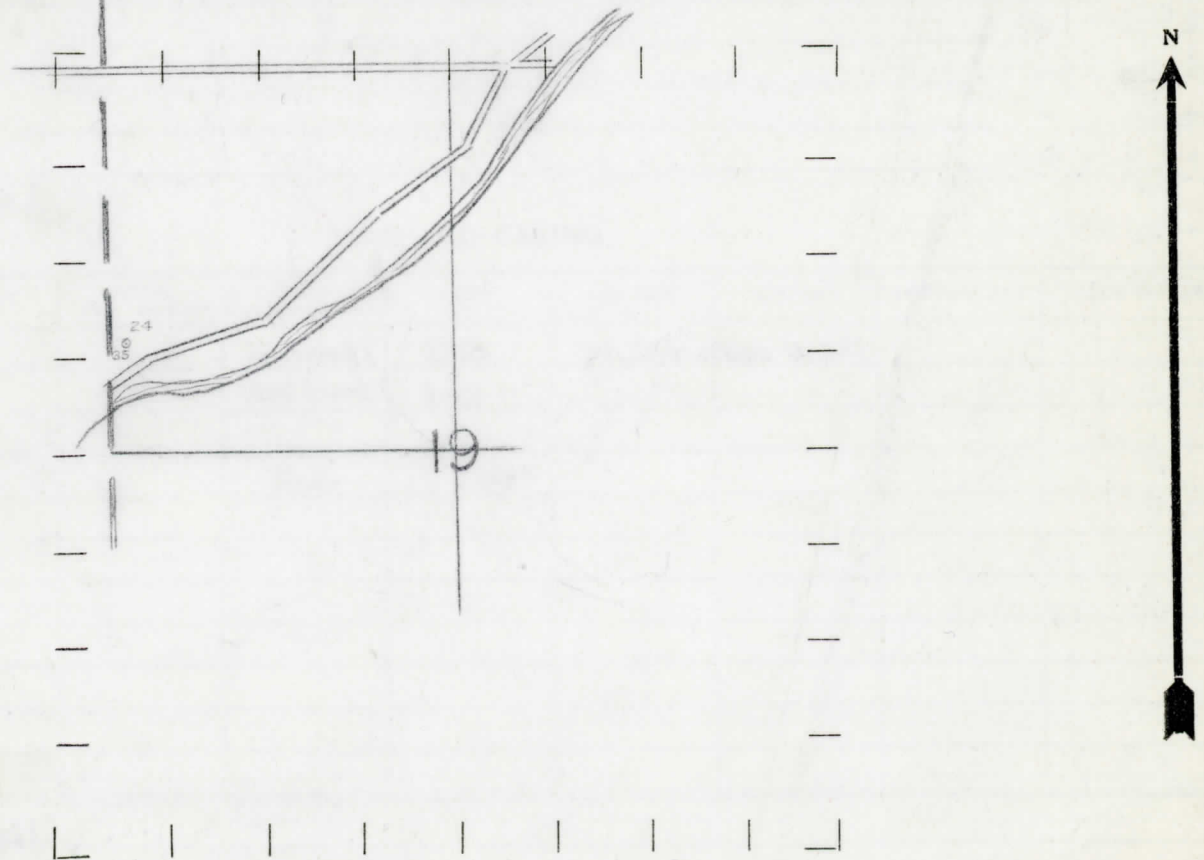

REMARKS: Dow Chemical Company owns 1 acre tract in fee.

SIGNED _____

Superintendent or Foreman.

MICHIGAN PRODUCING DIVISION
COMPLETION RECORD No. -24-

DATE Dec. 14th, 1929.
 STATE Michigan COUNTY Midland DIST. TWP. Porter SEC. 19 TOWN 13 N RANGE 1 W
 WELL No. 35 (SERIAL No. 24) FARM Dow Chemical Company, Jasper Group ACRES _____
 NAME OF STREAM OR WATERS _____ QUADRANGLE _____
 OPERATOR Dow Chemical Company MAP Porter Township, Midland Co.
 LOCATION REPORT SENT IN (DATE) Nov. 23rd, 1929.

WELL STARTED (DATE) Unknown WELL COMPLETED (DATE) Dec. 14th, 1929.

OIL WELL
 GAS WELL
 DRY HOLE
 ABANDONED WELL

CROSS OUT THREE OF THE ABOVE
 WELL RECORD

| DATE OF SHOT | NUMBER OF QUARTS | BARRELS OR FEET |
|-------------------------|------------------|-----------------|
| 1st 24 HOURS PRODUCTION | | |
| 2nd " " " | | |
| 3rd " " " | | |
| 4th " " " | | |
| 5th " " " | | |

SAND AND CASING

| CASING SIZE | WEIGHT | CASING Feet Inches | SAND Name and Nature | TOP | BOTTOM | TOP PAY | BOTTOM PAY | SALT WATER |
|-------------|--------|--------------------|----------------------|-------|--------------------|---------|------------|------------|
| | | | Marshall | 1160 | (T.Limestone 993') | | | |
| | | | Red rock | 1257 | | | | |
| | | | T.D. | 1279' | | | | |
| | | | | | | | | |
| | | | | | | | | |
| | | | | | | | | |
| | | | | | | | | |
| | | | | | | | | |

REMARKS Brine well.