



Western Michigan University  
ScholarWorks at WMU

---

Legacy Scout Tickets from Pure Oil Company

---

8-20-2021

**MGRRE\_PureOilScoutTickets\_Harrison, D. E.\_2\_21111005210000**

MGRRE

*Western Michigan University*

Follow this and additional works at: <https://scholarworks.wmich.edu/pure>



Part of the Geology Commons

---

#### **WMU ScholarWorks Citation**

MGRRE, "MGRRE\_PureOilScoutTickets\_Harrison, D. E.\_2\_21111005210000" (2021). *Legacy Scout Tickets from Pure Oil Company*. 5154.

<https://scholarworks.wmich.edu/pure/5154>

This Document is brought to you for free and open access via ScholarWorks at WMU. It has been accepted for inclusion in Legacy Scout Tickets from Pure Oil Company by an authorized administrator of ScholarWorks at WMU. See the National Digital Catalogue - Science Base Catalogue for more collections submitted by MGRRE.



---

**MGRRE\_PureOilScoutTickets\_Harrison, D. E.\_2\_21111005210000**

API 21111005210000

Permit Number 521

Lease Name Harrison, D. E.

Well Number 2

County Midland

Township 14N

Range 02W

Section 18

2021 DEQ or Pure co\_name Union Oil Company of California

Pure Number 44

Latitude 43.60154

Longitude -84.59908

THE PURE OIL COMPANY  
LOCATION REPORT

No. 44

DATE *Mar 29<sup>th</sup> 1929*

STATE *Michigan* COUNTY *Midland* DIST. *Greendale* SEC. *18* TOWN *14N* RANGE *21W*  
TWP. *Greendale* PREC. *D.E. Harrison*

WELL No. *2* (SERIAL No. *44*) FARM *D.E. Harrison* ACRES

NAME OF STREAM OR WATERS QUADRANGLE *NE 1/4 S11 1/4*

OPERATOR *Pure Oil Co.* MAP *4" = 1 Mile - Greendale*

*1020* Feet from North Line of Farm

*300* " " East " " "

" " South " " "

" " West " " "

Feet from North Line of Section

" " East " " "

*1620* " " South " " "

*2340* " " West " " "

LEGEND

- |                  |                      |
|------------------|----------------------|
| ○ LOCATION       | ⊗ DRY HOLE           |
| ⊕ RIG            | ⊕ DRY SHOWING OIL    |
| ⊕ DRILLING       | ⊕ DRY SHOWING GAS    |
| ⊕ GAS WELL       | ⊕ ABANDONED LOCATION |
| ● OIL WELL       | ⊕ ABANDONED GAS WELL |
| ⊕ SMALL OIL WELL | ⊕ ABANDONED OIL WELL |

NOTE: Below make tracing from map, (when no map is obtainable make sketch) showing farm, center of section, this location with measurements and also wells, dry holes, or other locations in the vicinity of this location. Make copy to keep for reference and send original to Columbus office.

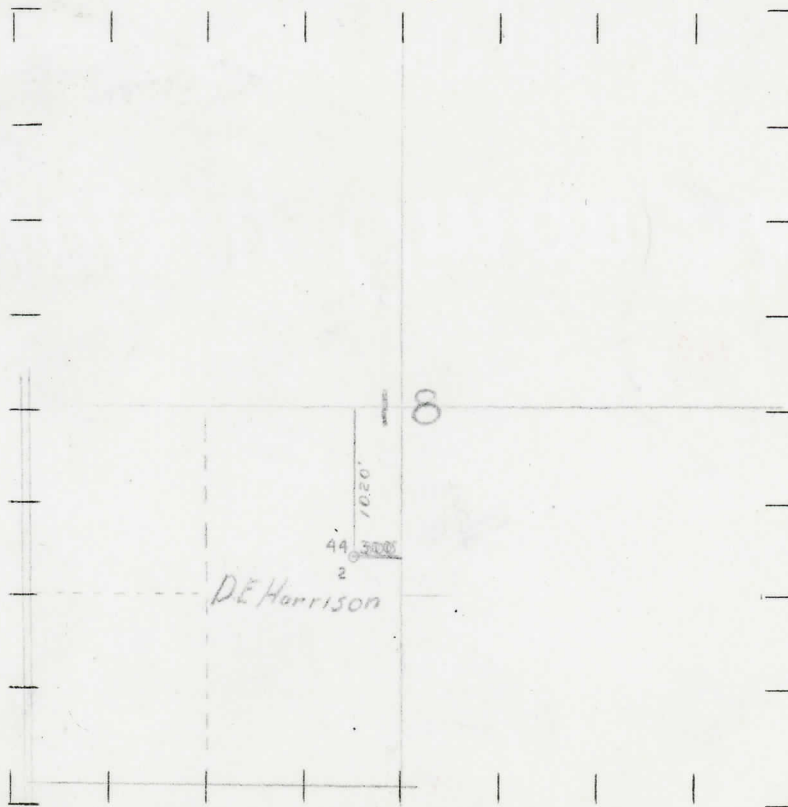

REMARKS:

*This location falls in Swamp Under 1 1/2<sup>ft</sup> of Water  
Sandy Bottom, Dense Brush - Temporary Road 100<sup>ft</sup> West*

SIGNED

Superintendent or Foreman.

*Haston*