



Western Michigan University  
ScholarWorks at WMU

---

Legacy Scout Tickets from Pure Oil Company

---

8-20-2021

## MGRRE\_PureOilScoutTickets\_Carpenter Heirs (Kneeland)\_3\_21111008470000

MGRRE  
*Western Michigan University*

Follow this and additional works at: <https://scholarworks.wmich.edu/pure>



Part of the Geology Commons

---

### WMU ScholarWorks Citation

MGRRE, "MGRRE\_PureOilScoutTickets\_Carpenter Heirs (Kneeland)\_3\_21111008470000" (2021). *Legacy Scout Tickets from Pure Oil Company*. 5167.  
<https://scholarworks.wmich.edu/pure/5167>

This Document is brought to you for free and open access via ScholarWorks at WMU. It has been accepted for inclusion in Legacy Scout Tickets from Pure Oil Company by an authorized administrator of ScholarWorks at WMU. See the National Digital Catalogue - Science Base Catalogue for more collections submitted by MGRRE.



---

**MGRRE\_PureOilScoutTickets\_Carpenter Heirs (Kneeland)\_3\_21111008470000**

API 21111008470000

Permit Number 847

Lease Name Carpenter Heirs (Kneeland)

Well Number 3

County Midland

Township 14N

Range 02W

Section 7

2021 DEQ or Pure co\_name Roosevelt Oil Company

Pure Number 70

Latitude 43.61256

Longitude -84.60419

THE PURE OIL COMPANY  
LOCATION REPORT

DATE February 1, 1939  
DATE Nov. 6, 1929

No. 770

STATE Michigan COUNTY Midland DIST. Greendale SEC. 7 TOWN 14 N RANGE 2 W  
WELL No. 3 (SERIAL No. 70) FARM (Carpenter Hrs.) Kneeland ACRES 36.54-SW-SW  
NAME OF STREAM OR WATERS \_\_\_\_\_ QUADRANGLE SE SW SW  
OPERATOR Sias Oil Company Map Greendale Township, Midland County  
OPERATOR Sias Oil Co MAP Greendale - Mid.

Feet from North Line of Farm  
" " East " " "  
" " South " " "  
" " West " " "  
Feet from North Line of Section  
" " East " " "  
" " South " " "  
" " West " " "

LEGEND

- |                  |                      |
|------------------|----------------------|
| ○ LOCATION       | ⊙ DRY HOLE           |
| ⊙ RIG            | ⊙ DRY SHOWING OIL    |
| ⊕ DRILLING       | ⊙ DRY SHOWING GAS    |
| ⊙ GAS WELL       | ⊙ ABANDONED LOCATION |
| ⊙ OIL WELL       | ⊙ ABANDONED GAS WELL |
| ⊙ SMALL OIL WELL | ⊙ ABANDONED OIL WELL |

NOTE: Below make tracing from map, (when no map is obtainable make sketch) showing farm, center of section, this location with measurements and also wells, dry holes, or other locations in the vicinity of this location. Make copy to keep for reference and send original to Columbus office.

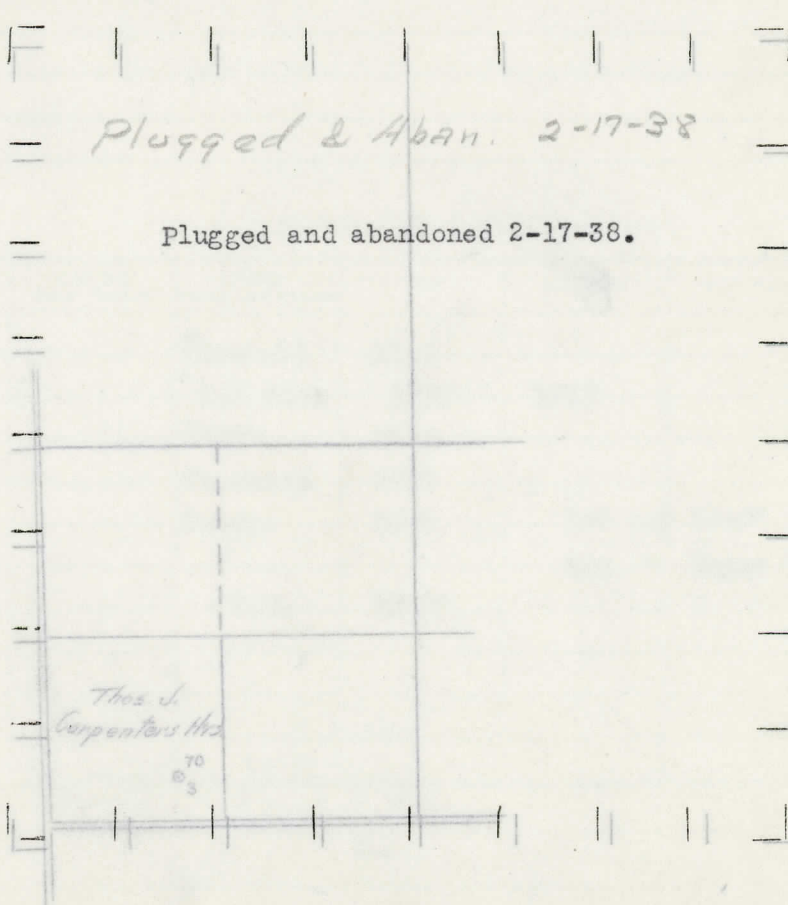

REMARKS:

SIGNED  
SIGNED

Superintendent or Foreman.  
Superintendent or Foreman.

LOCATION REPORT  
THE PURE OIL COMPANY

DATE Nov. 6, 1929

No. 70

STATE Michigan COUNTY Midland DIST. Greendale SEC. 7 TOWN 14N RANGE 2W  
WELL No. 3 (SERIAL No. 70) FARM Thomas J. Carpenters Heirs ACRES  
NAME OF STREAM OR WATERS QUADRANGLE SW 1/4 - SW 1/4  
OPERATOR Sias Oil Company MAP Greendale Township, Midland County

Feet from North Line of Farm

330 " " East " " "  
330 " " South " " "  
" " West " " "

Feet from North Line of Section

" " East " " "  
330 " " South " " "  
990 " " West " " "

LEGEND

- |                  |                      |
|------------------|----------------------|
| ○ LOCATION       | ✦ DRY HOLE           |
| ① RIG            | ✦ DRY SHOWING OIL    |
| ⊕ DRILLING       | ✦ DRY SHOWING GAS    |
| ⊗ GAS WELL       | ⊗ ABANDONED LOCATION |
| ● OIL WELL       | ⊗ ABANDONED GAS WELL |
| ⊕ SMALL OIL WELL | ⊗ ABANDONED OIL WELL |

NOTE: Below make tracing from map, (when no map is obtainable make sketch) showing farm, center of section, this location with measurements and also wells, dry holes, or other locations in the vicinity of this location. Make copy to keep for reference and send original to Columbus office.

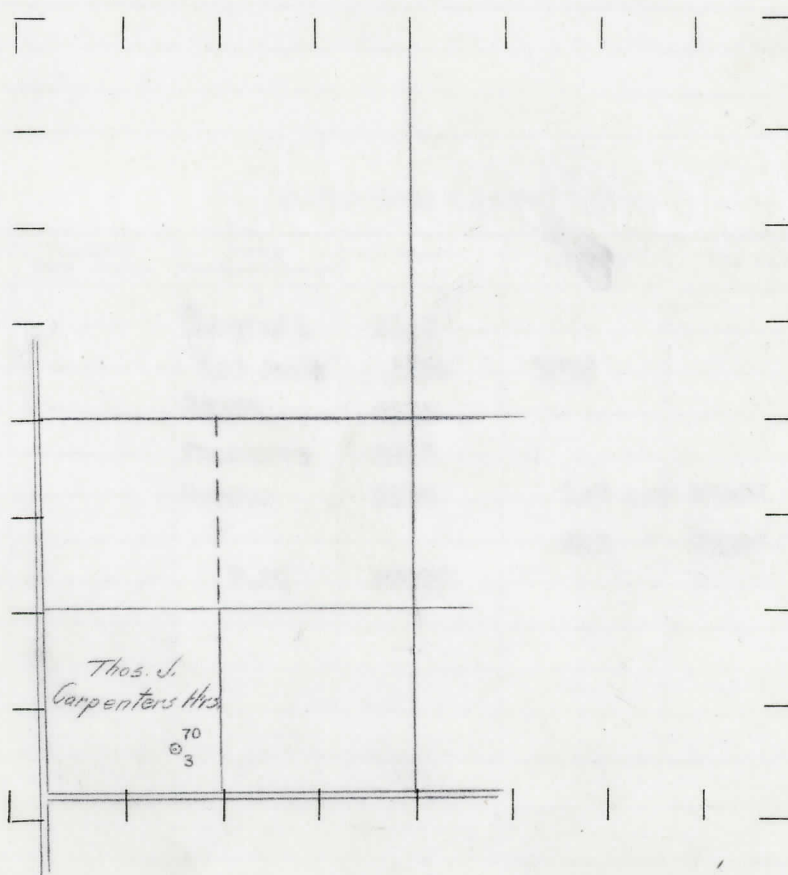

REMARKS:

SIGNED

Superintendent or Foreman.



100

No. -70-

DATE Feb. 22nd, 1930

STATE Michigan COUNTY Midland DIST. Greendale SEC. 7 TOWN 14 N RANGE 2W  
TWP. Greendale  
PREC.

WELL No. 3 (SERIAL No. 70) FARM T.J. Carpenter, heirs ACRES           

NAME OF STREAM OR WATERS \_\_\_\_\_ QUADRANGLE \_\_\_\_\_

OPERATOR Sias Oil Co. MAP Greendale Twp., Midland Co.

LOCATION REPORT SENT IN (DATE) Nov. 6th, 1929.

WELL STARTED (DATE) November 1929. WELL COMPLETED (DATE) Feb. 22nd, 1930.

## OIL WELL

**GAS WELD**

~~DEATH~~

ABANDONED WELL X

CROSS OUT THREE OF THE ABOVE  
WELL RECORD

DATE OF SHOT \_\_\_\_\_ NUMBER OF QUARTS \_\_\_\_\_

1st 24 HOURS PRODUCTION	50 bbls.	BARRELS OR FEET
-------------------------	----------	-----------------

[illegible][illegible][illegible]

5th " " "

## SAND AND CASING

[illegible][illegible]

NOTE:—MAKE COPY TO KEEP FOR REFERENCE AND SEND ORIGINAL TO CHICAGO OFFICE. LIST MATERIAL CHARGEABLE TO WELL ON OTHER SIDE.

SIGNED \_\_\_\_\_ SUPT. OR FOREMAN