



Western Michigan University
ScholarWorks at WMU

Legacy Scout Tickets from Pure Oil Company

8-20-2021

MGRRE_PureOilScoutTickets_Bushre, Elic_1_21111014810000

MGRRE

Western Michigan University

Follow this and additional works at: <https://scholarworks.wmich.edu/pure>



Part of the Geology Commons

WMU ScholarWorks Citation

MGRRE, "MGRRE_PureOilScoutTickets_Bushre, Elic_1_21111014810000" (2021). *Legacy Scout Tickets from Pure Oil Company*. 5351.

<https://scholarworks.wmich.edu/pure/5351>

This Document is brought to you for free and open access via ScholarWorks at WMU. It has been accepted for inclusion in Legacy Scout Tickets from Pure Oil Company by an authorized administrator of ScholarWorks at WMU. See the National Digital Catalogue - Science Base Catalogue for more collections submitted by MGRRE.



MGRRE_PureOilScoutTickets_Bushre, Elic_1_21111014810000

API 21111014810000

Permit Number 1481

Lease Name Bushre, Elic

Well Number 1

County Midland

Township 13N

Range 01W

Section 22

2021 DEQ or Pure co_name Smith Petroleum Company

Pure Number 353

Latitude 43.50343

Longitude -84.4183

THE PURE OIL COMPANY

DATE Dec. 10, 1935

LOCATION REPORT

No. 353

STATE Mich. COUNTY Midland DIST. Porter SEC. 22 TOWN 13 N. RANGE 1 W.
 WELL No. 11 (SERIAL No. 353) FARM Elec. Bushre ACRES 1

NAME OF STREAM OR WATERS _____ QUADRANGLE SW-SW-NEOPERATOR Smith Petroleum Co. Map Porter Twp., Midland CountyFeet from North Line of Farm _____
330 330 _____

" " East " " "

" " South " " "

" " West " " "

Feet from North Line of Section _____

" " East " " "

" " South " 1/4 "" " West " 1/4 "

LEGEND

○ LOCATION

① RIG

⊕ DRILLING

☀ GAS WELL

● OIL WELL

● SMALL OIL WELL

☉ DRY HOLE

● DRY SHOWING OIL

☉ DRY SHOWING GAS

☉ ABANDONED LOCATION

☉ ABANDONED GAS WELL

☉ ABANDONED OIL WELL

NOTE: Below make tracing from map, (when no map is obtainable make sketch) showing farm, center of section, this location with measurements and also wells, dry holes, or other locations in the vicinity of this location.

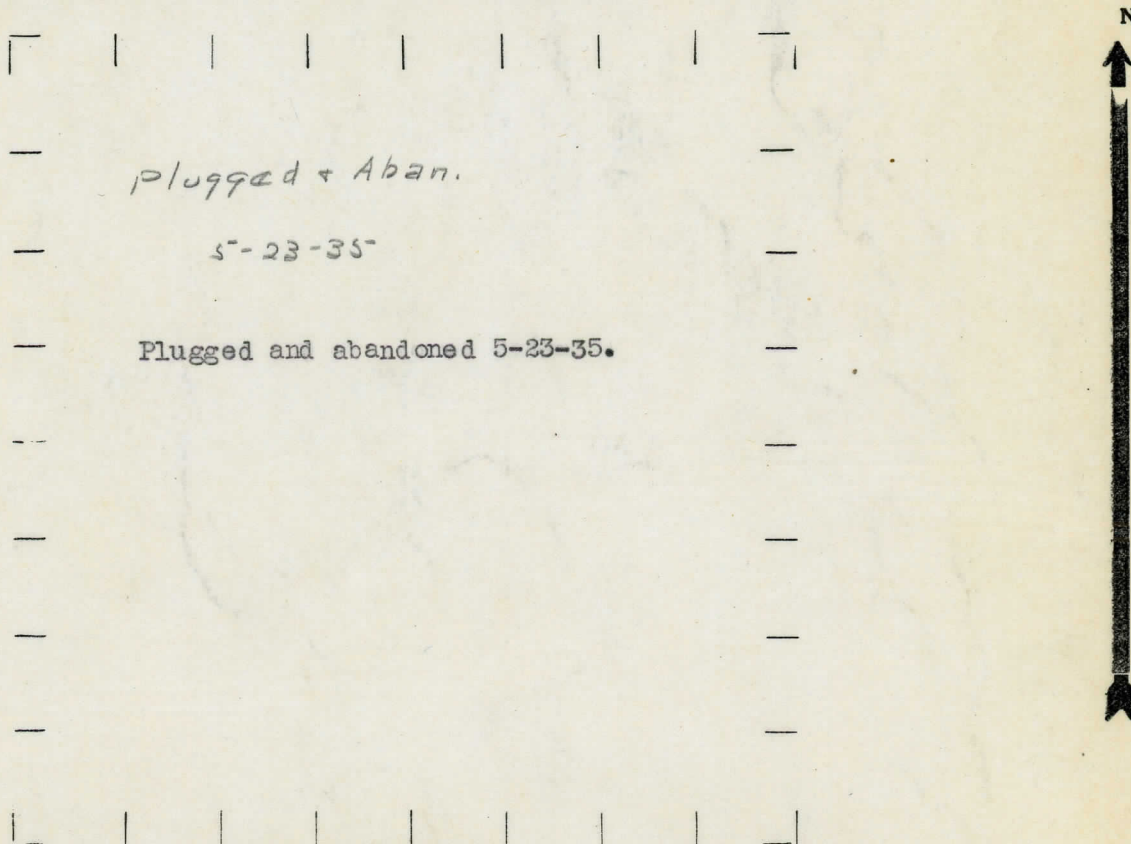

REMARKS:

SIGNED

R. L. Yeager
 Superintendent or Foreman.

DATE 3-18-33

LOCATION REPORT

No. 353

STATE Michigan COUNTY Midland DIST. TWP. Porter SEC. 22 TOWN 13N RANGE 1W

WELL No. 1 (SERIAL No. 353) FARM Elic Bushre ACRES

NAME OF STREAM OR WATERS QUADRANGLE SW-SW-NE

OPERATOR Smith Petroleum Co. MAP Porter Twp., Midland Co.

Feet from North Line of Farm

" " East " " "

330 " " South " " "

330 " " West " " "

Feet from North Line of Section

2310 " " East " " "

2970 " " South " " "

" " West " " "

LEGEND

- LOCATION
- ① RIG
- ⊕ DRILLING
- ⊗ GAS WELL
- OIL WELL
- ⬮ SMALL OIL WELL
- ⬮ DRY HOLE
- ⬮ DRY SHOWING OIL
- ⬮ DRY SHOWING GAS
- ⬮ ABANDONED LOCATION
- ⬮ ABANDONED GAS WELL
- ⬮ ABANDONED OIL WELL

NOTE: Below make tracing from map, (when no map is obtainable make sketch) showing farm, center of section, this location with measurements and also wells, dry holes, or other locations in the vicinity of this location. Make copy to keep for reference and send original to Columbus office.

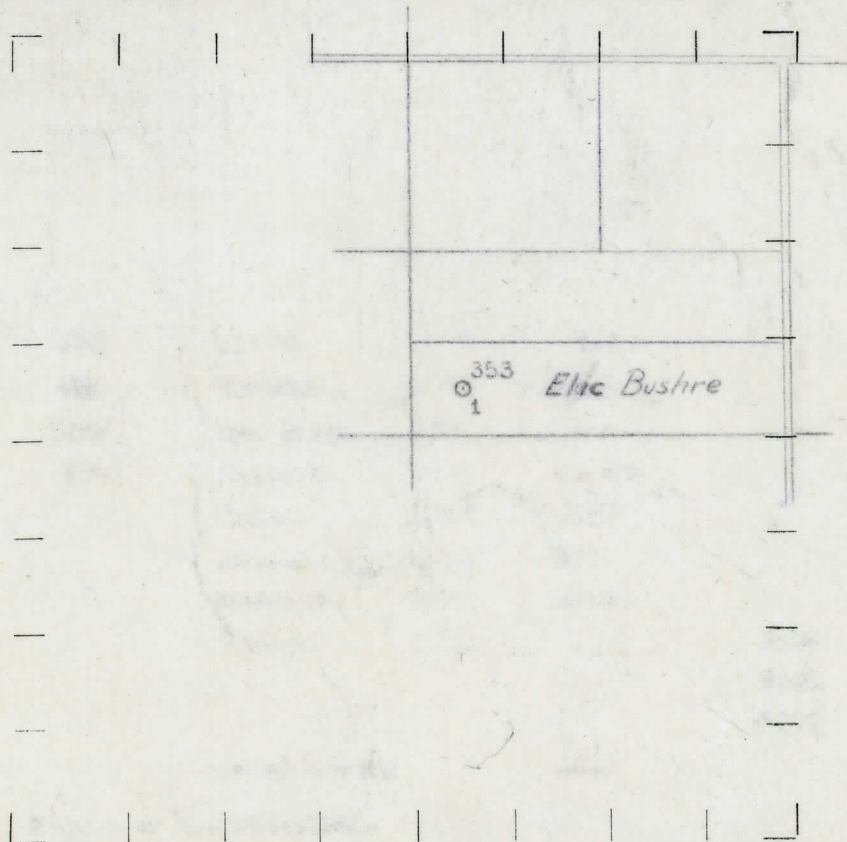

REMARKS:

SIGNED

Superintendent or Foreman.

Michigan Producing DIVISION
COMPLETION RECORD
 No. 353
 DATE 5-26-33
 STATE Michigan COUNTY Midland DIST. Porter SEC. 22 TOWN 13N RANGE 1W
 WELL No. 1 (SERIAL No. 353) FARM Elic Bushre ACRES 40
 NAME OF STREAM OR WATERS _____ QUADRANGLE S₂-S₂-NE
 OPERATOR Smith Petroleum Co. MAP Porter Twp., Midland Co.
 LOCATION REPORT SENT IN (DATE) 5-17-33

WELL STARTED (DATE) 3-16-33 WELL COMPLETED (DATE) 5-19-33
☐ OIL WELL ☐ GAS WELL ☐ DRY HOLE ☐ ABANDONED WELL

CROSS OUT THREE OF THE ABOVE
 El. 681
 WELL RECORD

DATE OF SHOT	NUMBER OF QUARTS
1st 24 HOURS PRODUCTION	<u>1047 Bbls. Natural</u> BARRELS OR FEET
2nd " " "	<u>1027 " "</u> " " "
3rd " " "	<u>970 " "</u> " " "
4th " " "	<u>847 " "</u> " " "
5th " " "	_____ " " "

SAND AND CASING								
CASING SIZE	WEIGHT	CASING Feet Inches	SAND Name and Nature	TOP	BOTTOM	TOP PAY	BOTTOM PAY	SALT WATER
<u>10"</u>		<u>239</u>	<u>Drift</u>	<u>0</u>	<u>244</u>			
<u>8 1/4"</u>		<u>780</u>	<u>Marshall</u>	<u>1054</u>	<u>1156</u>			
<u>6-5/8"</u>		<u>1259</u>	<u>Red Rock</u>	<u>1156</u>	<u>1245</u>			
<u>5-3/16"</u>		<u>3384</u>	<u>Sunbury</u>	<u>2255</u>	<u>2285</u>			
			<u>Berea</u>	<u>2285</u>	<u>2345</u>			
			<u>Antrim</u>	<u>2410</u>	<u>2797</u>			
			<u>Traverse</u>	<u>2797</u>	<u>3190</u>			
			<u>Dundee</u>	<u>3375</u>		<u>3400</u>	<u>3404</u>	
						<u>3408</u>	<u>3410</u>	
						<u>3416</u>	<u>3420</u>	
			<u>Total Depth</u>		<u>3420</u>			

REMARKS Complete log attached.

Smith Petroleum Co.
 Elic Bushre #1
 Porter Twp., Midland Co.
 Serial #353

0- 244	Drift
244- 450	White Sand
450- 480	Blue Slate
480- 570	Sand
570- 690	Black Slate
690- 725	Sandy Lime
725- 750	White Sand
750- 950	Blue Slate
950-1064	Lime Shells & Sand
1064-1156	Marshall Sand
1156-1245	Red Rock
1245-1325	Blue Slate
1325-1335	Lime Shells
1335-1475	Blue Slate
1475-1500	Red Rock
1500-2255	Gray Slate
2255-2285	Sunbury
2285-2345	Berea (Show oil 2285-2345)
2345-2410	Blue Slate
2410-2797	Brown Shale
2797-2815	Traverse
2815-2845	Blue Slate
2845-3190	Traverse Lime
3190-3375	Slate & Shells
3375	Dundee
3400-3404	Pay
3408-3410	Pay
3416-3420	Pay
3420	Total Depth

Casing record:

10"	239'
8 1/4"	780'
6-5/8"	1259'
5-3/16"	3384'