



Western Michigan University
ScholarWorks at WMU

Legacy Scout Tickets from Pure Oil Company

8-20-2021

**MGRRE_PureOilScoutTickets_Baxter, Phineas
E._1_21111014820000**

MGRRE
Western Michigan University

Follow this and additional works at: <https://scholarworks.wmich.edu/pure>



Part of the Geology Commons

WMU ScholarWorks Citation

MGRRE, "MGRRE_PureOilScoutTickets_Baxter, Phineas E._1_21111014820000" (2021). *Legacy Scout Tickets from Pure Oil Company*. 5352.
<https://scholarworks.wmich.edu/pure/5352>

This Document is brought to you for free and open access via ScholarWorks at WMU. It has been accepted for inclusion in Legacy Scout Tickets from Pure Oil Company by an authorized administrator of ScholarWorks at WMU. See the National Digital Catalogue - Science Base Catalogue for more collections submitted by MGRRE.



MGRRE_PureOilScoutTickets_Baxter, Phineas E._1_21111014820000

API 21111014820000

Permit Number 1482

Lease Name Baxter, Phineas E.

Well Number 1

County Midland

Township 13N

Range 01W

Section 22

2021 DEQ or Pure co_name Summit Petroleum Corporation

Pure Number 354

Latitude 43.50347

Longitude -84.42585

WELL REPORT - OUTSIDE OPERATIONS

Form 216-F 20M 1-14-50 P100-EPCC

SERIAL NO. 354

STATE Michigan ~~YSH~~ CO. Midland
OPERATOR Gordon Oil Co.
FARM P. E. Baxter WELL NO. 1
TWP. Porter S. 22 T. 13N R. 1W
LOC. SE SW NW

WILDCAT ☐ FIELD ☐ FIELD NAME _____

MAP NO. _____ CO-ORD. _____ ELEV. _____

STATUS Plugged and Abandoned 2-6-48Total Depth 3435'

NORTH

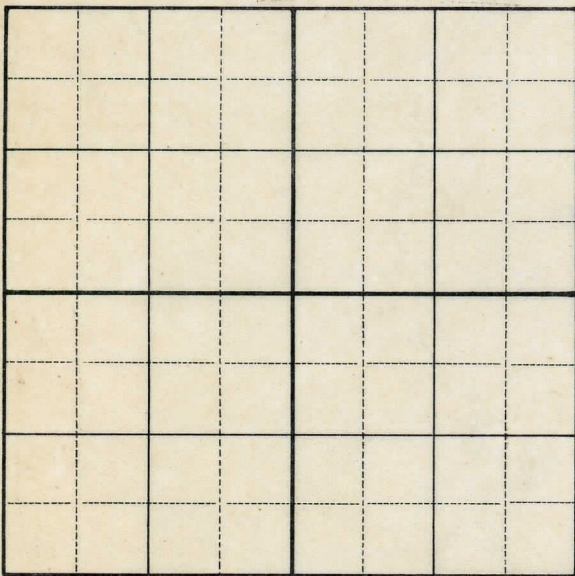
DATE 3-10-48 SCOUT H. J. G.

DATE 3-18-33 LOCATION REPORT No. 354

STATE Michigan COUNTY Midland DIST. Porter SEC. 22 TOWN 13N RANGE 1W

WELL No. 1 (SERIAL No. 354) FARM Phineas E. Baxter ACRES

NAME OF STREAM OR WATERS QUADRANGLE SE-SW-NW

OPERATOR Gordon Oil Co. MAP Porter Twp., Midland Co.

Feet from North Line of Farm

330 " " East " " "

330 " " South " " "

" " West " " "

2310 Feet from North Line of Section

" " East " " "

" " South " " "

990' " " West " " "

- LEGEND**
- | | |
|------------------|----------------------|
| O LOCATION | ✦ DRY HOLE |
| ① RIG | ✦ DRY SHOWING OIL |
| ⊕ DRILLING | ✦ DRY SHOWING GAS |
| ⊗ GAS WELL | ⊗ ABANDONED LOCATION |
| ● OIL WELL | ⊗ ABANDONED GAS WELL |
| ◆ SMALL OIL WELL | ⊗ ABANDONED OIL WELL |

NOTE: Below make tracing from map, (when no map is obtainable make sketch) showing farm, center of section, this location with measurements and also wells, dry holes, or other locations in the vicinity of this location. Make copy to keep for reference and send original to Columbus office.

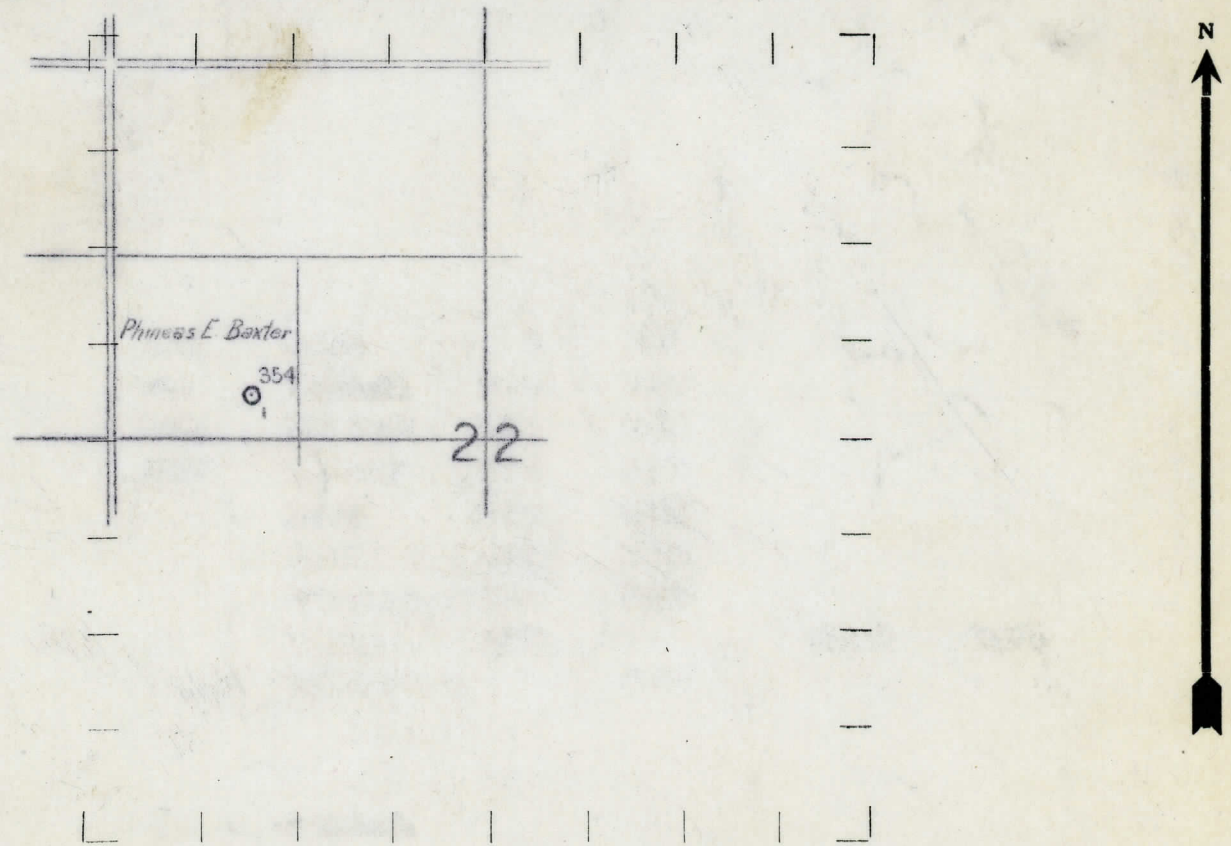

REMARKS:

SIGNED _____

Superintendent or Foreman.

DATE

6-2-33

STATE

Michigan

COUNTY

Midland

DIST. TWP. PREC.

Porter

SEC.

22

TOWN

13N

RANGE

1W

WELL No.

1

(SERIAL No. 354)

FARM

Phineas Baxter

ACRES

40

NAME OF STREAM OR WATERS

QUADRANGLE

SE-SW-NW

OPERATOR

Gordon Oil Co.

MAP

Porter Twp., Midland Co.

LOCATION REPORT SENT IN (DATE)

3-18-33

WELL STARTED (DATE)

3-12-33

WELL COMPLETED (DATE)

4-27-33

OIL WELL

GAS WELL

DRY HOLE

ABANDONED WELL

El. 681.4

CROSS OUT THREE OF THE ABOVE

WELL RECORD

DATE OF SHOT

5-27-33

NUMBER OF QUARTS

1000

1st 24 HOURS PRODUCTION

45 bbls. natural

BARRELS OR FEET

1st

238

" After acid

2nd

3rd

4th

5th

SAND AND CASING

CASING SIZE	WEIGHT	CASING Feet Inches	SAND Name and Nature	TOP	BOTTOM	TOP PAY	BOTTOM PAY	SALT WATER
10"		244½	Drift	0	244			
8½"		820	Marshall	1070	1168			
6-5/8"		1252	Red Rock	1168	1245			
5-3/16"		3367	Sunbury	2275	2283			
			Berea	2283	2345			
			Antrim	2410	2782			
			Traverse	2782	3310			
			Dundee	3365		3399½	3401½	
			Total Depth		3435			

REMARKS

Complete log attached.

DESCRIPTION	QUANTITY	MAKE	SIZE	MATERIAL
-------------	----------	------	------	----------

Gordon Oil Company
Phineas E. Barter #1
Porter Twp., Midland Co.
Serial #354

0- 201	Drift
201- 206	Cypsum Shell
206- 244	Red Sand
244- 425	White Sand
425- 525	Slate
525- 600	White Sand
600- 650	White Mud
650- 675	White Sand
675- 710	Lime Shells
710- 758	Lime
758- 784	Slate
784- 810	Lime
810- 823	Slate
823- 840	Lime
840- 880	Slate
880- 935	Lime
935- 950	Slate
950- 955	White Sand
955-1000	Sand
1000-1030	Slate
1030-1060	Sand (H.F.W. 1035)
1060-1070	Slate
1070-1168	Marshall sand
1168-1245	Red Rock
1245-1252	Blue Slate
1252-1487	Slate
1487-1515	Red Sand
1515-1525	Slate
1525-1550	White Sand
1550-1570	Lime Shells
1570-1900	Slate
1900-2075	Slate & Shells
2075-2275	Slate
2275-2283	Black Shale
2283-2345	Berea
2345-2405	Slate
2405-2410	Lime
2410-2645	Brown Shale
2645-2660	Lime
2660-2782	Brown Shale
2782-2820	Traverse Lime
2820-2850	Slate
2850-3115	Traverse Lime
3115-3135	Slate
3135-3200	Traverse Lime
3200-3285	Shale
3285-3310	Lime
3310-3365	Shale & Lime Shells
3365	Dundee
3399 $\frac{1}{2}$ -3401 $\frac{1}{2}$	Pay
3435	Total Depth

Casing Record:

10"	244 $\frac{1}{2}$ '
8 $\frac{1}{2}$ "	820'
6-5/8"	1252'
5-3/16"	3367'