



Western Michigan University
ScholarWorks at WMU

Legacy Scout Tickets from Pure Oil Company

8-20-2021

MGRRE_PureOilScoutTickets_Carter_1_21111015000000

MGRRE

Western Michigan University

Follow this and additional works at: <https://scholarworks.wmich.edu/pure>



Part of the Geology Commons

WMU ScholarWorks Citation

MGRRE, "MGRRE_PureOilScoutTickets_Carter_1_21111015000000" (2021). *Legacy Scout Tickets from Pure Oil Company*. 5362.

<https://scholarworks.wmich.edu/pure/5362>

This Document is brought to you for free and open access via ScholarWorks at WMU. It has been accepted for inclusion in Legacy Scout Tickets from Pure Oil Company by an authorized administrator of ScholarWorks at WMU. See the National Digital Catalogue - Science Base Catalogue for more collections submitted by MGRRE.



MGRRE_PureOilScoutTickets_Carter_1_21111015000000

API 21111015000000

Permit Number 1500

Lease Name Carter

Well Number 1

County Midland

Township 13N

Range 01W

Section 18

2021 DEQ or Pure co_name Carter Lease, Incorporated

Pure Number 368

Latitude 43.51614

Longitude -84.48032

THE PURE OIL COMPANY
THE PURE OIL COMPANY
LOCATION REPORT

DATE February 20, 1941

No. 368

DATE 4-28-53

STATE Michigan COUNTY Midland

DIST. Porter

SEC. 18

TOWN 13N

RANGE 1W

WELL No. 1 (SERIAL No. 368) FARM

~~Wm. M. Carter~~

40 ACRES

NAME OF STREAM OR WATERS

QUADRANGLE NE NE SW

OPERATOR Carter Lease Inc.

Map Porter Township, Midland County

Feet from North Line of Farm

" " East " " "

" " South " " "

" " West " " "

Feet from North Line of Section

" " East " " "

" " South " " "

" " West " " "

LEGEND

○ LOCATION

① RIG

⊕ DRILLING

☼ GAS WELL

● OIL WELL

◆ SMALL OIL WELL

⊖ DRY HOLE

◆ DRY SHOWING OIL

⊖ DRY SHOWING GAS

⊖ ABANDONED LOCATION

☼ ABANDONED GAS WELL

● ABANDONED OIL WELL

NOTE: Below make tracing from map, (when no map is obtainable make sketch) showing farm, center of section, this location with measurements and also wells, dry holes, or other locations in the vicinity of this location.

Plugged and abandoned 1-1-40.
Total Depth 3425'.

N

REMARKS:

SIGNED

Superintendent or Foreman.

OBSEVATOR *Carlisle Lease Inc.*

LOCATION REPORT *Carlisle Leasing Company*

NAME OF SURVEYOR OR MEASURER

QUADRANGLE *NE NE 2M*

STATE *Michigan* COUNTY *Midland*

DIST *Porter*

MEET NO *1* (SERIAL NO *368*) ELEV *10*

PREC *Wm. M. Carter*

WELL No. *1* (SERIAL No. *368*) FARM *Wm. M. Carter* *40* ACRES

NAME OF STREAM OR WATERS QUADRANGLE *NE NE 2M*

OPERATOR *Carlisle Leasing Inc.* MAP

330 Feet from North Line of Farm

330 " " East " " "

" " South " " "

" " West " " "

330 Feet from North Line of Section

" " East " " "

" " South " " "

2050 " " West " " "

LEGEND

○ LOCATION

① RIG

⊕ DRILLING

⊗ GAS WELL

● OIL WELL

⬮ SMALL OIL WELL

⬮ DRY HOLE

⬮ DRY SHOWING OIL

⬮ DRY SHOWING GAS

⬮ ABANDONED LOCATION

⬮ ABANDONED GAS WELL

⬮ ABANDONED OIL WELL

NOTE: Below make tracing from map, (when no map is obtainable make sketch) showing farm, center of section, this location with measurements and also wells, dry holes, or other locations in the vicinity of this location. Make copy to keep for reference and send original to Columbus office.

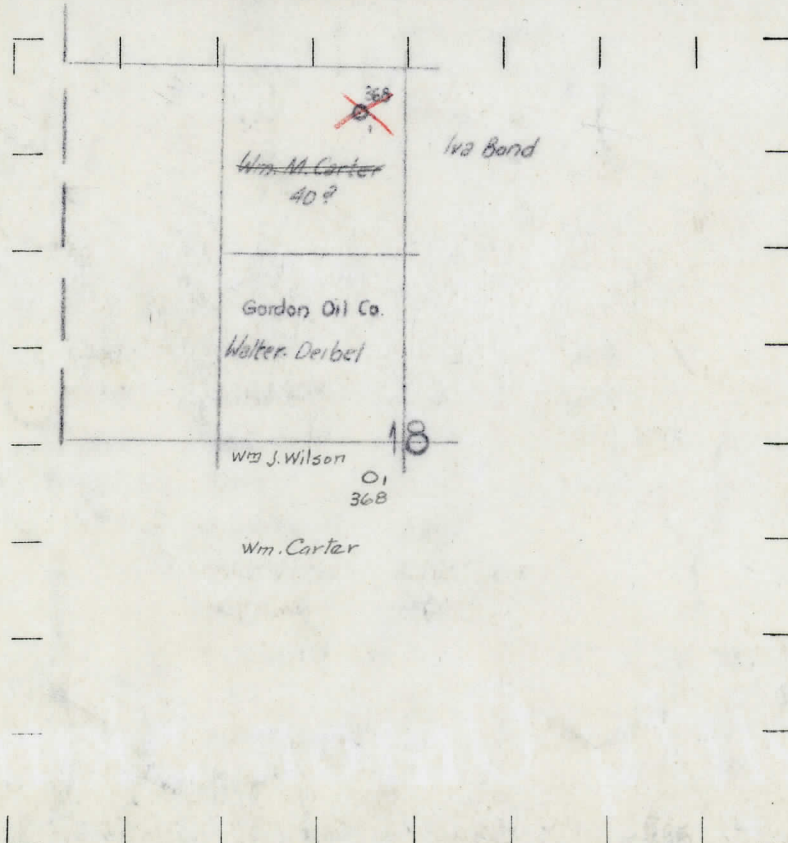

REMARKS: *Formerly carried as W. J. Wilson Tr., operator*

SIGNED

Superintendent or Foreman.

THE PURE OIL COMPANY

Michigan Producing DIVISION
COMPLETION RECORDNo. **368**DATE **8-25-33**STATE **Michigan**COUNTY **Midland**DIST.
TWP. **Porter**
PREC.SEC. **18**TOWN **13N** RANGE **1W**WELL No. **1** (SERIAL No. **368**) FARM **Wm. M. Carter**ACRES **40**

NAME OF STREAM OR WATERS

QUADRANGLE **NE-NW**OPERATOR **Wm. J. Wilson, Trustee**MAP **Porter Twp., Midland Co.**LOCATION REPORT SENT IN (DATE) **4-28-33**WELL STARTED (DATE) **4-28-33**WELL COMPLETED (DATE) **8-17-33**

OIL WELL

GAS WELL

DRY HOLE

ABANDONED WELL

El. **684'**

CROSS OUT THREE OF THE ABOVE

WELL RECORD

DATE OF **Acid** **7-19-33**

NUMBER OF QUARTS

1st 24 HOURS PRODUCTION

Est. **100 bbls. natural**

BARRELS OR FEET

1st " " **770 " after acid****2nd** " " **700 " " "****3rd** " " **650 " " "****4th** " " **600 " " "**

SAND AND CASING

CASING SIZE	WEIGHT	CASING Feet Inches	SAND Name and Nature	TOP	BOTTOM	TOP PAY	BOTTOM PAY	SALT WATER
10"		304'	Drift	0	304			
8 1/4"		787'	Marshall	1040	1197			
6-5/8"		1298'	Red Rock	1197	1290 OTM			
5-3/16"		3391'	Berea	2335				
			Antrim	2430				
			Traverse	2770 OTM				
			Dundee	3381				
					Light pay	3407	3410	
						3420	3422	
			Total Depth		3425			

REMARKS **Show gas 3391.**

SIGNED

W. A. Thomas
Supt. or Foreman