



Western Michigan University  
ScholarWorks at WMU

---

Legacy Scout Tickets from Pure Oil Company

---

8-20-2021

**MGRRE\_PureOilScoutTickets\_Baxter, Clarence**  
**L.\_1\_21111015130000**

MGRRE  
*Western Michigan University*

Follow this and additional works at: <https://scholarworks.wmich.edu/pure>



Part of the Geology Commons

---

#### WMU ScholarWorks Citation

MGRRE, "MGRRE\_PureOilScoutTickets\_Baxter, Clarence L.\_1\_21111015130000" (2021). *Legacy Scout Tickets from Pure Oil Company*. 5367.  
<https://scholarworks.wmich.edu/pure/5367>

This Document is brought to you for free and open access via ScholarWorks at WMU. It has been accepted for inclusion in Legacy Scout Tickets from Pure Oil Company by an authorized administrator of ScholarWorks at WMU. See the National Digital Catalogue - Science Base Catalogue for more collections submitted by MGRRE.



---

MGRRE\_PureOilScoutTickets\_Baxter, Clarence L.\_1\_21111015130000

API 21111015130000

Permit Number 1513

Lease Name Baxter, Clarence L.

Well Number 1

County Midland

Township 13N

Range 01W

Section 22

2021 DEQ or Pure co\_name Summit Petroleum Corporation

Pure Number 375

Latitude 43.5088347

Longitude -84.4132822

## WELL REPORT - OUTSIDE OPERATIONS

430

SERIAL NO. 375-420

STATE Michigan ~~BSN~~ CO. MidlandOPERATOR Turner Petroleum Corp.FARM Clarence L. Baxter WELL NO. 1-2-3TWP. Porter S. 22 T. 13N R. 1W  
~~SURVEY~~

LOC. \_\_\_\_\_

WILDCAT ☐ FIELD ☐ FIELD NAME \_\_\_\_\_

MAP NO. \_\_\_\_\_ CO-ORD. \_\_\_\_\_ ELEV. \_\_\_\_\_

STATUS \_\_\_\_\_

Operator's name corrected from:  
Charles H. Bell

NORTH

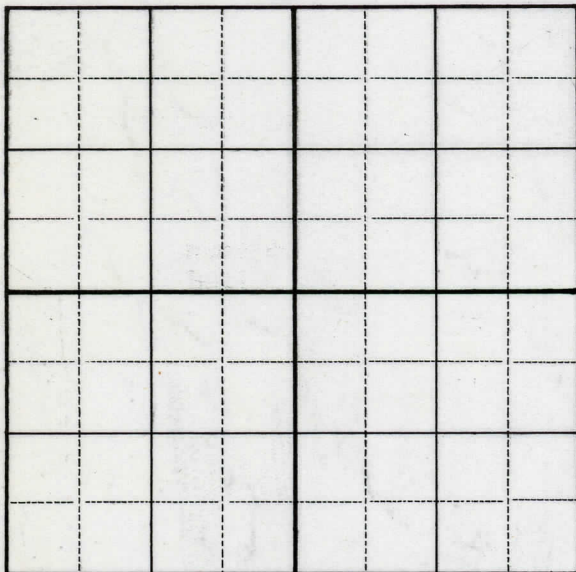
DATE 10-11-54 SCOUT JEC

THE PURE OIL COMPANY

Date July 21, 1943 Corrected LOCATION REPORT A.F.E. No. \_\_\_\_\_

Division Mich. Producing District \_\_\_\_\_ Lease Clarence L. Baxter

Acres \_\_\_\_\_ Lease No. \_\_\_\_\_ Elevation \_\_\_\_\_ Well No. 1 (Serial No. 375)

Quadrangle NW NE NE Sec. 22 Twp. 13 N Rge. 1 W ~~Porter~~ Porter















Survey \_\_\_\_\_ County Midland State Michigan

Operator Charles H. Bell Map Porter Township, Midland County

_____	Feet from North Line of Lease
_____	" " East " " "
_____	" " South " " "
_____	" " West " " "
_____	Feet from North Line of Section
_____	" " East " " "
_____	" " South " " "
_____	" " West " " "

LEGEND

○ Location

- |   |   |
|---|---|
|  Gas Well  |  Dry Showing Gas   |
|  Oil Well  |  Abandoned Location  |
|  Gas - Distillate Well   |  or  Abandoned Gas Well |
|  or  Dry Hole |  or  Abandoned Oil Well |
|  Dry Showing Oil   |  or  Input Well         |

See plat - Midland No. 375.

N

Remarks: Change of operator. Scale \_\_\_\_\_

Submitted by Scouting Dept.-J.S. ~~XXXXXX~~ Approved by \_\_\_\_\_ Division Manager

Approved by \_\_\_\_\_ Vice-President - General Manager

Date

JUN 3 1937

Collected

LOCATION REPORT

A.E.E. No.

DATE June 3, 1937

Corrected

LOCATION REPORT

No. 375

STATE Michigan

COUNTY Midland

DIST.

TWP. Porter

SEC. 22

TOWN 13 N

RANGE 1 W

WELL No. 1 (SERIAL No. 375) FARM

C. L. Baxter

ACRES

NAME OF STREAM OR WATERS

QUADRANGLE NW-NE-NE

OPERATOR Turner Petroleum Corporation

Map

Porter Township, Midland County

330 330

Feet from North Line of Farm

" " East " " "

" " South " " "

330 330

" " West " " "

330 330

Feet from North Line of Section

790 990

" " East " " "

" " South " " "

" " West " " "

## LEGEND

O LOCATION

① RIG

⊕ DRILLING

⊗ GAS WELL

● OIL WELL

⊙ SMALL OIL WELL

⊙ DRY HOLE

⊙ DRY SHOWING OIL

⊙ DRY SHOWING GAS

⊙ ABANDONED LOCATION

⊙ ABANDONED GAS WELL

⊙ ABANDONED OIL WELL

NOTE: Below make tracing from map, (when no map is obtainable make sketch) showing farm, center of section, this location with measurements and also wells, dry holes, or other locations in the vicinity of this location.

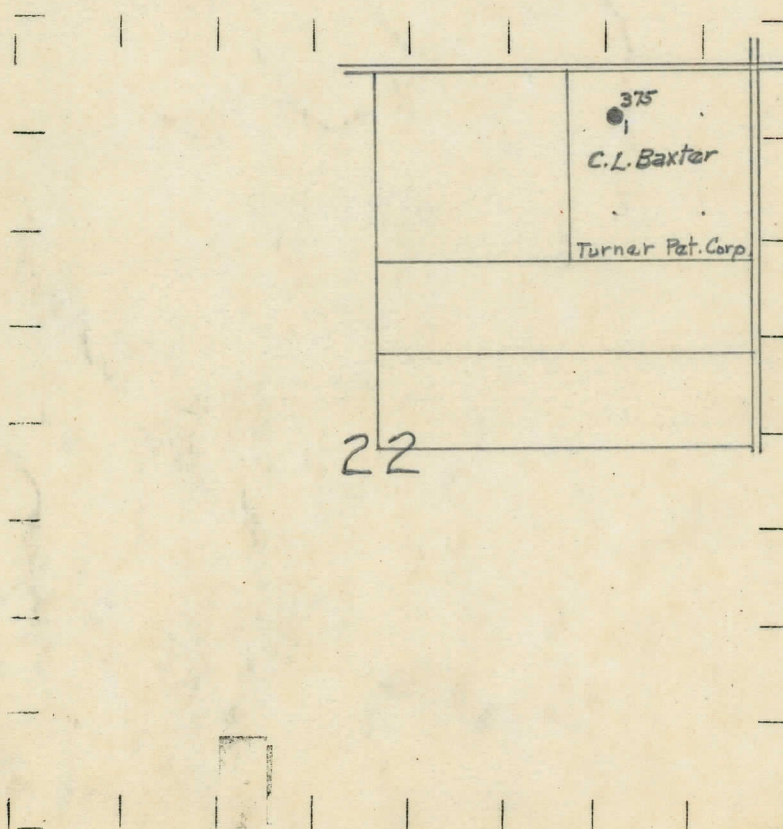

REMARKS:

SIGNED

R. L. Young

Superintendent or Foreman.

STATE Michigan COUNTY Midland DIST. Porter SEC. 22 TOWN 13N RANGE 1W  
DATE 5-12-33 LOCATION REPORT No. 375  
WELL No. 1 (SERIAL No. 375) FARM C. L. Baxter 40 ACRES  
NAME OF STREAM OR WATERS QUADRANGLE NE<sup>1</sup>-NE<sup>1</sup>  
OPERATOR Fred Turner MAP

330 Feet from North Line of Farm

" " East " " "

" " South " " "

330 " " West " " "

330 Feet from North Line of Section

990 " " East " " "

" " South " " "

" " West " " "

LEGEND

○ LOCATION

① RIG

⊗ DRILLING

⊗ GAS WELL

● OIL WELL

⬮ SMALL OIL WELL

⬮ DRY HOLE

⬮ DRY SHOWING OIL

⬮ DRY SHOWING GAS

⬮ ABANDONED LOCATION

⬮ ABANDONED GAS WELL

⬮ ABANDONED OIL WELL

NOTE: Below make tracing from map, (when no map is obtainable make sketch) showing farm, center of section, this location with measurements and also wells, dry holes, or other locations in the vicinity of this location. Make copy to keep for reference and send original to Columbus office.

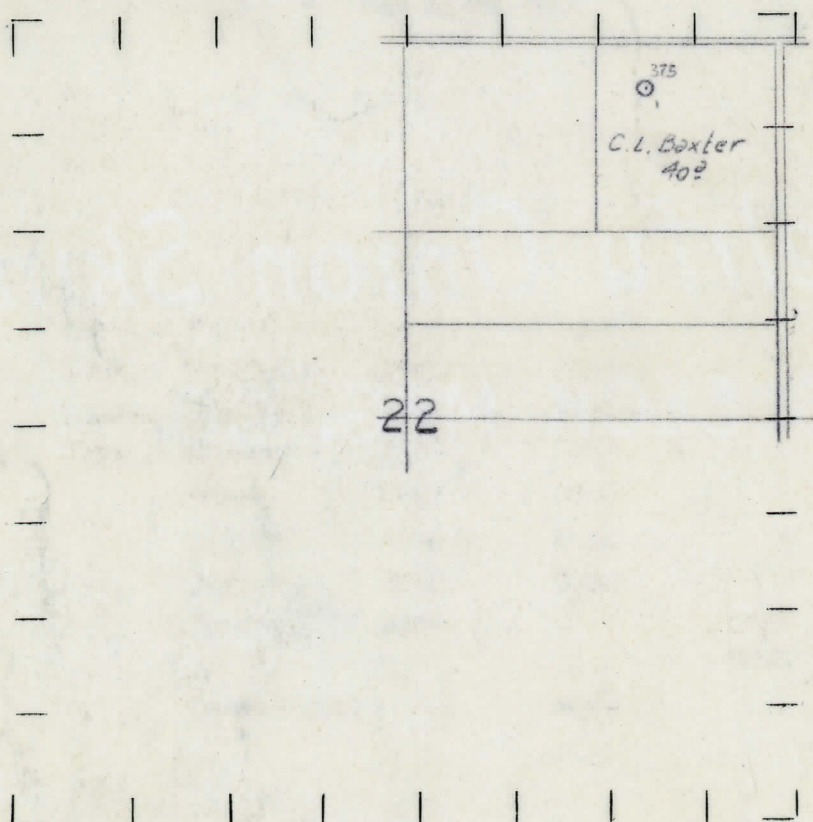

REMARKS:

SIGNED

Superintendent or Foreman.

Michigan Producing DIVISION  
**COMPLETION RECORD** No. 375

STATE Michigan COUNTY Midland DIST. TWP. Porter SEC. 22 TOWN 13N RANGE 1W  
PREC.

WELL No. 1 (SERIAL No. 375) FARM C. J. Baxter ACRES 40

NAME OF STREAM OR WATERS QUADRANGLE NE-NE

OPERATOR Fred Turner MAP Porter Twp., Midland Co.

LOCATION REPORT SENT IN (DATE) 5-12-33

WELL STARTED (DATE) 5-16-33 WELL COMPLETED (DATE) 6-19-33

☐ OIL WELL ☒ GAS WELL ☐ DRY HOLE ☐ ABANDONED WELL

El. 678 CROSS OUT THREE OF THE ABOVE  
WELL RECORD

DATE OF Acid 6-28-33 NUMBER OF Gallons 1000  
SHOT QUARTS

1st 24 HOURS PRODUCTION 173 bbls. natural BARRELS OR FEET  
1st. " " 738 " net after acid " " "  
2nd " " " " " " "  
3rd " " " " " " "  
4th " " " " " " "  
5th " " " " " " "

**SAND AND CASING**

CASING SIZE	WEIGHT	CASING Feet Inches	SAND Name and Nature	TOP	BOTTOM	TOP PAY	BOTTOM PAY	SALT WATER
10"		235'	Drift	0	265			
8 1/4"		758'	Marshall	1065	1170			
6-5/8"		1250'	Red Rock	1170	1243			
5-3/16"		3364'	Sunbury	2270	2287			
			Berea	2287	2350			
			Antrim	2410	2782			
			Traverse	2782	3158			
			Dundee	3356		3381	3389	
						3393	3403	
			Total Depth		3409		Show	3407-3409

REMARKS Complete log attached. Plugged back to 3405'.

DESCRIPTION	QUANTITY	MAKE	SIZE	MATERIAL
-------------	----------	------	------	----------

LIST OF MATERIAL CHARGEABLE TO WELL No.

Fred Turner  
C. L. Baxter No. 1  
Porter Twp., Midland Co.  
Serial #375

0- 265	Drift
265- 420	White Sand
420- 435	Lime
435- 475	White Sand
475- 485	Shale
485- 570	Sandy Lime
570- 628	Brown Shale
628- 640	White Shale
640- 645	Lime
645- 690	Shale & Shells
690- 710	Lime
710- 745	Shale & Lime
745- 750	Sandy Lime
750- 758	Green Shale
758- 820	Shale
820- 995	Shale & Shells
995-1018	Lime & Gypsum
1018-1065	Sandy Gray Shale
1065-1170	Marshall Sand
1170-1243	Red Sand
1243-1250	Dark Shale
1250-1325	Gray Shale
1325-1345	Red Sand
1345-1460	Gray Shale
1460-1540	Red Sandy Shale
1540-2265	Gray Shale
2265-2270	Lime
2270-2287	Black Shale
2287-2350	Berea Sand
2350-2410	Gray Shale
2410-2782	Brown Shale
2782-2810	Traverse Lime
2810-2848	Gray Shale
2848-3158	Gray Traverse Lime
3158-3356	Gray Shale
3356 SJM	Dundee
3381-3389	1st Pay
3396-3403	2nd Pay
3407-3409	Show Salt Water
3409	Total Depth
	Plugged back to 3405

Casing:

10"	235'
8 1/4"	758'
6-5/8"	1250'
5-3/16"	3364'