



Western Michigan University
ScholarWorks at WMU

Legacy Scout Tickets from Pure Oil Company

8-20-2021

MGRRE_PureOilScoutTickets_Carter, H._1_21111015500000

MGRRE

Western Michigan University

Follow this and additional works at: <https://scholarworks.wmich.edu/pure>



Part of the Geology Commons

WMU ScholarWorks Citation

MGRRE, "MGRRE_PureOilScoutTickets_Carter, H._1_21111015500000" (2021). *Legacy Scout Tickets from Pure Oil Company*. 5390.

<https://scholarworks.wmich.edu/pure/5390>

This Document is brought to you for free and open access via ScholarWorks at WMU. It has been accepted for inclusion in Legacy Scout Tickets from Pure Oil Company by an authorized administrator of ScholarWorks at WMU. See the National Digital Catalogue - Science Base Catalogue for more collections submitted by MGRRE.



MGRRE_PureOilScoutTickets_Carter, H._1_21111015500000

API 21111015500000

Permit Number 1550

Lease Name Carter, H.

Well Number 1

County Midland

Township 13N

Range 01W

Section 21

2021 DEQ or Pure co_name Summit Petroleum Corporation

Pure Number 400

Latitude 43.5089469

Longitude -84.4382269

WELL REPORT - OUTSIDE OPERATIONS

SERIAL NO. 400-417-418STATE Michigan ~~PSH~~ Midland
CO.OPERATOR Maude H. FurbeeFARM H. Carter WELL NO. 1-2-3TWP. Porter S. 21 T. 13N R. 1W
SURVEY

LOC. _____

WILDCAT ☐ FIELD ☐ FIELD NAME _____

MAP NO. _____ CO-ORD. _____ ELEV. _____

STATUS _____

Operator's name changed from:
The Stewart Oil Company

NORTH

DATE 12-13-48 SCOUT H. J. G.

STATE Michigan ~~PSH~~ CO. Midland
 OPERATOR Stewart Oil Co.
 FARM H. Carter WELL NO. 1
 TWP. Porter S. 21 T. 13N R. 1W
 SURVEY
 LOC. NW NW NE

WILDCAT ☐ FIELD ☐ FIELD NAME _____

MAP NO. _____ CO-ORD. _____ ELEV. _____

STATUS Plugged and Abandoned 1-26-48
Total Depth 3393'

NORTH

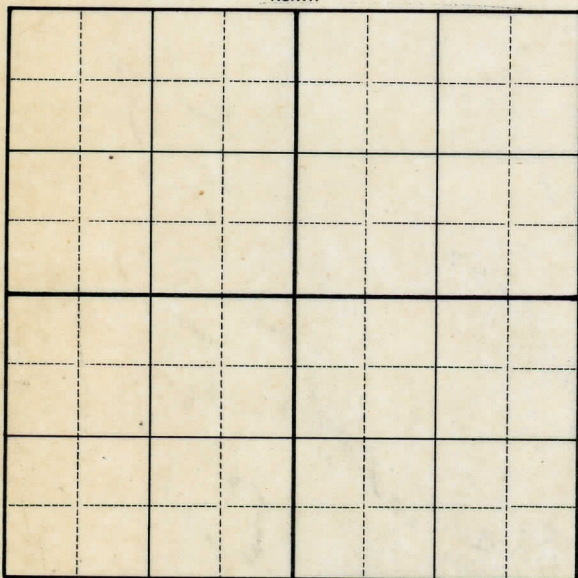

DATE 2-18-48 SCOUT H. J. G.

DATE December 16, 1937

Corrected

THE PURE OIL COMPANY

LOCATION REPORT

No. 400STATE Michigan

COUNTY

Midland

DIST.

Porter

TWP.

Porter

SEC.

21

TOWN

13 N

RANGE

1 WWELL No. 1(SERIAL No. 400)

FARM

PREC.

Carter

ACRES

NAME OF STREAM OR WATERS

QUADRANGLE

NW-NW-NE
NW NW NE

OPERATOR

Stewart Oil Company

Map

Porter Township, Midland County330 330

Feet from North Line of Farm

" " East " " "

" " South " " "

330 330

" " West " " "

330 330

Feet from North Line of Section

" " East " " "

" " South " " "

330 330" " West 1/4 "

LEGEND

○ LOCATION

① RIG

⊕ DRILLING

☼ GAS WELL

● OIL WELL

⬮ SMALL OIL WELL

⊖ DRY HOLE

⬮ DRY SHOWING OIL

⊖ DRY SHOWING GAS

⊖ ABANDONED LOCATION

☼ ABANDONED GAS WELL

⬮ ABANDONED OIL WELL

NOTE: Below make tracing from map, (when no map is obtainable make sketch) showing farm, center of section, this location with measurements and also wells, dry holes, or other locations in the vicinity of this location.

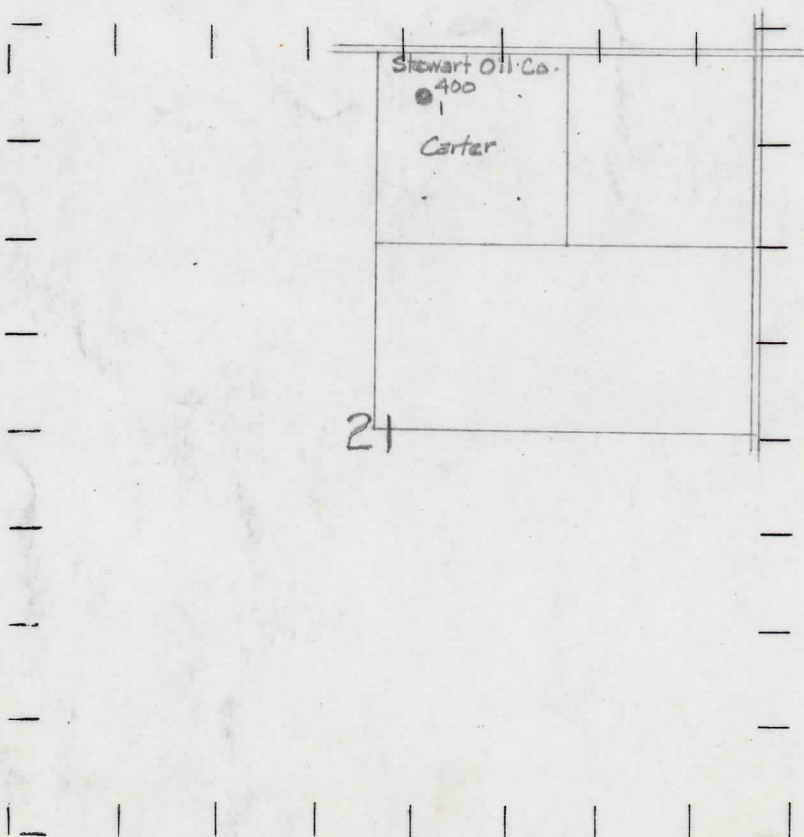

REMARKS:

SIGNED

Superintendent or Foreman.

DATE December 18 1923 collected FOCALION BELOEL No. 400

DATE 6-23-33 LOCATION REPORT No. 400

STATE Michigan COUNTY Midland DIST. Porter SEC. 21 TOWN 13N RANGE 1W

WELL No. 1 (SERIAL No. 400) FARM H. Carter 40 ACRES

NAME OF STREAM OR WATERS _____ QUADRANGLE NW 1/4 - NE 1/4

OPERATOR Edw. Stewart MAP _____

330 Feet from North Line of Farm

“ “ East “ “ “

“ “ South “ “ “

330 “ “ West “ “ “

330 Feet from North Line of Section

2310 “ “ East “ “ “

“ “ South “ “ “

“ “ West “ “ “

- LEGEND**
- LOCATION
 - ① RIG
 - ⊕ DRILLING
 - ⊗ GAS WELL
 - OIL WELL
 - ⬮ SMALL OIL WELL
 - ⬮ DRY HOLE
 - ⬮ DRY SHOWING OIL
 - ⬮ DRY SHOWING GAS
 - ⬮ ABANDONED LOCATION
 - ⬮ ABANDONED GAS WELL
 - ⬮ ABANDONED OIL WELL

NOTE: Below make tracing from map, (when no map is obtainable make sketch) showing farm, center of section, this location with measurements and also wells, dry holes, or other locations in the vicinity of this location. Make copy to keep for reference and send original to Columbus office.

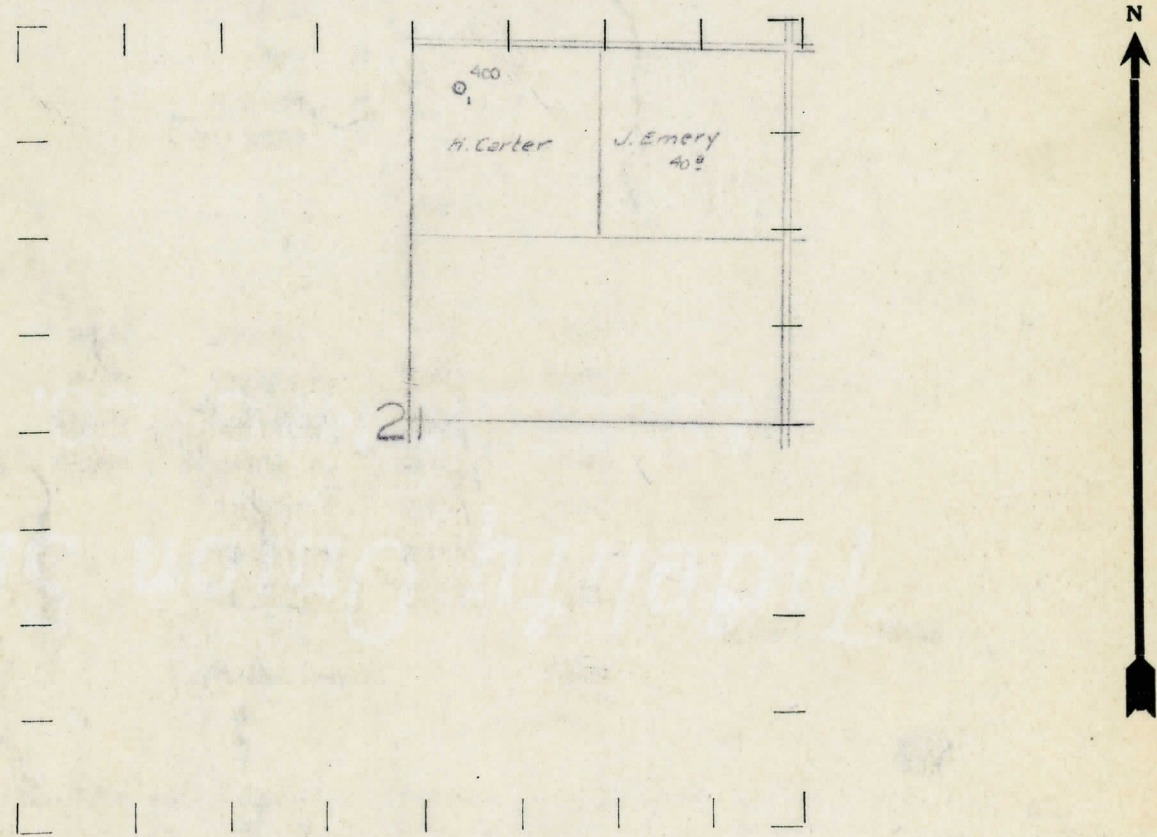

REMARKS: _____

SIGNED _____

W. E. Thastone
Superintendent or Foreman

DYLE 8-82-329

FOCALION KEROKI
THE PURE OIL COMPANY

NO. 400

Michigan Producing DIVISION
COMPLETION RECORD

No. 400

DATE **8-18-33**

STATE **Michigan** COUNTY **Midland** DIST. TWP. **Porter** SEC. **21** TOWN **13N** RANGE **1W**

WELL No. **1** (SERIAL No. **400**) FARM **H. Carter** ACRES

NAME OF STREAM OR WATERS QUADRANGLE **NW-NE**

OPERATOR **Edw. Stewart** MAP **Porter Twp., Midland Co.**

LOCATION REPORT SENT IN (DATE) **6-23-33**

WELL STARTED (DATE) **6-23-33** WELL COMPLETED (DATE) **8-10-33**

OIL WELL	GAS WELL	DRY HOLE	ABANDONED WELL
----------	----------	----------	----------------

El. 682.8

CROSS OUT THREE OF THE ABOVE
WELL RECORD

DATE OF SHOT NUMBER OF QUARTS

1st 24 HOURS PRODUCTION	1162 bbls.	BARRELS OR FEET
2nd " " "	1002 "	" " "
3rd " " "	1150 "	" " "
4th " " "	1162 "	" " "
5th " " "	1028 "	" " "

SAND AND CASING

CASING SIZE	WEIGHT	CASING Feet Inches	SAND Name and Nature	TOP	BOTTOM	TOP PAY	BOTTOM PAY	SALT WATER
10"		235'	Drift	0	278			
8 1/2"		278'	Marshall	1030	1165			
6-5/8"		1263'	Red Rock	1165	1255 CTM			
5-3/16"		3357'	Berea	2280	2325			
			Antrim	2340	2780			
			Traverse	2780				
			Dundee	3345	SIM			
						3369	3382	
			Total Depth		3393			

REMARKS

NOTE:—MAKE COPY TO KEEP FOR REFERENCE AND SEND ORIGINAL TO CHICAGO OFFICE. LIST MATERIAL CHARGEABLE TO WELL ON OTHER SIDE.

SIGNED W. A. Thomas
geol. Supt. or Foreman