



Western Michigan University
ScholarWorks at WMU

Legacy Scout Tickets from Pure Oil Company

8-20-2021

MGRRE_PureOilScoutTickets_Bond, Harry_1_21111015570000

MGRRE

Western Michigan University

Follow this and additional works at: <https://scholarworks.wmich.edu/pure>



Part of the Geology Commons

WMU ScholarWorks Citation

MGRRE, "MGRRE_PureOilScoutTickets_Bond, Harry_1_21111015570000" (2021). *Legacy Scout Tickets from Pure Oil Company*. 5395.

<https://scholarworks.wmich.edu/pure/5395>

This Document is brought to you for free and open access via ScholarWorks at WMU. It has been accepted for inclusion in Legacy Scout Tickets from Pure Oil Company by an authorized administrator of ScholarWorks at WMU. See the National Digital Catalogue - Science Base Catalogue for more collections submitted by MGRRE.



MGRRE_PureOilScoutTickets_Bond, Harry_1_21111015570000

API 21111015570000

Permit Number 1557

Lease Name Bond, Harry

Well Number 1

County Midland

Township 14N

Range 02W

Section 20

2021 DEQ or Pure co_name Atha, Hunter

Pure Number 412

Latitude 43.58883

Longitude -84.56963

THE PURE OIL COMPANY

LOCATION REPORT

No. **412**DATE **6-30-33**STATE **Michigan** COUNTY **Midland** DIST. TWP. **Greendale** SEC. **20** TOWN **14N** RANGE **2W**
WELL No. **1** (SERIAL No. **412**) FARM **Harry J. Bond** **80** ACRESNAME OF STREAM OR WATERS QUADRANGLE **N¹/₂-SE¹/₄**OPERATOR **W. Hunter Atha** MAP

Feet from North Line of Farm

330 " " East " " "

" " South " " "

" " West " " "

Feet from North Line of Section

330 " " East " " "**2310** " " South " " "

" " West " " "

LEGEND

○ LOCATION

① RIG

⊕ DRILLING

⊗ GAS WELL

● OIL WELL

⦿ SMALL OIL WELL

✧ DRY HOLE

✦ DRY SHOWING OIL

✧ DRY SHOWING GAS

⦿ ABANDONED LOCATION

✧ ABANDONED GAS WELL

⦿ ABANDONED OIL WELL

NOTE: Below make tracing from map, (when no map is obtainable make sketch) showing farm, center of section, this location with measurements and also wells, dry holes, or other locations in the vicinity of this location. Make copy to keep for reference and send original to Columbus office.

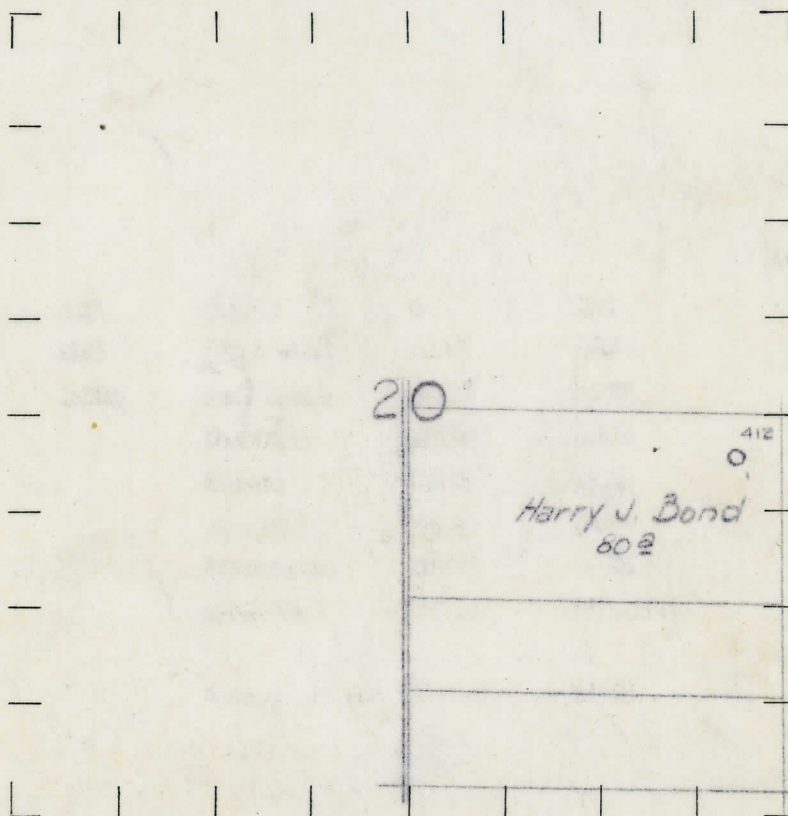

N

REMARKS:

SIGNED

Superintendent or Foreman.

THE PURE OIL COMPANY

Michigan Producing Division

DATE 9-29-33

COMPLETION RECORD

No. 412

STATE Michigan COUNTY Midland DIST. TWP. Greendale SEC. 20 TOWN 14 N RANGE 2 W

WELL No. 1 (SERIAL No. 412) FARM Harry J. Bond ACRES 80

NAME OF STREAM OR WATERS QUADRANGLE N₁ - SE₄

OPERATOR W. Hunter Atha MAP Greendale Township, Midland County

LOCATION REPORT SENT IN (DATE) 6-30-33

WELL STARTED (DATE) 7-1-33 WELL COMPLETED (DATE) 9-27-33

~~Oil Well~~

~~Gas Well~~

DRY HOLE

~~Water Well~~

Elevation 699.3

CROSS OUT THREE OF THE ABOVE
WELL RECORD

DATE OF SHOT NUMBER OF QUARTS

1st 24 HOURS PRODUCTION Dry Hole BARRELS OR FEET

2nd " " " " " "

3rd " " " " " "

4th " " " " " "

5th " " " " " "

SAND AND CASING

CASING SIZE	WEIGHT	CASING Feet Inches	SAND Name and Nature	TOP	BOTTOM	TOP PAY	BOTTOM PAY	SALT WATER
10"		321	Drift	0	308			
8 1/4"		896	Marshall	1185	1282			
6-5/8"		1386	Red Rock	1282	1375			
			Sunbury	2355	2385			
			Berea	2385	2415			
			Antrim	2475	2909			
			Tiaverse	2909	3339			
			Dundee	3533	S.L.M.			3680
			Total Depth		3683			

REMARKS

Show Oil 3044' - Salt Water 3680' - Filled up 300' in an hour