



Western Michigan University
ScholarWorks at WMU

Legacy Scout Tickets from Pure Oil Company

8-20-2021

MGRRE_PureOilScoutTickets_Carter, H._2_21111015630000

MGRRE

Western Michigan University

Follow this and additional works at: <https://scholarworks.wmich.edu/pure>



Part of the Geology Commons

WMU ScholarWorks Citation

MGRRE, "MGRRE_PureOilScoutTickets_Carter, H._2_21111015630000" (2021). *Legacy Scout Tickets from Pure Oil Company*. 5400.

<https://scholarworks.wmich.edu/pure/5400>

This Document is brought to you for free and open access via ScholarWorks at WMU. It has been accepted for inclusion in Legacy Scout Tickets from Pure Oil Company by an authorized administrator of ScholarWorks at WMU. See the National Digital Catalogue - Science Base Catalogue for more collections submitted by MGRRE.



MGRRE_PureOilScoutTickets_Carter, H._2_21111015630000

API 21111015630000

Permit Number 1563

Lease Name Carter, H.

Well Number 2

County Midland

Township 13N

Range 01W

Section 21

2021 DEQ or Pure co_name Furbee, Maude

Pure Number 417

Latitude 43.50897

Longitude -84.43573

WELL REPORT - OUTSIDE OPERATIONS

SERIAL NO. 417

STATE Michigan ~~PSH~~ CO. Midland

OPERATOR Maude H. Furbee

FARM H. Carter WELL NO. 2

TWP. Porter S. 21 T. 13N R. 1W

LOC. NE NW NE

WILDCAT ☐ FIELD ☐ FIELD NAME _____

MAP NO. _____ CO-ORD. _____ ELEV. _____

STATUS Total Depth 3390'.Plugged and Abandoned 9-25-50.

NORTH

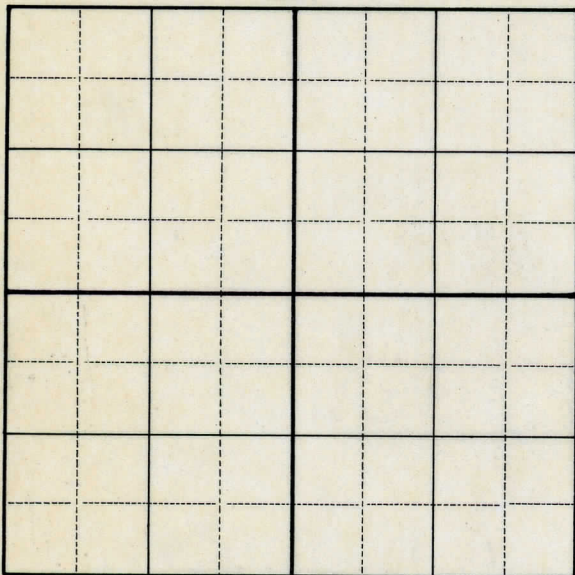
DATE 10-24-50 SCOUT H. J. G.

DATE December 16, 1937

Corrected

LOCATION REPORT

No. 417STATE Michigan

COUNTY

MidlandDIST.
TWP.
PREC.PorterSEC. 21

TOWN

13 N

RANGE

1 WWELL No. 2 (SERIAL No. 417) FARM

ACRES

NAME OF STREAM OR WATERS

QUADRANGLE

NE-NW-NEOPERATOR Stewart Oil Company Maudie H. Purbee MapPorter Township, Midland County330 330

Feet from North Line of Farm

330 330

" " East " " "

" " South " " "

" " West " " "

330 330

Feet from North Line of Section

" " East " " "

" " South " " "

990 990" " West " 1 1/4 "

LEGEND

○ LOCATION

① RIG

⊕ DRILLING

☼ GAS WELL

● OIL WELL

● SMALL OIL WELL

⊙ DRY HOLE

⊙ DRY SHOWING OIL

⊙ DRY SHOWING GAS

⊙ ABANDONED LOCATION

☼ ABANDONED GAS WELL

● ABANDONED OIL WELL

NOTE: Below make tracing from map, (when no map is obtainable make sketch) showing farm, center of section, this location with measurements and also wells, dry holes, or other locations in the vicinity of this location.

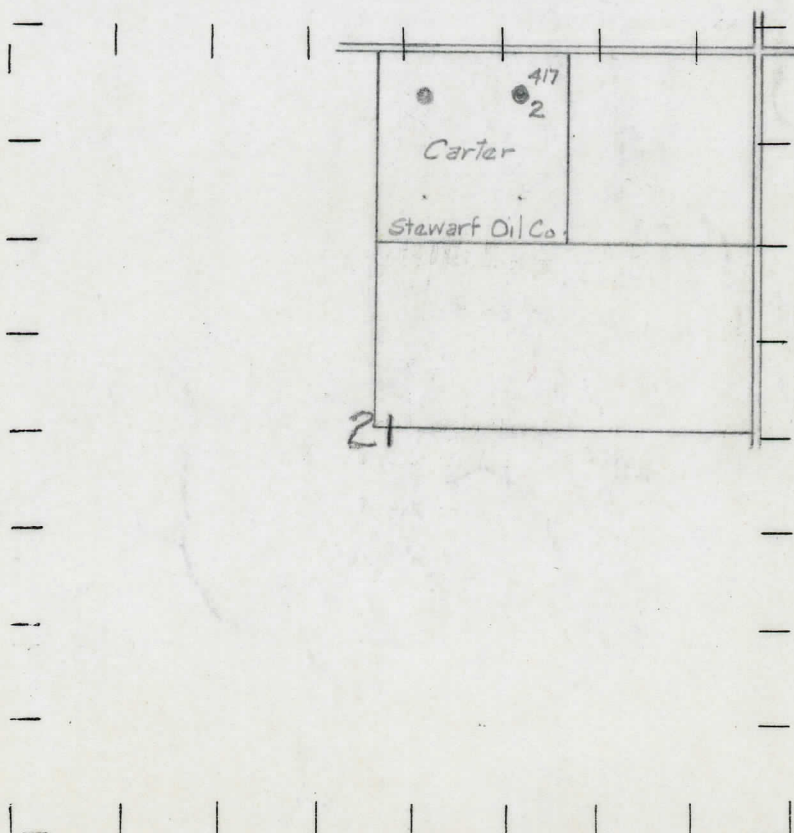

REMARKS:

SIGNED

Superintendent or Foreman.

DATE December 10 1931

collected

LOCATION REPORT

No.

417

DATE 7-7-33

LOCATION REPORT

No. 417

STATE Michigan COUNTY Midland DIST. Porter SEC 21 TOWN 13N RANGE 1W

WELL No. 2 (SERIAL No. 417) FARM H. Carter 40 ACRES

NAME OF STREAM OR WATERS QUADRANGLE NW1-NE1

OPERATOR Edw. Stewart MAP

330 Feet from North Line of Farm

330 " " East " " "

" " South " " "

" " West " " "

330 Feet from North Line of Section

1650 " " East " " "

" " South " " "

" " West " " "

LEGEND

O LOCATION

① RIG

⊕ DRILLING

⊗ GAS WELL

● OIL WELL

⦿ SMALL OIL WELL

⦿ DRY HOLE

⦿ DRY SHOWING OIL

⦿ DRY SHOWING GAS

⦿ ABANDONED LOCATION

⦿ ABANDONED GAS WELL

⦿ ABANDONED OIL WELL

NOTE: Below make tracing from map, (when no map is obtainable make sketch) showing farm, center of section, this location with measurements and also wells, dry holes, or other locations in the vicinity of this location. Make copy to keep for reference and send original to Columbus office.

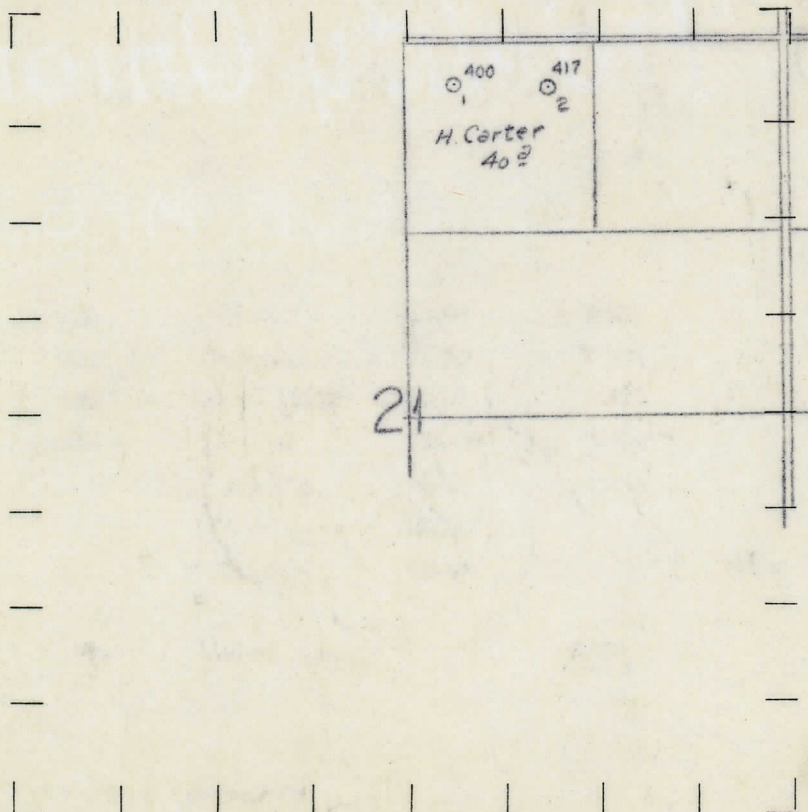

REMARKS:

SIGNED

W. E. Hagston
Superintendent or Foreman.

THE PURE OIL COMPANY

Michigan Producing DIVISION

COMPLETION RECORD

No. 417

DATE 10-20-33

STATE Michigan COUNTY Midland DIST. TWP. Porter SEC. 21 TOWN 13 N RANGE 1 W

WELL No. 2 (SERIAL No. 417) FARM H. Carter ACRES 40

NAME OF STREAM OR WATERS QUADRANGLE NW-NE

OPERATOR Edw. Stewart MAP Porter Township, Midland County

LOCATION REPORT SENT IN (DATE) 7-7-33

WELL STARTED (DATE) 8-22-33 WELL COMPLETED (DATE) 10-12-33

OIL WELL

~~GAS WELL~~~~WATER HOLE~~~~ABANDONED WELL~~

Elevation 680.3

CROSS OUT THREE OF THE ABOVE
WELL RECORD

DATE OF SHOT NUMBER OF QUARTS

1st 24 HOURS PRODUCTION Estimated 1500 bbls. natural BARRELS OR FEET

2nd " " " " " " "

3rd " " " " " " "

4th " " " " " " "

5th " " " " " " "

SAND AND CASING

CASING SIZE	WEIGHT	CASING Feet Inches	SAND Name and Nature	TOP	BOTTOM	TOP PAY	BOTTOM PAY	SALT WATER
10"		285	Stray	1018	1041			1018-1041
8 1/2"		724	Marshall	1050	1140			
6-5/8"		1245	Red Rock	1140	1235			
5-3/16		3349	Berea	2300	2320			
			Antrim	2425	2764			
			Traverse	2764				
			Dundee	3346		3366	3382	
			Total Depth		3390			

REMARKS

Show Oil 2300-2305

Flowed 840 Bbls. 1st 14 hrs. after completing