



Western Michigan University  
ScholarWorks at WMU

---

Legacy Scout Tickets from Pure Oil Company

---

8-20-2021

**MGRRE\_PureOilScoutTickets\_Baxter, C. L.\_3\_21111015850000**

MGRRE

*Western Michigan University*

Follow this and additional works at: <https://scholarworks.wmich.edu/pure>



Part of the Geology Commons

---

#### WMU ScholarWorks Citation

MGRRE, "MGRRE\_PureOilScoutTickets\_Baxter, C. L.\_3\_21111015850000" (2021). *Legacy Scout Tickets from Pure Oil Company*. 5409.

<https://scholarworks.wmich.edu/pure/5409>

This Document is brought to you for free and open access via ScholarWorks at WMU. It has been accepted for inclusion in Legacy Scout Tickets from Pure Oil Company by an authorized administrator of ScholarWorks at WMU. See the National Digital Catalogue - Science Base Catalogue for more collections submitted by MGRRE.



---

**MGRRE\_PureOilScoutTickets\_Baxter, C. L.\_3\_21111015850000**

API 21111015850000

Permit Number 1585

Lease Name Baxter, C. L.

Well Number 3

County Midland

Township 13N

Range 01W

Section 22

2021 DEQ or Pure co\_name Turner Petroleum Corporation

Pure Number 430

Latitude 43.50702

Longitude -84.41076

## WELL REPORT—OUTSIDE OPERATIONS

THE PURE O

SERIAL NO. 430

STATE Michigan ~~MSH~~ CO. MidlandOPERATOR Charles H. BellFARM C. L. Baxter WELL NO. 3TWP. Porter S. 22 T. 13N R. 1W  
~~SURVEY~~LOC. SE NE NE

MAP NO. \_\_\_\_\_ CO-ORD. \_\_\_\_\_ ELEV. \_\_\_\_\_

STATUS Plugged and abandoned 8-27-47Total depth 3400'

NORTH

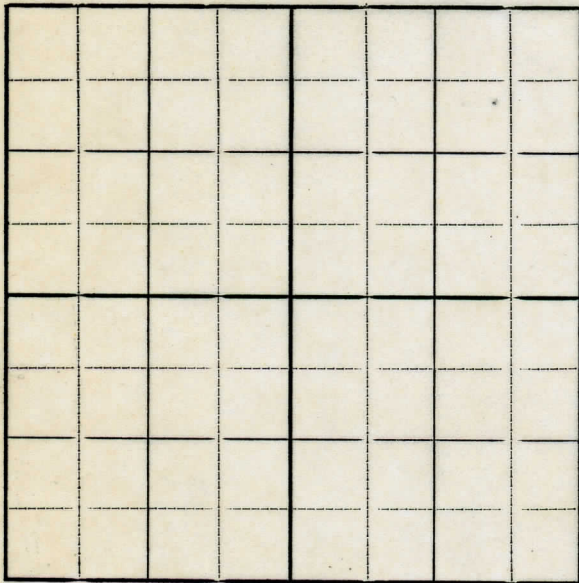













DATE 9-10-47 SCOUT H. J. G.

Date July 21, 1943 Corrected LOCATION REPORT A.F.E. No. \_\_\_\_\_  
Division Mich. Producing District \_\_\_\_\_ Lease C. L. Baxter  
Acres \_\_\_\_\_ Lease No. \_\_\_\_\_ Elevation \_\_\_\_\_ Well No. 3 (Serial No. 430)  
Quadrangle SE NE NE Sec. 22 Twp. 13 N Rge. 1 W ~~Porter~~ Porter  
Survey \_\_\_\_\_ County Midland State Michigan  
Operator Charles H. Bell Map Porter Township, Midland County

\_\_\_\_ Feet from North Line of Lease  
" " East " " "  
" " South " " "  
" " West " " "  
\_\_\_\_ Feet from North Line of Section  
" " East " " "  
" " South " " "  
" " West " " "

LEGEND

○ Location

 Gas Well	 Dry Showing Gas
 Oil Well	 Abandoned Location
 Gas - Distillate Well	 or  Abandoned Gas Well
 or  Dry Hole	 or  Abandoned Oil Well
 Dry Showing Oil	 or  Input Well

See plat - Midland #430.



Remarks: Change of operator. Scale \_\_\_\_\_  
Submitted by Scouting Dept.-J.S. Approved by \_\_\_\_\_ Division Manager  
Engineer Approved by \_\_\_\_\_ Vice-President-General Manager

DATE June 3, 1937 Corrected LOCATION REPORT No. 430  
STATE Michigan COUNTY Midland DIST. Porter SEC. 22 TOWN 13 N RANGE 1 W  
WELL No. 33 (SERIAL No. 430) FARM C. L. Baxter ACRES  
NAME OF STREAM OR WATERS QUADRANGLE SE NE NE

OPERATOR Turner Petroleum Corporation Map Porter Township, Midland County  
Turner Pet Corp.

Feet from North Line of Farm  
330 330 " " East " " "  
330 330 " " South " " "  
" " West " " "  
990 990 Feet from North Line of Section  
330 330 " " East " " "  
" " South " " "  
" " West " " "

- LEGEND
- |                  |                      |
|------------------|----------------------|
| ○ LOCATION       | ⊙ DRY HOLE           |
| ⊕ RIG            | ⊕ DRY SHOWING OIL    |
| ⊕ DRILLING       | ⊕ DRY SHOWING GAS    |
| ☀ GAS WELL       | ⊙ ABANDONED LOCATION |
| ● OIL WELL       | ☀ ABANDONED GAS WELL |
| ⬮ SMALL OIL WELL | ● ABANDONED OIL WELL |

NOTE: Below make tracing from map, (when no map is obtainable make sketch) showing farm, center of section, this location with measurements and also wells, dry holes, or other locations in the vicinity of this location.

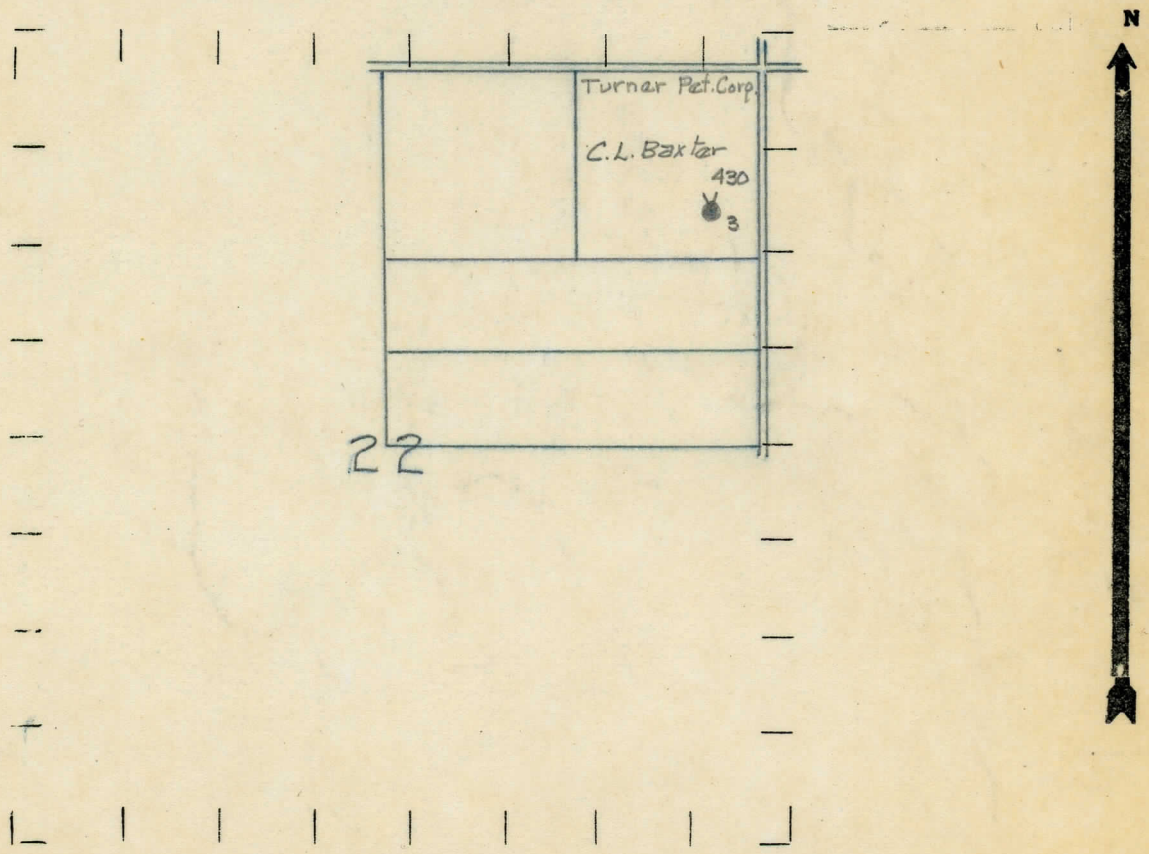

REMARKS:

SIGNED R. L. Yeager  
Superintendent or Foreman.

STATE Michigan COUNTY Midland DIST. TWP. Porter SEC. 22 TOWN 13N RANGE 1W  
WELL No. 3 (SERIAL No. 430) FARM C. L. Baxter 40 ACRES  
NAME OF STREAM OR WATERS QUADRANGLE SE NE-NE-NE  
OPERATOR Fred W. Turner MAP Midland Co., Porter Twp.

990 Feet from North Line of Farm

330 " " East " " "

" " South " " "

" " West " " "

990 Feet from North Line of Section

330 " " East " " "

" " South " " "

" " West " " "

LEGEND

O LOCATION

① RIG

⊕ DRILLING

⊗ GAS WELL

● OIL WELL

⦿ SMALL OIL WELL

⦿ DRY HOLE

⦿ DRY SHOWING OIL

⦿ DRY SHOWING GAS

⦿ ABANDONED LOCATION

⦿ ABANDONED GAS WELL

⦿ ABANDONED OIL WELL

NOTE: Below make tracing from map, (when no map is obtainable make sketch) showing farm, center of section, this location with measurements and also wells, dry holes, or other locations in the vicinity of this location. Make copy to keep for reference and send original to Columbus office.

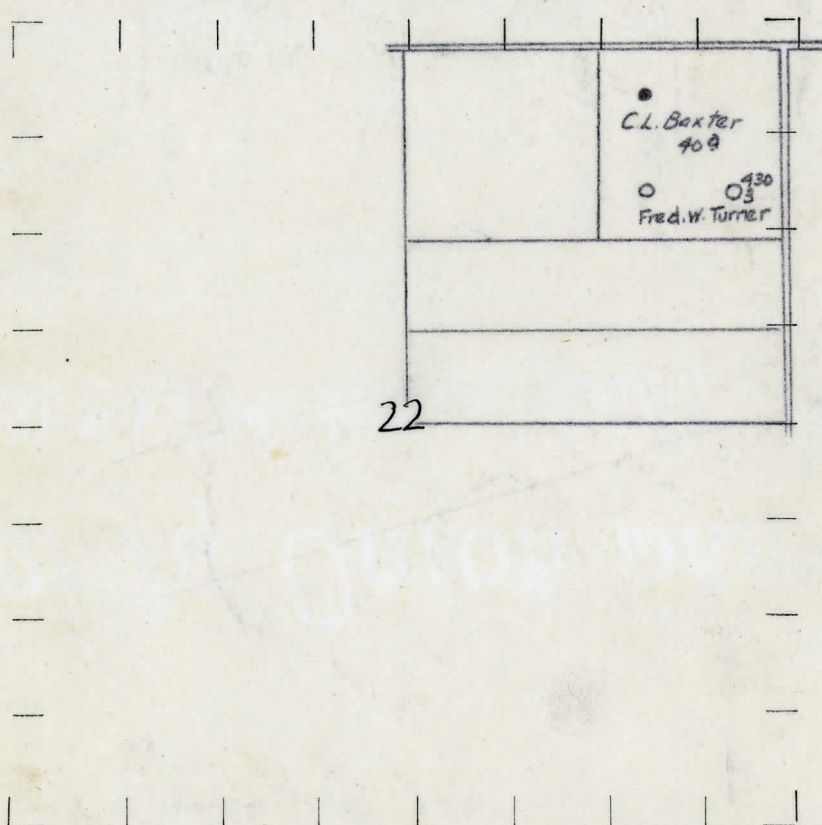

REMARKS:

SIGNED

Superintendent or Foreman.

## DIVISION

No. 430

NOTE:—MAKE COPY TO KEEP FOR REFERENCE AND SEND ORIGINAL TO COLUMBUS OFFICE. LIST MATERIAL CHARGEABLE TO WELL ON OTHER SIDE. SIGNED B. N. Wells SUPT. OR FOREMAN.

DESCRIPTION	QUANTITY	MAKE	SIZE	MATERIAL
-------------	----------	------	------	----------

Michigan Producing Division

Date April 4. 1935 No. 430  
 State Michigan County Midland Dist. Porter  
 (Serial No.) Twp. Porter Sec. 22 Twp. 13N Rge. 1W  
 Well No. 3 (County No.) 430 Farm C. L. Baxter Acres \_\_\_\_\_  
 Operator Fred W. Turner et al by Information secured Scouting Department  
 Date well started 2/7/35 Date well completed 3/15/35 Elevation 681'

PRODUCTION RECORD

1st 24 hours natural 30 bbls.  
 2nd 24 hours natural \_\_\_\_\_  
 Date of shot \_\_\_\_\_ No. of quarts \_\_\_\_\_ From \_\_\_\_\_ to \_\_\_\_\_ From \_\_\_\_\_ to \_\_\_\_\_  
 Date of acid 3/23/35 No. of gallons 1000  
 shot  
 1st 24 hours after acid 286 bbls.  
 shot  
 2nd 24 hours after acid \_\_\_\_\_

FORMATION AND CASING RECORD

Formation	Top	Bottom	Top Pay	Bottom Pay	Remarks	Casing	
						Size	Set at
<u>Stray</u>	<u>1056</u>					<u>10"</u>	<u>260'</u>
<u>Marshall</u>	<u>1078</u>	<u>1166</u>				<u>8 1/4"</u>	<u>780'</u>
<u>Red Rock</u>	<u>1166</u>	<u>1245</u>				<u>6-5/8"</u>	<u>1265'</u>
<u>Sunbury</u>	<u>2289</u>	<u>2298</u>				<u>5-3/16"</u>	<u>3367'</u>
<u>Berea</u>	<u>2298</u>	<u>2416</u>					
<u>Antrim</u>	<u>2416</u>	<u>2802</u>					
<u>Traverse Lime</u>	<u>2802</u>	<u>3365</u>					
<u>Dundee</u>	<u>3365</u>	<u>S.L.M.</u>					
			<u>3388</u>	<u>Show O. &amp; G.</u>			
			<u>3397</u>	<u>3403</u>			
<u>Total Depth</u>	<u>3403 1/2'</u>				<u>Show Salt Water 3403 1/2'</u> <u>Plugged back to 3400'</u>		

Remarks \_\_\_\_\_  
 \_\_\_\_\_  
 \_\_\_\_\_  
 \_\_\_\_\_

Signed S. H. Bell  
2