



Western Michigan University
ScholarWorks at WMU

Legacy Scout Tickets from Pure Oil Company

8-20-2021

MGRRE_PureOilScoutTickets_Baxter, Clarence
L._4_21111016090000

MGRRE
Western Michigan University

Follow this and additional works at: <https://scholarworks.wmich.edu/pure>



Part of the Geology Commons

WMU ScholarWorks Citation

MGRRE, "MGRRE_PureOilScoutTickets_Baxter, Clarence L._4_21111016090000" (2021). *Legacy Scout Tickets from Pure Oil Company*. 5420.
<https://scholarworks.wmich.edu/pure/5420>

This Document is brought to you for free and open access via ScholarWorks at WMU. It has been accepted for inclusion in Legacy Scout Tickets from Pure Oil Company by an authorized administrator of ScholarWorks at WMU. See the National Digital Catalogue - Science Base Catalogue for more collections submitted by MGRRE.



MGRRE_PureOilScoutTickets_Baxter, Clarence L._4_21111016090000

API 21111016090000

Permit Number 1609

Lease Name Baxter, Clarence L.

Well Number 4

County Midland

Township 13N

Range 01W

Section 22

2021 DEQ or Pure co_name Turner Petroleum Corporation

Pure Number 447

Latitude 43.50884

Longitude -84.41076

DATE June 3, 1937Corrected LOCATION REPORTNo. 447STATE Michigan COUNTY Midland DIST. Porter TWP. Porter SEC. 22 TOWN 13 N RANGE 1 WWELL No. 44 (SERIAL No. 447) FARM C. L. Baxter ACRESNAME OF STREAM OR WATERS QUADRANGLE NE-NE-NE
NE NE NEOPERATOR Turner Petroleum CorporationMap Porter Township, Midland County
Porter - Mid330 330Turner Pet Corp.
Feet from North Line of Farm330 330

" " East " " "

" " South " " "

" " West " " "

330 330

Feet from North Line of Section

330 330

" " East " " "

" " South " " "

" " West " " "

LEGEND

○ LOCATION

⊙ RIG

⊕ DRILLING

☼ GAS WELL

● OIL WELL

⦿ SMALL OIL WELL

⊖ DRY HOLE

⦿ DRY SHOWING OIL

☼ DRY SHOWING GAS

⊖ ABANDONED LOCATION

☼ ABANDONED GAS WELL

⦿ ABANDONED OIL WELL

NOTE: Below make tracing from map, (when no map is obtainable make sketch) showing farm, center of section, this location with measurements and also wells, dry holes, or other locations in the vicinity of this location.

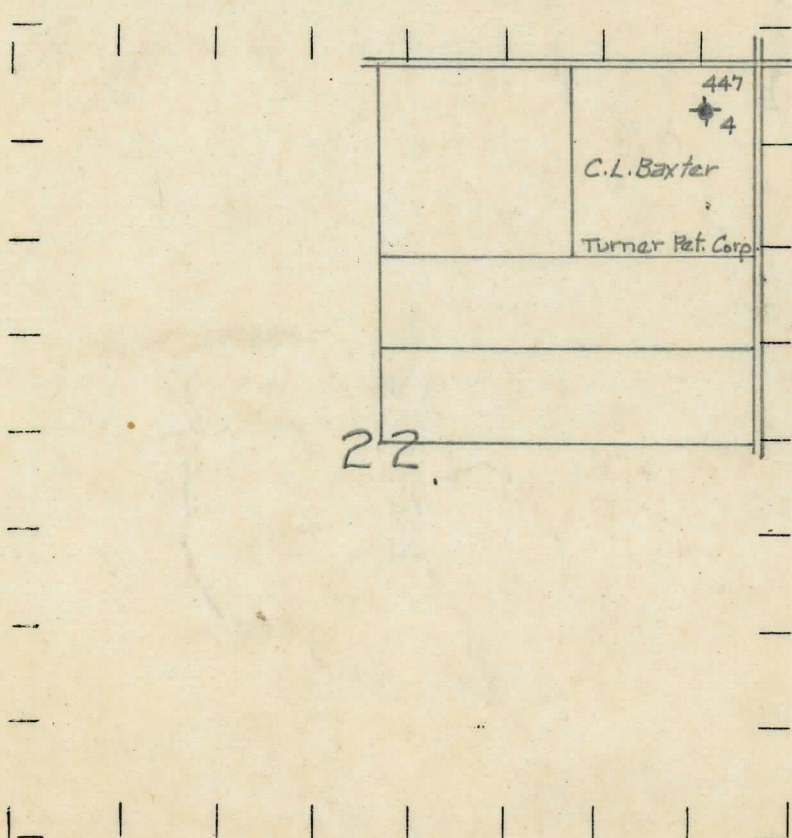

REMARKS:

SIGNED

R. A. Hagan
 Superintendent or Foreman.

No. 447

SUPT. OR FOREMAN

DESCRIPTION	QUANTITY	MAKE	SIZE	MATERIAL
-------------	----------	------	------	----------

DATE August 7, 1933 LOCATION REPORT No. 447

STATE Michigan COUNTY Midland DIST. Porter SEC. 22 TOWN 13N RANGE 1W

WELL No. 4 (SERIAL No. 447) FARM C. L. Baxter 40 ACRES

NAME OF STREAM OR WATERS _____ QUADRANGLE NE-NE-NE

OPERATOR Fred W. Turner MAP Porter Twp., Midland Co.

330 Feet from North Line of Farm

330 " " East " " "

" " South " " "

" " West " " "

330 Feet from North Line of Section

330 " " East " " "

" " South " " "

" " West " " "

LEGEND

- | | |
|------------------|----------------------|
| ○ LOCATION | ✧ DRY HOLE |
| ① RIG | ✦ DRY SHOWING OIL |
| ⊕ DRILLING | ✧ DRY SHOWING GAS |
| ⊗ GAS WELL | ⊗ ABANDONED LOCATION |
| ● OIL WELL | ✦ ABANDONED GAS WELL |
| ⬮ SMALL OIL WELL | ⬮ ABANDONED OIL WELL |

NOTE: Below make tracing from map, (when no map is obtainable make sketch) showing farm, center of section, this location with measurements and also wells, dry holes, or other locations in the vicinity of this location. Make copy to keep for reference and send original to Columbus office.

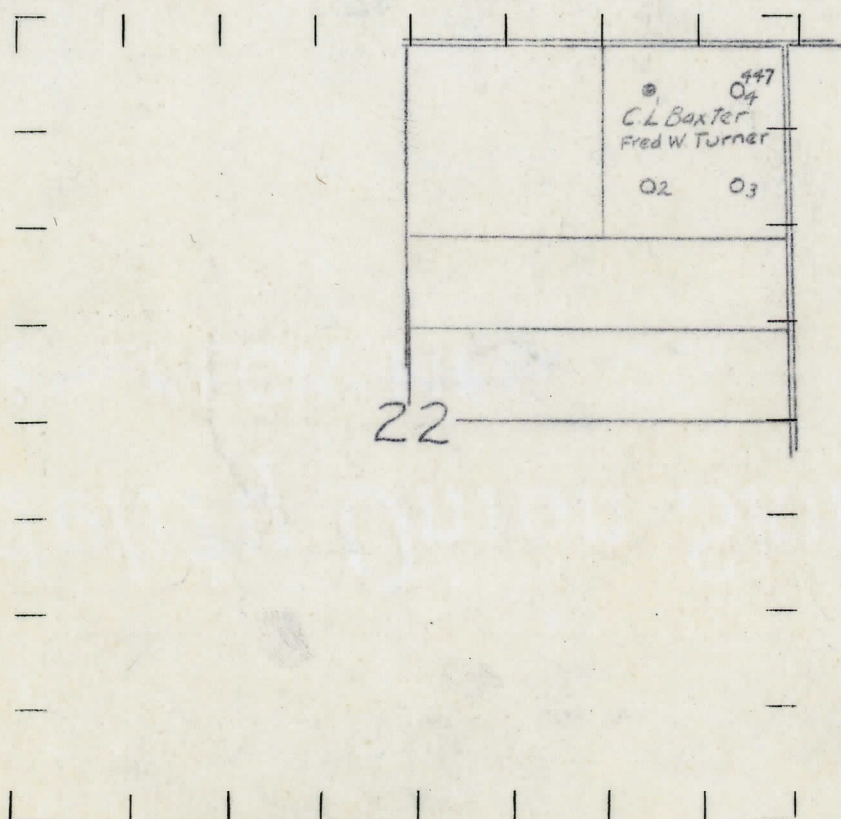

REMARKS:

SIGNED

R. A. Yeager
Superintendent or Foreman.