



Western Michigan University
ScholarWorks at WMU

Legacy Scout Tickets from Pure Oil Company

8-20-2021

MGRRE_PureOilScoutTickets_Campbell, Dr. J.
W._3_21111016230000

MGRRE
Western Michigan University

Follow this and additional works at: <https://scholarworks.wmich.edu/pure>



Part of the Geology Commons

WMU ScholarWorks Citation

MGRRE, "MGRRE_PureOilScoutTickets_Campbell, Dr. J. W._3_21111016230000" (2021). *Legacy Scout Tickets from Pure Oil Company*. 5424.
<https://scholarworks.wmich.edu/pure/5424>

This Document is brought to you for free and open access via ScholarWorks at WMU. It has been accepted for inclusion in Legacy Scout Tickets from Pure Oil Company by an authorized administrator of ScholarWorks at WMU. See the National Digital Catalogue - Science Base Catalogue for more collections submitted by MGRRE.



MGRRE_PureOilScoutTickets_Campbell, Dr. J. W._3_21111016230000

API 21111016230000

Permit Number 1623

Lease Name Campbell, Dr. J. W.

Well Number 3

County Midland

Township 13N

Range 01W

Section 17

2021 DEQ or Pure co_name Basin Oil Company

Pure Number 454

Latitude 43.5181

Longitude -84.45882

THE PURE OIL COMPANY

DATE 2-2-38

LOCATION REPORT

No. 454STATE Michigan COUNTY MidlandDIST. PorterTWP. PorterSEC. 17TOWN 13-NRANGE 1-WWELL No. 3 (SERIAL No. 454) FARMPREC. J. W. Campbell

ACRES

NAME OF STREAM OR WATERS

QUADRANGLE SW-SW-NE
SW-SW-NEOPERATOR Roosevelt Oil Co.Map Porter Twp., Midland Co.

Feet from North Line of Farm

" " East " " "

" " South " " "

" " West " " "

Feet from North Line of Section

" " East " " "

" " South " " "

" " West " " "

LEGEND

○ LOCATION

⊙ RIG

⊕ DRILLING

☀ GAS WELL

● OIL WELL

⬮ SMALL OIL WELL

⊙ DRY HOLE

⬮ DRY SHOWING OIL

⊙ DRY SHOWING GAS

⊙ ABANDONED LOCATION

☀ ABANDONED GAS WELL

⬮ ABANDONED OIL WELL

NOTE: Below make tracing from map, (when no map is obtainable make sketch) showing farm, center of section, this location with measurements and also wells, dry holes, or other locations in the vicinity of this location.

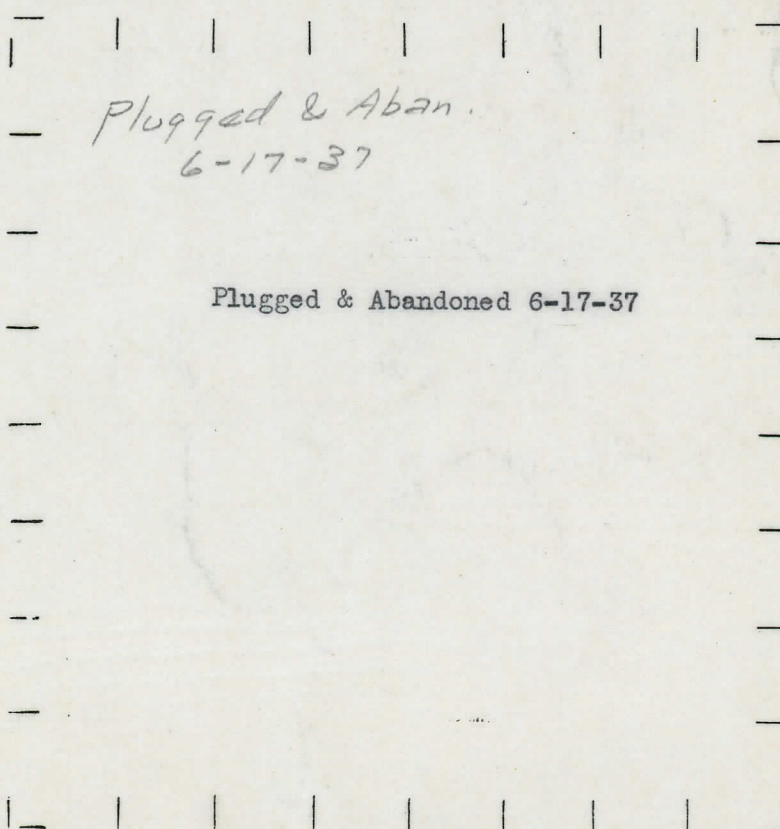

REMARKS:

SIGNED

R. L. Yague.
Superintendent or Foreman.

DYLE 8-8-88

LOCATION REPORT

No. 454

DATE 8-11-33

LOCATION REPORT

No. 454

STATE Michigan COUNTY Midland DIST. Porter SEC. 17 TOWN 13N RANGE 1W
 WELL No. 3 (SERIAL No. 454) FARM J. W. Campbell ACRES

NAME OF STREAM OR WATERS QUADRANGLE SW-SW-NE

OPERATOR Theodore Oil Co. MAP

Feet from North Line of Farm

270 " " East " " "

330 " " South " " "

" " West " " "

Feet from North Line of Section

" " East " " "

330 " " South " " $\frac{1}{2}$ "100 " " West " " $\frac{1}{2}$ "

LEGEND

O LOCATION

① RIG

⊕ DRILLING

⊗ GAS WELL

● OIL WELL

⊙ SMALL OIL WELL

⊕ DRY HOLE

⊕ DRY SHOWING OIL

⊕ DRY SHOWING GAS

⊕ ABANDONED LOCATION

⊕ ABANDONED GAS WELL

⊕ ABANDONED OIL WELL

NOTE: Below make tracing from map, (when no map is obtainable make sketch) showing farm, center of section, this location with measurements and also wells, dry holes, or other locations in the vicinity of this location. Make copy to keep for reference and send original to Columbus office.

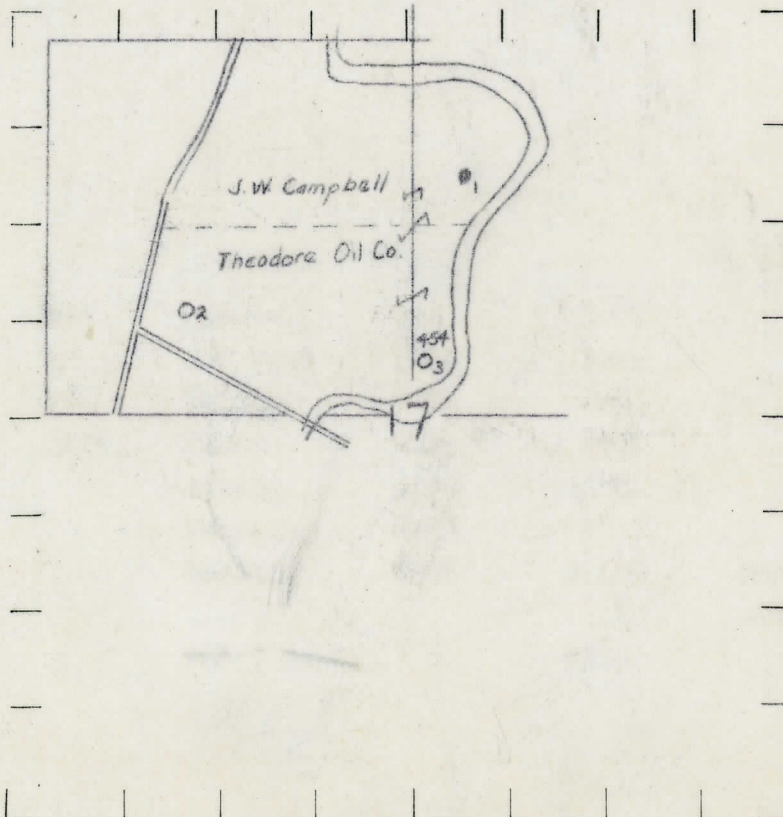

REMARKS:

SIGNED

R. Y. Yeager
 Superintendent or Foreman.

THE PURE OIL COMPANY

Michigan Producing DIVISION
COMPLETION RECORD

DATE 11/24/33

No. 454

STATE Michigan COUNTY Midland DIST. TWP. Porter SEC. 17 TOWN 13 N RANGE 1 W

WELL No. 3 (SERIAL No. 454) FARM J. W. Campbell ACRES _____

NAME OF STREAM OR WATERS _____ QUADRANGLE SW-SW-NE

OPERATOR Theodore Oil Co. MAP Porter Township, Midland County

LOCATION REPORT SENT IN (DATE) 8/11/33

WELL STARTED (DATE) 8/17/33 WELL COMPLETED (DATE) 11/18/33

OIL WELL

~~WATER WELL~~

~~GEOTHERMAL WELL~~

~~WATER WELL~~

Elevation 663.3'

CROSS OUT THREE OF THE ABOVE
WELL RECORD

DATE OF SHOT _____ NUMBER OF QUARTS _____

1st 24 HOURS PRODUCTION 7085 Bbls. Potential BARRELS OR FEET

2nd " " " " " "

3rd " " " " " "

4th " " " " " "

5th " " " " " "

SAND AND CASING

CASING SIZE	WEIGHT	CASING Feet Inches	SAND Name and Nature	TOP	BOTTOM	TOP PAY	BOTTOM PAY	SALT WATER
10"		280	Marshall	995	1175			
8 1/2"		727	Red Rock	1175	1245			
6-5/8"		1260	Sunbury	2265	2295			
5-3/16"		3368	Berea	2295	2340			
			Antrim	2405	2800			
			Traverse	2800				
			Dundee	3366	S.L.M.	3384	3385	
						3388	3389	
			Total Depth		3389			

REMARKS