



Western Michigan University
ScholarWorks at WMU

Legacy Scout Tickets from Pure Oil Company

8-20-2021

MGRRE_PureOilScoutTickets_Bernard, A._1_21111016650000

MGRRE

Western Michigan University

Follow this and additional works at: <https://scholarworks.wmich.edu/pure>



Part of the Geology Commons

WMU ScholarWorks Citation

MGRRE, "MGRRE_PureOilScoutTickets_Bernard, A._1_21111016650000" (2021). *Legacy Scout Tickets from Pure Oil Company*. 5432.

<https://scholarworks.wmich.edu/pure/5432>

This Document is brought to you for free and open access via ScholarWorks at WMU. It has been accepted for inclusion in Legacy Scout Tickets from Pure Oil Company by an authorized administrator of ScholarWorks at WMU. See the National Digital Catalogue - Science Base Catalogue for more collections submitted by MGRRE.



MGRRE_PureOilScoutTickets_Bernard, A._1_21111016650000

API 21111016650000

Permit Number 1665

Lease Name Bernard, A.

Well Number 1

County Midland

Township 14N

Range 02W

Section 8

2021 DEQ or Pure co_name Midway Tool Company

Pure Number 468

Latitude 43.61408

Longitude -84.56956

THE PURE OIL COMPANY

Date January 31, 1944 Corrected LOCATION REPORT A.F.E. No. _____Division Mich. Producing District _____ Lease A. BernardAcres _____ Lease No. _____ Elevation _____ Well No. 1 (Serial No. 468)Quadrangle N¹/₂ SE SE Sec. 8 Twp. 14 N Rge. 2 W Twp. GreendaleSurvey _____ County Midland State MichiganOperator Midway Tool Company Map Greendale Township, Michigan, Midland County

Feet from North Line of Lease

" " East " " "

" " South " " "

" " West " " "

Feet from North Line of Section

" " East " " "

" " South " " "

" " West " " "

LEGEND

○ Location



Gas Well



Oil Well



Gas - Distillate Well



Dry Hole



Dry Showing Oil



Dry Showing Gas



Abandoned Location

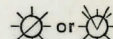

Abandoned Gas Well

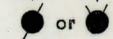

Abandoned Oil Well

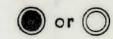

Input Well

See plat - Midland #468.

Remarks: Change of operator. Scale _____Submitted by Scouting Dept. Approved by _____ Division Manager

Approved by _____ Vice-President - General Manager

Division Mich. Producing District _____ Lease A. Bernard

Date January 4, 1944 **LOCATION REPORT** V.E.E. No. _____
A.F.E. No. _____

Division Mich. Producing District _____ Lease A. Bernard

Acres _____ Lease No. _____ Elevation _____ Well No. 1 (Serial No. 468)

Quadrangle NE SE SE Sec. 8 Twp. 14 N Rge. 2 W Greendale

Survey _____ County Midland State Michigan

Operator Branigar, Giffert & Reasor Map Greendale Township, Midland County

____ Feet from North Line of Lease
 " " East " " "
 " " South " " "
 " " West " " "
 ____ Feet from North Line of Section
 " " East " " "
 " " South " " "
 " " West " " "

LEGEND

○ Location



Gas Well



Oil Well



Gas-Distillate Well



Dry Hole



Dry Showing Oil



Dry Showing Gas



Abandoned Location

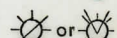

Abandoned Gas Well

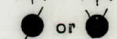

Abandoned Oil Well

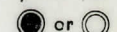

Input Well

N

Plugged and abandoned 11-23-43.

Total Depth 3584'.

Remarks: _____ Scale _____

Submitted by _____ Civil Engineer Approved by _____ Division Manager

Approved by _____ Vice-President - General Manager

Division _____ District _____ Section _____ Township _____ Range _____
Date _____ Location Report _____
STATE Michigan COUNTY Midland DIST. Greendale SEC. 8 TOWN 14N RANGE 2W
WELL No. 1 (SERIAL No. 468) FARM A. Bernard ACRES _____
NAME OF STREAM OR WATERS _____ QUADRANGLE NE-SE-SE
OPERATOR Branigar, Giffert & Reesor MAP Greendale Twp., Midland Co.

330 Feet from North Line of Farm
330 " " East " " "
" " South " " "
" " West " " "
Feet from North Line of Section
330 " " East " " "
990 " " South " " "
" " West " " "

LEGEND

- | | |
|------------------|----------------------|
| ○ LOCATION | ⊕ DRY HOLE |
| ① RIG | ⊕ DRY SHOWING OIL |
| ⊕ DRILLING | ⊕ DRY SHOWING GAS |
| ⊕ GAS WELL | ⊕ ABANDONED LOCATION |
| ● OIL WELL | ⊕ ABANDONED GAS WELL |
| ⊕ SMALL OIL WELL | ⊕ ABANDONED OIL WELL |

NOTE: Below make tracing from map, (when no map is obtainable make sketch) showing farm, center of section, this location with measurements and also wells, dry holes, or other locations in the vicinity of this location. Make copy to keep for reference and send original to Columbus office.

11-23-43

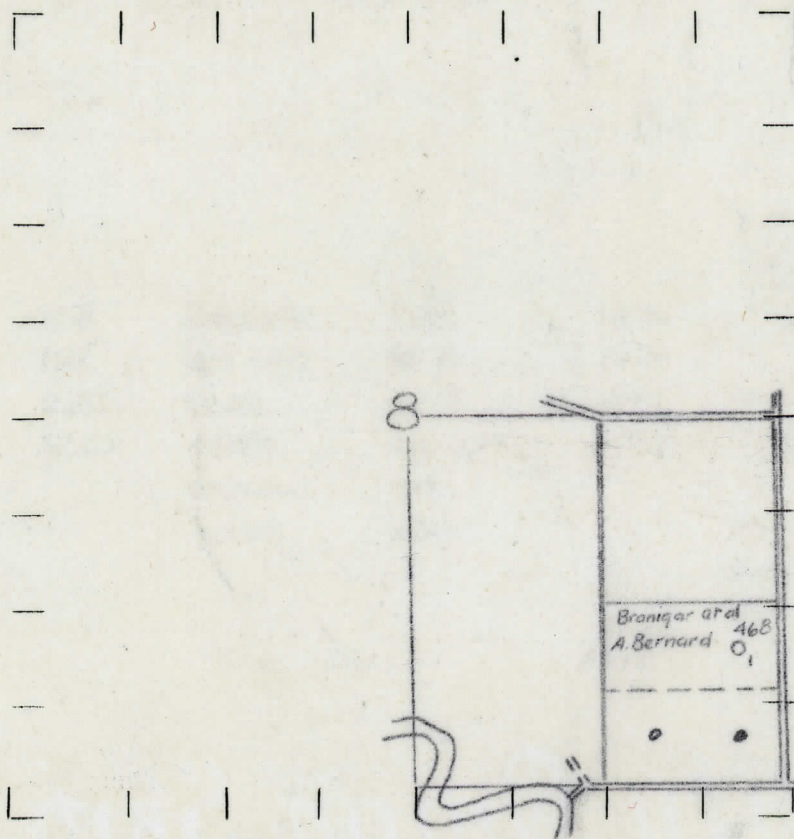

REMARKS:

SIGNED

R. L. Yeager
Superintendent or Foreman.

DATE 11-24-33

LOCATION RECORD
THE PURE OIL COMPANY

No. 468

Michigan Producing DIVISION
COMPLETION RECORD

No. 468

STATE Michigan COUNTY Midland DIST. TWP. Greendale SEC. 8 TOWN 14 N RANGE 2 W

WELL No. 1 (SERIAL No. 468) FARM A. Bernard ACRES

NAME OF STREAM OR WATERS QUADRANGLE NE-SE-SE

OPERATOR Branigar, Giffert & Reasor MAP Greendale Township, Midland County

LOCATION REPORT SENT IN (DATE) 8/17/33

WELL STARTED (DATE) 8/27/33 WELL COMPLETED (DATE) 11/8/33

OIL WELL

WATER WELL

GAS WELL

ABANDONED WELL

Elevation 695.7'

CROSS OUT THREE OF THE ABOVE
WELL RECORD

DATE OF SHOT NUMBER OF QUARTS

1st 24 HOURS PRODUCTION Est. 150 bbls. natural BARRELS OR FEET

1st 15 " 306 " after acid " " "

3rd " " " " " "

4th " " " " " "

5th " " " " " "

SAND AND CASING

CASING SIZE	WEIGHT	CASING Feet Inches	SAND Name and Nature	TOP	BOTTOM	TOP PAY	BOTTOM PAY	SALT WATER
10"		327	Marshall	1142	1285			
8 1/2"		885	Red Rock	1285	1365			
6-5/8"		1422	Berea	2402	2427			
5-3/16		3524	Antrim	2475	2894			
			Traverse	2894				
			Dundee	3512		3527	3531	
						3534	3540	
						3547	3551	
			Total Depth		3584			

REMARKS

NOTE:—MAKE COPY TO KEEP FOR REFERENCE AND SEND ORIGINAL TO CHICAGO
OFFICE. LIST MATERIAL CHARGEABLE TO WELL ON OTHER SIDE.

SIGNED

G. H. B. ell

SUPT. OR FOREMAN