



Western Michigan University  
ScholarWorks at WMU

---

Legacy Scout Tickets from Pure Oil Company

---

8-20-2021

**MGRRE\_PureOilScoutTickets\_Atha, W.  
Hunter\_1\_21111016990000**

MGRRE  
*Western Michigan University*

Follow this and additional works at: <https://scholarworks.wmich.edu/pure>



Part of the Geology Commons

---

#### WMU ScholarWorks Citation

MGRRE, "MGRRE\_PureOilScoutTickets\_Atha, W. Hunter\_1\_21111016990000" (2021). *Legacy Scout Tickets from Pure Oil Company*. 5448.  
<https://scholarworks.wmich.edu/pure/5448>

This Document is brought to you for free and open access via ScholarWorks at WMU. It has been accepted for inclusion in Legacy Scout Tickets from Pure Oil Company by an authorized administrator of ScholarWorks at WMU. See the National Digital Catalogue - Science Base Catalogue for more collections submitted by MGRRE.



---

**MGRRE\_PureOilScoutTickets\_Atha, W. Hunter\_1\_21111016990000**

API 21111016990000

Permit Number 1699

Lease Name Atha, W. Hunter

Well Number 1

County Midland

Township 14N

Range 01W

Section 8

2021 DEQ or Pure co\_name Oryx Energy Company

Pure Number 495

Latitude 43.61763

Longitude -84.4677

SERIAL NO. 495

LOC. \_\_\_\_\_

STATUS \_\_\_\_\_

NORTH

A blank sheet of graph paper featuring a grid of squares. The grid is composed of solid black lines forming the outer boundaries and dashed black lines forming internal divisions. The paper is cream-colored and shows signs of aging, such as slight discoloration and small brown spots. The grid covers most of the page, leaving narrow margins at the top and bottom.

FORM 216-F 500 BKS. BKS. OF 100 6-25-47

THE PURE OIL COMPANY

DATE August 30, 1933

## LOCATION REPORT

No.

STATE Michigan COUNTY Midland DIST. Lee SEC. 20 TOWN 14 N. RANGE 1 W.

WELL No. 1 (SERIAL No. 495) FARM W. Hunter Atha ACRES

NAME OF STREAM OR WATERS----- QUADRANGLE NW-NW-SW-----

OPERATOR W. Hunter Atha MAP Lee Sup - Midland Co  
W. Hunter Atha Lee Township, Midland County

330  
----- 330 ----- Feet from North Line of Farm

----- " " East " " "

----- " " South " " "

330 " " West " " "

Feet from North Line of Section

----- " " **East** " " "

2310 " " South " " "

330 " " West " " "

## LEGEND

### ○ LOCATION

① RIG

## ④ DRILLING

## GAS WELL

## ● OIL WELL

### ● SMALL OIL WELL

 **DRY HOLE**

## • DRY SHOWING OIL

## DRY SHOWING GAS

**ABANDONED LOCATION**

### ABANDONED GAS WELL

**ABANDONED OIL WELL**

NOTE: Below make tracing from map, (when no map is obtainable make sketch) showing farm, center of section, this location with measurements and also wells, dry holes, or other locations in the vicinity of this location. Make copy to keep for reference and send original to Columbus office.

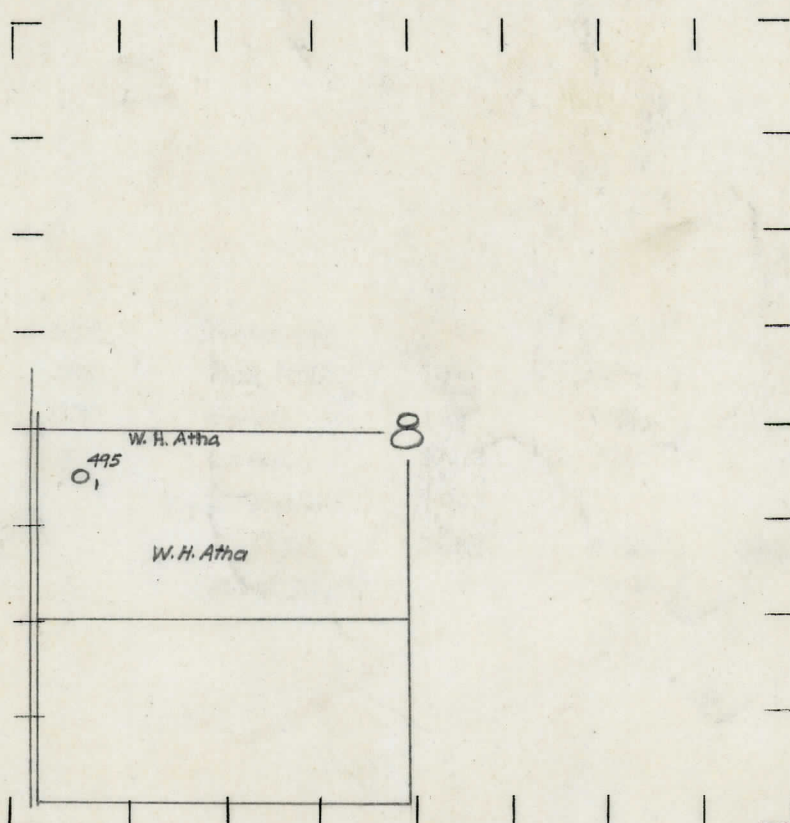

REMARKS:

SIGNED

-----  
Superintendent or Foreman.



THE PURE OIL COMPANY

Michigan Producing DIVISION

DATE 11/24/33

COMPLETION RECORD

No. 495

STATE Michigan COUNTY Midland DIST. TWP. Lee SEC. 8 TOWN 14 N RANGE 1 W

WELL No. 1 (SERIAL No. 495) FARM W. Hunter Atha ACRES

NAME OF STREAM OR WATERS QUADRANGLE NW-NW-SW

OPERATOR W. Hunter Atha MAP Lee Township, Midland County

LOCATION REPORT SENT IN (DATE) 8/30/33

WELL STARTED (DATE) 9/15/33 WELL COMPLETED (DATE) 11/3/33

OIL WELL CROSS OUT THREE OF THE ABOVE

Elevation 664.9'

WELL RECORD

DATE OF SHOT NUMBER OF QUARTS

1st 24 HOURS PRODUCTION 150 bbls. natural BARRELS OR FEET

SAND AND CASING

CASING SIZE	WEIGHT	CASING Feet Inches	SAND Name and Nature	TOP	BOTTOM	TOP PAY	BOTTOM PAY	SALT WATER
10"		307	Marshall	1199	1290			
8 1/4"		880	Red Rock	1290	1356			
6-5/8"		1379	Berea	2376	2396			
5-3/16"		3291	Antrim	2570	2898			
			Traverse	2898				
			Dundee	3522	S. L. M.	3549	3550	
			Total Depth		3550			

REMARKS