



Western Michigan University
ScholarWorks at WMU

Legacy Scout Tickets from Pure Oil Company

8-20-2021

**MGRRE_PureOilScoutTickets_Baxter, Charles
E._4_21111018400000**

MGRRE
Western Michigan University

Follow this and additional works at: <https://scholarworks.wmich.edu/pure>



Part of the Geology Commons

WMU ScholarWorks Citation

MGRRE, "MGRRE_PureOilScoutTickets_Baxter, Charles E._4_21111018400000" (2021). *Legacy Scout Tickets from Pure Oil Company*. 5492.
<https://scholarworks.wmich.edu/pure/5492>

This Document is brought to you for free and open access via ScholarWorks at WMU. It has been accepted for inclusion in Legacy Scout Tickets from Pure Oil Company by an authorized administrator of ScholarWorks at WMU. See the National Digital Catalogue - Science Base Catalogue for more collections submitted by MGRRE.



MGRRE_PureOilScoutTickets_Baxter, Charles E._4_21111018400000

API 21111018400000

Permit Number 1840

Lease Name Baxter, Charles E.

Well Number 4

County Midland

Township 13N

Range 01W

Section 22

2021 DEQ or Pure co_name Stork Oil Company

Pure Number 554

Latitude 43.50889

Longitude -84.41829

THE PURE OIL COMPANY
LOCATION REPORT

No. 554

DATE Dec. 22, 1933
Date August 25, 1944

A.F.E. No. _____

Division Mich. Producing District _____ Lease C. E. Baxter

Acres _____ Lease No. _____ Elevation _____ Well No. 4 (Serial No. 554)

Quadrangle NW NW NE Sec. 22 Twp. 13 N Rge. 1 W Twp. Porter

Survey _____ County Midland State Michigan

Operator Stork Oil Company Map Porter Township, Midland County

Feet from North Line of Lease

" " East " " "

" " South " " "

" " West " " "

Feet from North Line of Section

" " East " " "

" " South " " "

" " West " " "

LEGEND

○ Location



Gas Well



Oil Well



Gas - Distillate Well



Dry Hole



Dry Showing Oil



Dry Showing Gas



Abandoned Location

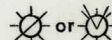

Abandoned Gas Well

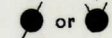

Abandoned Oil Well

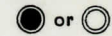

Input Well

Plugged and abandoned 7-20-44.

Total Depth 3405'.

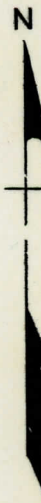

Scale _____

Remarks: _____

Submitted by _____ Civil Engineer

Approved by _____ Division Manager

Approved by _____ Vice-President - General Manager

STATE Michigan COUNTY Midland DIST. Porter SEC. 22 TOWN 13 N RANGE 1 W
WELL No. 4 (SERIAL No. 554) FARM C. E. Baxter ACRES
NAME OF STREAM OR WATERS QUADRANGLE NW-NW-NE
OPERATOR Stork Oil Co. MAP Porter Township, Midland County

330 Feet from North Line of Farm
" " East " " "
" " South " " "
330 " " West " " "
330 Feet from North Line of Section
2310 " " East " " "
" " South " " "
" " West " " "

LEGEND

- | | |
|------------------|----------------------|
| ○ LOCATION | ✦ DRY HOLE |
| ① RIG | ✦ DRY SHOWING OIL |
| ⊕ DRILLING | ✦ DRY SHOWING GAS |
| ⊗ GAS WELL | ⊗ ABANDONED LOCATION |
| ● OIL WELL | ⊗ ABANDONED GAS WELL |
| ⬮ SMALL OIL WELL | ⬮ ABANDONED OIL WELL |

NOTE: Below make tracing from map, (when no map is obtainable make sketch) showing farm, center of section, this location with measurements and also wells, dry holes, or other locations in the vicinity of this location. Make copy to keep for reference and send original to Columbus office.

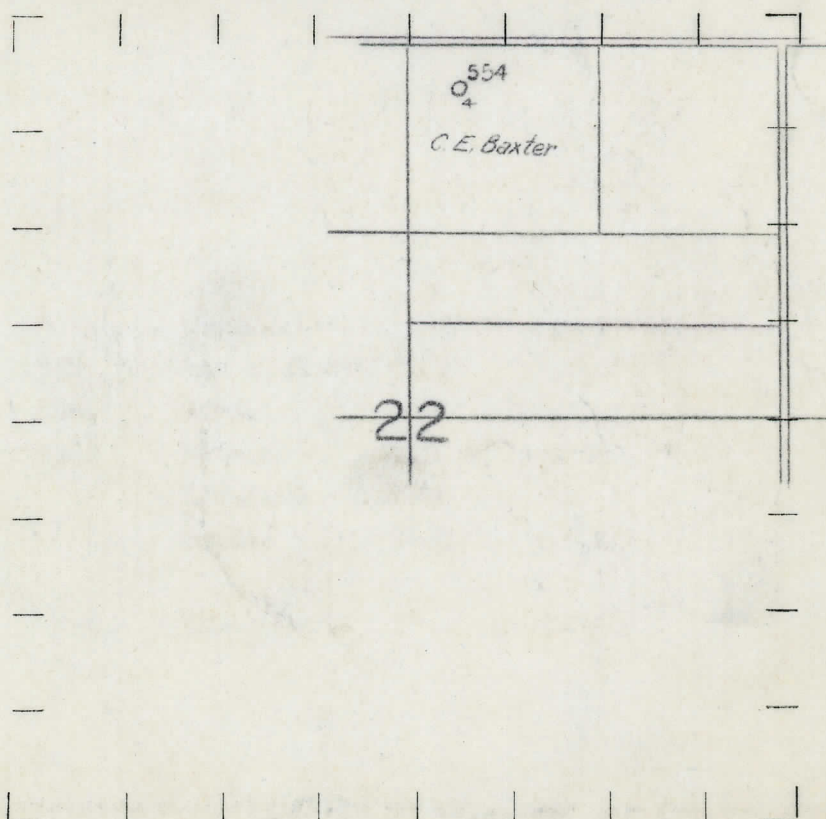

REMARKS:

SIGNED

R. A. Wenger
Superintendent or Foreman.

THE PURE OIL COMPANY

Michigan Producing DIVISION

COMPLETION RECORD

No. 554

STATE Michigan COUNTY Midland DIST. Porter TWP. 22 SEC. 13 RANGE 1 W. PREC. 1

WELL No. 4 (SERIAL No. 554) FARM C. E. Baxter ACRES

NAME OF STREAM OR WATERS _____ QUADRANGLE NW. NW. NE

OPERATOR Stork Oil Company MAP Porter Township, Midland County

LOCATION REPORT SENT IN (DATE) 12/22/33

WELL STARTED (DATE) 1/9/34 WELL COMPLETED (DATE) 3/28/34

OIL WELL

紅粉、白粉、綠粉、紫粉

INDEX-CONT.

TABLE 1. (continued)

Elevation 680.3'

CROSS OUT THREE OF THE ABOVE
WELL RECORD

DATE OF SHOT _____ NUMBER OF QUARTS _____

1st 24 HOURS PRODUCTION	280 bbls. Potential, natural	BARRELS OR FEET
-------------------------	------------------------------	-----------------

[illegible]

3rd

[illegible]

5th " " " " " " " " " " " "

SAND AND CASING

[illegible]

REMARKS Flowed from Traverse approximately 50 bbls. per day for two weeks.