



Western Michigan University
ScholarWorks at WMU

Legacy Scout Tickets from Pure Oil Company

8-20-2021

**MGRRE_PureOilScoutTickets_Breu, Norman &
Cecile_2_21111018550000**

MGRRE
Western Michigan University

Follow this and additional works at: <https://scholarworks.wmich.edu/pure>



Part of the Geology Commons

WMU ScholarWorks Citation

MGRRE, "MGRRE_PureOilScoutTickets_Breu, Norman & Cecile_2_21111018550000" (2021). *Legacy Scout Tickets from Pure Oil Company*. 5494.
<https://scholarworks.wmich.edu/pure/5494>

This Document is brought to you for free and open access via ScholarWorks at WMU. It has been accepted for inclusion in Legacy Scout Tickets from Pure Oil Company by an authorized administrator of ScholarWorks at WMU. See the National Digital Catalogue - Science Base Catalogue for more collections submitted by MGRRE.



MGRRE_PureOilScoutTickets_Breu, Norman & Cecile_2_21111018550000

API 21111018550000

Permit Number 1855

Lease Name Breu, Norman & Cecile

Well Number 2

County Midland

Township 13N

Range 01W

Section 20

2021 DEQ or Pure co_name McClanahan Oil Company

Pure Number 558

Latitude 43.50346

Longitude -84.45066

THE PURE OIL COMPANY

DATE 2-2-38

LOCATION REPORT

No. 558

STATE Michigan COUNTY Midland DIST. Porter TWP. Porter SEC. 20 TOWN 13-N RANGE 1-W

WELL No. 2 (SERIAL No. 558) FARM Norman & Cecil Breu ACRES

NAME OF STREAM OR WATERS QUADRANGLE SE-SE-NE

OPERATOR McClanahan Oil Co. Map Porter Twp., Midland Co.

Feet from North Line of Farm

" " East " " "
" " South " " "
" " West " " "

Feet from North Line of Section

" " East " " "
" " South " " "
" " West " " "

LEGEND

○ LOCATION

⊙ RIG

⊕ DRILLING

⊗ GAS WELL

● OIL WELL

⦿ SMALL OIL WELL

⊖ DRY HOLE

⦿ DRY SHOWING OIL

⦿ DRY SHOWING GAS

⦿ ABANDONED LOCATION

⦿ ABANDONED GAS WELL

⦿ ABANDONED OIL WELL

NOTE: Below make tracing from map, (when no map is obtainable make sketch) showing farm, center of section, this location with measurements and also wells, dry holes, or other locations in the vicinity of this location.

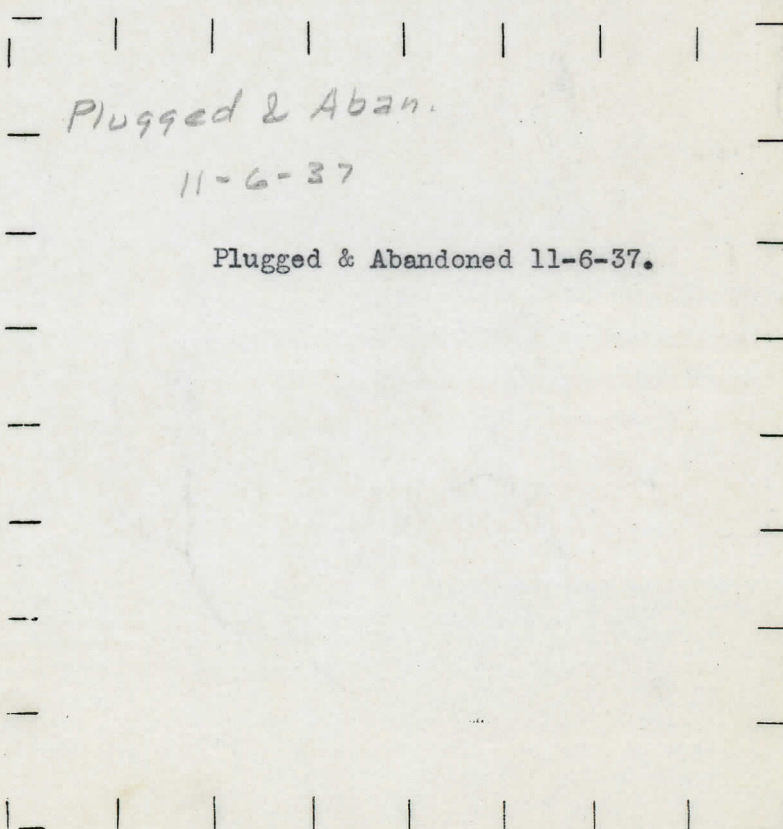

REMARKS:

SIGNED

R. L. Yeager
Superintendent or Foreman.

DATE January 4, 1934

LOCATION REPORT

No. 338

STATE Michigan COUNTY Midland DIST. Porter SEC 20 TOWN 13 N RANGE 1 W
 WELL No. 2 (SERIAL No. 558) FARM Norman & Cecile Breu ACRES
 NAME OF STREAM OR WATERS QUADRANGLE SE-SE-NE
 OPERATOR McClanahan Oil Company MAP Porter Township, Midland County

Feet from North Line of Farm

330 " " East " " "

330 " " South " " "

" " West " " "

2310 Feet from North Line of Section

330 " " East " " "

" " South " " "

" " West " " "

LEGEND

- O LOCATION
- ① RIG
- ⊕ DRILLING
- ⊗ GAS WELL
- OIL WELL
- ⬮ SMALL OIL WELL
- ⬮ DRY HOLE
- ⬮ DRY SHOWING OIL
- ⬮ DRY SHOWING GAS
- ⬮ ABANDONED LOCATION
- ⬮ ABANDONED GAS WELL
- ⬮ ABANDONED OIL WELL

NOTE: Below make tracing from map, (when no map is obtainable make sketch) showing farm, center of section, this location with measurements and also wells, dry holes, or other locations in the vicinity of this location. Make copy to keep for reference and send original to Columbus office.

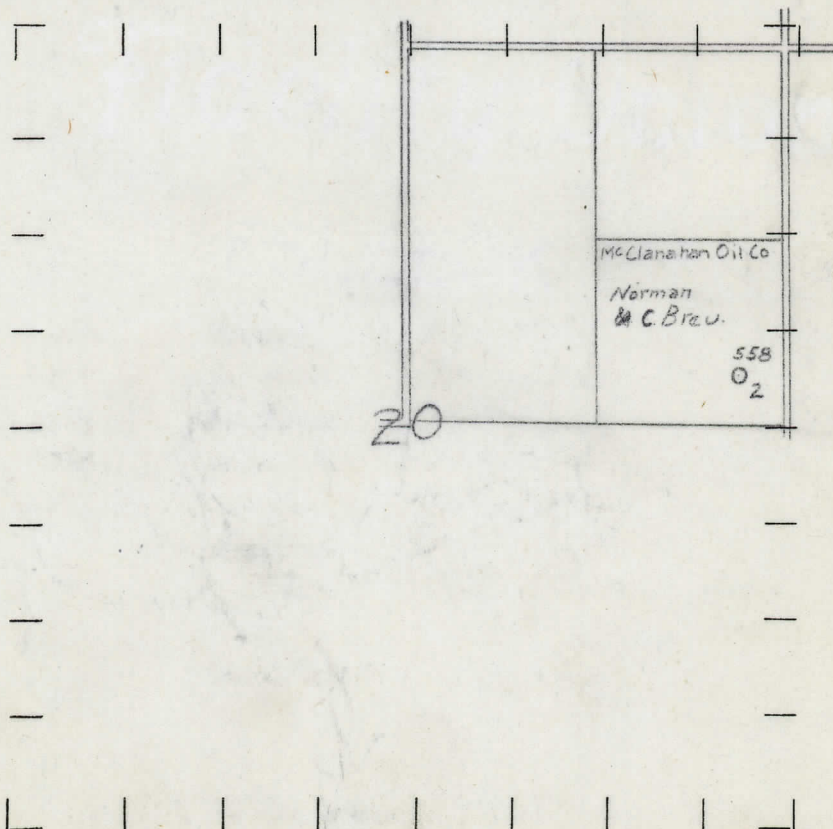

REMARKS:

SIGNED

R. L. Yeager
 Superintendent or Foreman.

Permit No. 1255

DATE 4/12/34 **COMPLETION RECORD** No. 558

STATE Michigan COUNTY Midland DIST. TWP. Porter SEC. 20 TOWN 13 N RANGE 1 W

WELL No. 2 (SERIAL No. 558) FARM Norman & Cecile Breu ACRES 40

NAME OF STREAM OR WATERS _____ QUADRANGLE SE-SE-NE

OPERATOR McClanahan Oil Company MAP Porter Township, Midland County

LOCATION REPORT SENT IN (DATE) 1/4/34

WELL STARTED (DATE) 2/4/34 WELL COMPLETED (DATE) 4/7/34

OIL WELL	GAS WELL	DRY HOLE	WATER POWERED WHEEL
----------	----------	----------	---------------------

Elevation 689.4' CROSS OUT THREE OF THE ABOVE
WELL RECORD

DATE OF SHOT _____ NUMBER OF QUARTS _____

1st 24 HOURS PRODUCTION	<u>4762 bbls., Potential</u>	BARRELS OR FEET
2nd " " "		" " "
3rd " " "		" " "
4th " " "		" " "
5th " " "		" " "

SAND AND CASING

CASING SIZE	WEIGHT	CASING Feet Inches	SAND Name and Nature	TOP	BOTTOM	TOP PAY	BOTTOM PAY	SALT WATER
10"		269	Stray	1035				
8 1/4"		810	Marshall	1080	1195			
6-5/8		1285	Red Rock	1195	1270			
5-3/16		3388	Berea	2305	2355			
			Antrim	2410	2785			
			Traverse	2785				
			Dundee	3386	S.L.M.	3413	3418	
						3425	3430	
			Total Depth		3430			

REMARKS Large increase in Oil & Gas at 3430'

Potential Test 4/9/34 - Flowed 232 bbls. in one hour.

Showing no water when completed.