



Western Michigan University
ScholarWorks at WMU

Legacy Scout Tickets from Pure Oil Company

8-20-2021

MGRRE_PureOilScoutTickets_Campbell_5_21111019250000

MGRRE

Western Michigan University

Follow this and additional works at: <https://scholarworks.wmich.edu/pure>



Part of the Geology Commons

WMU ScholarWorks Citation

MGRRE, "MGRRE_PureOilScoutTickets_Campbell_5_21111019250000" (2021). *Legacy Scout Tickets from Pure Oil Company*. 5517.

<https://scholarworks.wmich.edu/pure/5517>

This Document is brought to you for free and open access via ScholarWorks at WMU. It has been accepted for inclusion in Legacy Scout Tickets from Pure Oil Company by an authorized administrator of ScholarWorks at WMU. See the National Digital Catalogue - Science Base Catalogue for more collections submitted by MGRRE.



MGRRE_PureOilScoutTickets_Campbell_5_21111019250000

API 21111019250000

Permit Number 1925

Lease Name Campbell

Well Number 5

County Midland

Township 13N

Range 01W

Section 17

2021 DEQ or Pure co_name Roosevelt Oil Company

Pure Number 604

Latitude 43.51943

Longitude -84.46309

THE PURE OIL COMPANY

DATE February 15, 1936

LOCATION REPORT

No. 604STATE MichiganCOUNTY MidlandMidlandDIST. PorterTWP. PorterSEC. 17TOWN 13 N.13 N.RANGE 1 W.WELL No. 55 (SERIAL No. 604) FARMPREC. J. W. Campbell

ACRES

NAME OF STREAM OR WATERS

QUADRANGLE

SW-SE-NW
SW SE NWOPERATOR Theodore Oil Company

Map

Porter Township, Midland CountyTheodore Oil Co.Porter Twp - Midland Co.

Feet from North Line of Farm

" " East " " "

" " South " " "

" " West " " "

Feet from North Line of Section

" " East " " "

" " South " " "

" " West " " "

LEGEND

○ LOCATION

① RIG

⊕ DRILLING

☼ GAS WELL

● OIL WELL

⬮ SMALL OIL WELL

⊙ DRY HOLE

⬮ DRY SHOWING OIL

⊙ DRY SHOWING GAS

⊙ ABANDONED LOCATION

☼ ABANDONED GAS WELL

⬮ ABANDONED OIL WELL

NOTE: Below make tracing from map, (when no map is obtainable make sketch) showing farm, center of section, this location with measurements and also wells, dry holes, or other locations in the vicinity of this location.

Plugged + Aban.
11-23-35

Plugged and abandoned 11-23-35

N

REMARKS:

SIGNED

R. L. Ferguson
Superintendent or Foreman.

STATE Michigan COUNTY Midland DIST. Porter SEC. 17 TOWN 13 N RANGE 1 W
DATE March 16, 1934 LOCATION REPORT No. 604
WELL No. 5 (SERIAL No. 604) FARM J. W. Campbell ACRES
NAME OF STREAM OR WATERS QUADRANGLE NW-SE-NW
OPERATOR Theodore Oil Company MAP Porter Township, Midland County

2150 Feet from North Line of Farm
950 " " East " " "
" " South " " "
" " West " " "
2150 Feet from North Line of Section
1600 " " East " " "
" " South " " "
" " West " " "

LEGEND

- | | |
|------------------|----------------------|
| ○ LOCATION | ✦ DRY HOLE |
| ① RIG | ✦ DRY SHOWING OIL |
| ⊕ DRILLING | ✦ DRY SHOWING GAS |
| ⊗ GAS WELL | ✦ ABANDONED LOCATION |
| ● OIL WELL | ✦ ABANDONED GAS WELL |
| ⦿ SMALL OIL WELL | ✦ ABANDONED OIL WELL |

NOTE: Below make tracing from map, (when no map is obtainable make sketch) showing farm, center of section, this location with measurements and also wells, dry holes, or other locations in the vicinity of this location. Make copy to keep for reference and send original to Columbus office.

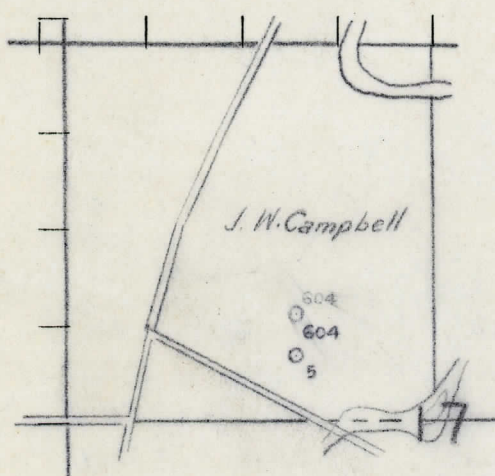

REMARKS:

SIGNED

Superintendent or Foreman.

THE PURE OIL COMPANY

Michigan Producing DIVISION
COMPLETION RECORD

No. 604

DATE May 17, 1934

STATE Michigan COUNTY Midland DIST. TWP. Porter SEC. 17 TOWN 13 N RANGE 1 W
PREC.

WELL No. 5 (SERIAL No. 604) FARM J. W. Campbell ACRES

NAME OF STREAM OR WATERS QUADRANGLE NW-SE-NW

OPERATOR Theodore Oil Company MAP Porter Township, Midland County

LOCATION REPORT SENT IN (DATE) 3/16/34

WELL STARTED (DATE) 3/16/34 WELL COMPLETED (DATE) 5/4/34

OIL WELL

GAS WELL

INTERMEDIATE

ABANDONED WELL

CROSS OUT THREE OF THE ABOVE

Elevation 676.8'

WELL RECORD

DATE OF SHOT NUMBER OF QUARTS
1st 24 HOURS PRODUCTION 786 bbls., Potential BARRELS OR FEET
2nd " " " " " "
3rd " " " " " "
4th " " " " " "
5th " " " " " "

SAND AND CASING

CASING SIZE	WEIGHT	CASING Feet Inches	SAND Name and Nature	TOP	BOTTOM	TOP PAY	BOTTOM PAY	SALT WATER
10"		368	Marshall	1053	1180			
8 1/4"		772	Red Rock	1180	1245			
6-5/8"		1285	Sunbury	2294	2304			
5-3/16"		3389	Berea	2304	2380			
			Antrim	2417	2800			
			Traverse	2800				
			Dundee	3387	S.L.M.	3400	3403	
						3414	3417	3414-3417
			Total Depth		3417			

REMARKS Tested 25 3/4% Salt Water when first completed.