



Western Michigan University  
ScholarWorks at WMU

---

Legacy Scout Tickets from Pure Oil Company

---

8-20-2021

**MGRRE\_PureOilScoutTickets\_Breckenridge State  
Bank\_1\_21111019970000**

MGRRE  
*Western Michigan University*

Follow this and additional works at: <https://scholarworks.wmich.edu/pure>



Part of the Geology Commons

---

#### WMU ScholarWorks Citation

MGRRE, "MGRRE\_PureOilScoutTickets\_Breckenridge State Bank\_1\_21111019970000" (2021). *Legacy Scout Tickets from Pure Oil Company*. 5537.  
<https://scholarworks.wmich.edu/pure/5537>

This Document is brought to you for free and open access via ScholarWorks at WMU. It has been accepted for inclusion in Legacy Scout Tickets from Pure Oil Company by an authorized administrator of ScholarWorks at WMU. See the National Digital Catalogue - Science Base Catalogue for more collections submitted by MGRRE.



---

**MGRRE\_PureOilScoutTickets\_Breckenridge State Bank\_1\_21111019970000**

API 21111019970000

Permit Number 1997

Lease Name Breckenridge State Bank

Well Number 1

County Midland

Township 13N

Range 01W

Section 29

2021 DEQ or Pure co\_name McHugh, James P

Pure Number 636

Latitude 43.49455

Longitude -84.46793

DATE May 3, 1934

STATE Michigan COUNTY Midland DIST. Porter SEC. 29 TOWN 13 N RANGE 1 W

WELL No. 1 (SERIAL No. 636) FARM Brackenridge State Bank ACRES

NAME OF STREAM OR WATERS QUADRANGLE NW-NW-NW

OPERATOR James P. McHugh, Trustee MAP Porter Township, Midland County

330 Feet from North Line of Farm

" " East " " "

" " South " " "

330 " " West " " "

330 Feet from North Line of Section

" " East " " "

" " South " " "

330 " " West " " "

## LEGEND

O LOCATION

① RIG

⊗ DRILLING

⊗ GAS WELL

● OIL WELL

⬮ SMALL OIL WELL

⬮ DRY HOLE

⬮ DRY SHOWING OIL

⬮ DRY SHOWING GAS

⬮ ABANDONED LOCATION

⬮ ABANDONED GAS WELL

⬮ ABANDONED OIL WELL

NOTE: Below make tracing from map, (when no map is obtainable make sketch) showing farm, center of section, this location with measurements and also wells, dry holes, or other locations in the vicinity of this location. Make copy to keep for reference and send original to Columbus office.

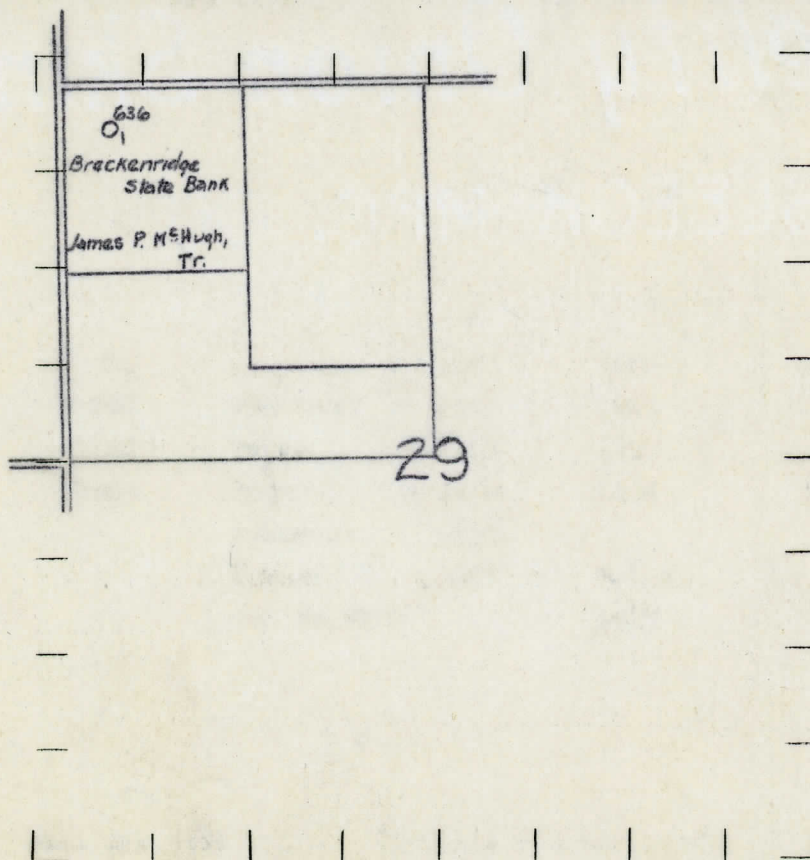

REMARKS:

SIGNED

*R. L. Yeager*  
Superintendent or Foreman.

Per- 1997

