



Western Michigan University
ScholarWorks at WMU

Legacy Scout Tickets from Pure Oil Company

8-20-2021

MGRRE_PureOilScoutTickets_Breu, W. C._4_21111021010000

MGRRE

Western Michigan University

Follow this and additional works at: <https://scholarworks.wmich.edu/pure>



Part of the Geology Commons

WMU ScholarWorks Citation

MGRRE, "MGRRE_PureOilScoutTickets_Breu, W. C._4_21111021010000" (2021). *Legacy Scout Tickets from Pure Oil Company*. 5560.

<https://scholarworks.wmich.edu/pure/5560>

This Document is brought to you for free and open access via ScholarWorks at WMU. It has been accepted for inclusion in Legacy Scout Tickets from Pure Oil Company by an authorized administrator of ScholarWorks at WMU. See the National Digital Catalogue - Science Base Catalogue for more collections submitted by MGRRE.



MGRRE_PureOilScoutTickets_Breu, W. C._4_21111021010000

API 21111021010000

Permit Number 2101

Lease Name Breu, W. C.

Well Number 4

County Midland

Township 13N

Range 01W

Section 20

2021 DEQ or Pure co_name Stork, Fred W.

Pure Number 681

Latitude 43.49986

Longitude -84.45317

THE PURE OIL COMPANY

DATE July 12, 1938

LOCATION REPORT

No. 681STATE Michigan

COUNTY

MidlandDIST. PorterTWP. PorterSEC. 20TOWN 13 NRANGE 1 WWELL No. 4 (SERIAL No. 681) FARMW. C. Brew

ACRES

NAME OF STREAM OR WATERS

QUADRANGLE

SW-NE-SEOPERATOR F. W. Stork

Map

Porter Township, Midland County

Feet from North Line of Farm

" " East " " "

" " South " " "

" " West " " "

Feet from North Line of Section

" " East " " "

" " South " " "

" " West " " "

LEGEND

○ LOCATION

① RIG

⊕ DRILLING

☼ GAS WELL

● OIL WELL

⬮ SMALL OIL WELL

⊙ DRY HOLE

⬮ DRY SHOWING OIL

☼ DRY SHOWING GAS

⊙ ABANDONED LOCATION

☼ ABANDONED GAS WELL

⬮ ABANDONED OIL WELL

NOTE: Below make tracing from map, (when no map is obtainable make sketch) showing farm, center of section, this location with measurements and also wells, dry holes, or other locations in the vicinity of this location.

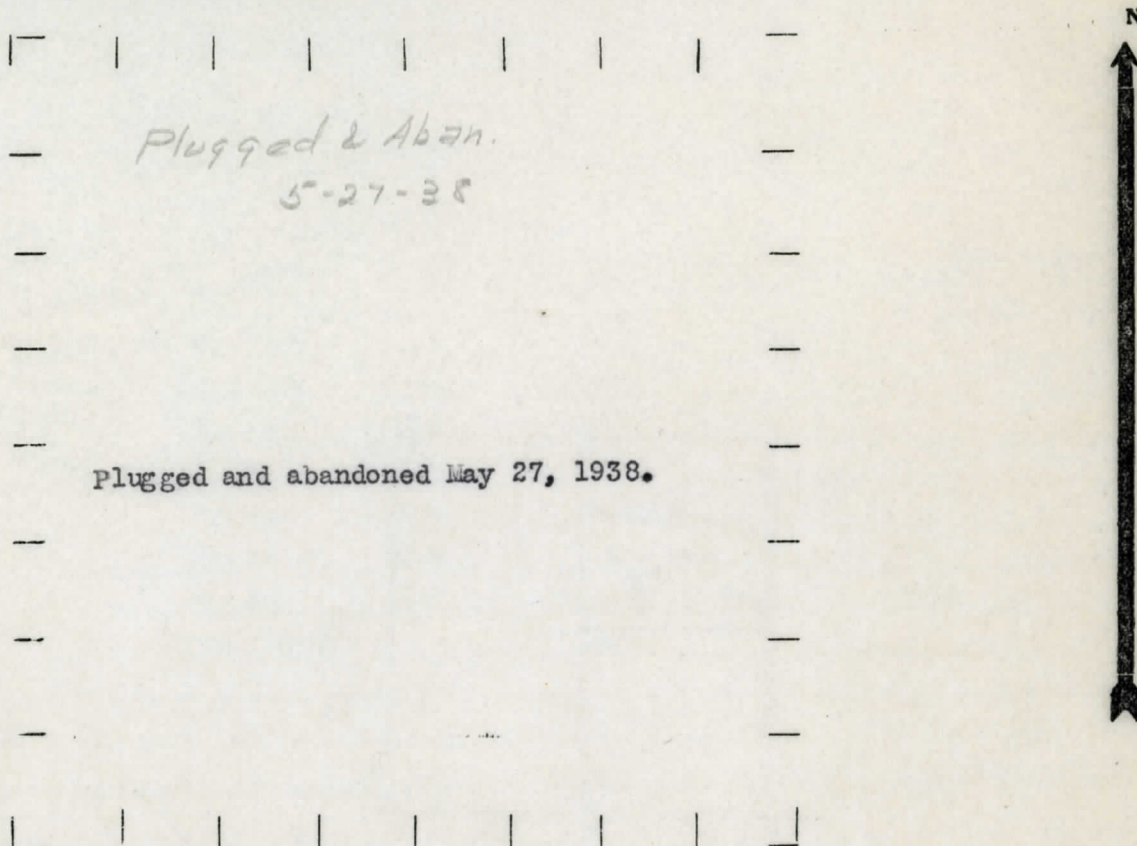

REMARKS:

SIGNED

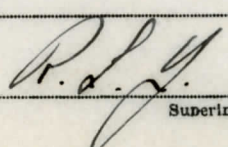
 Superintendent or Foreman.

DATE 7-19-34

LOCATION REPORT

No. 681

STATE Michigan COUNTY Midland DIST. Porter SEC. 20 TOWN 13 N RANGE 1 W
 WELL No. 4 (SERIAL No. 681) FARM W. C. Breu ACRES
 NAME OF STREAM OR WATERS QUADRANGLE SW-NE-SE
 OPERATOR Fred W. Stork MAP Porter Township, Midland County

Feet from North Line of Farm

" " East " " "

330

" " South " " "

330

" " West " " "

Feet from North Line of Section

990

" " East " " "

1650

" " South " " "

" " West " " "

LEGEND

○ LOCATION

① RIG

⊗ DRILLING

⊙ GAS WELL

● OIL WELL

⬮ SMALL OIL WELL

⬮ DRY HOLE

⬮ DRY SHOWING OIL

⬮ DRY SHOWING GAS

⬮ ABANDONED LOCATION

⬮ ABANDONED GAS WELL

⬮ ABANDONED OIL WELL

NOTE: Below make tracing from map, (when no map is obtainable make sketch) showing farm, center of section, this location with measurements and also wells, dry holes, or other locations in the vicinity of this location. Make copy to keep for reference and send original to Columbus office.

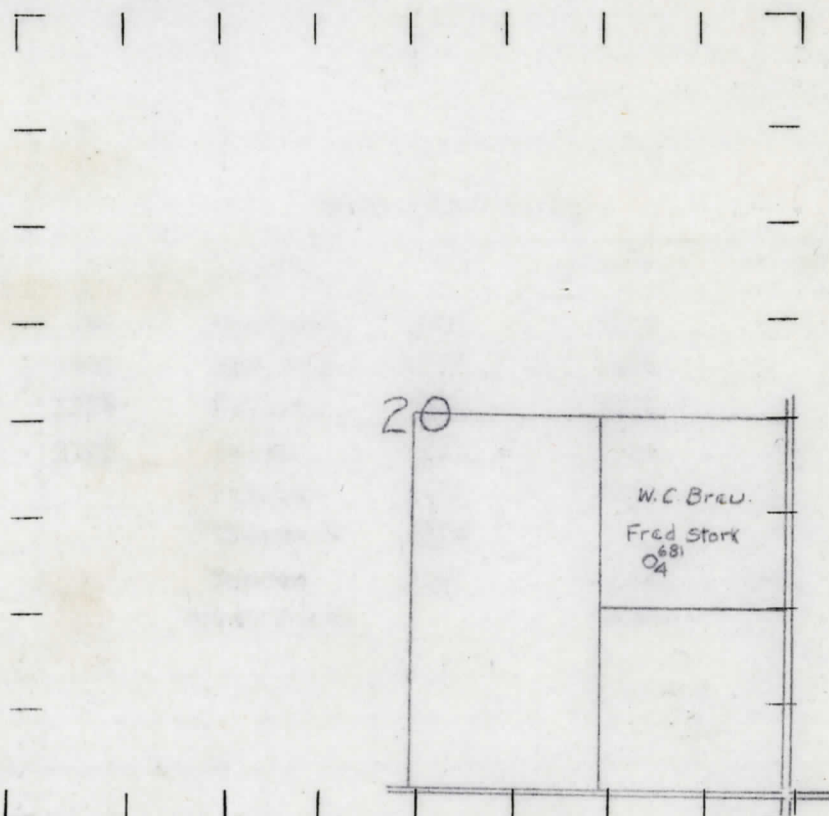

REMARKS:

SIGNED

R. A. Yeager
 Superintendent or Foreman.

Per. # 2101

