



Western Michigan University
ScholarWorks at WMU

Legacy Scout Tickets from Pure Oil Company

8-20-2021

MGRRE_PureOilScoutTickets_Campbell J W_8_21111021630000

MGRRE

Western Michigan University

Follow this and additional works at: <https://scholarworks.wmich.edu/pure>



Part of the Geology Commons

WMU ScholarWorks Citation

MGRRE, "MGRRE_PureOilScoutTickets_Campbell J W_8_21111021630000" (2021). *Legacy Scout Tickets from Pure Oil Company*. 5576.

<https://scholarworks.wmich.edu/pure/5576>

This Document is brought to you for free and open access via ScholarWorks at WMU. It has been accepted for inclusion in Legacy Scout Tickets from Pure Oil Company by an authorized administrator of ScholarWorks at WMU. See the National Digital Catalogue - Science Base Catalogue for more collections submitted by MGRRE.



MGRRE_PureOilScoutTickets_Campbell J W_8_21111021630000

API 21111021630000

Permit Number 2163

Lease Name Campbell J W

Well Number 8

County Midland

Township 13N

Range 01W

Section 18

2021 DEQ or Pure co_name Summit Petroleum Corporation

Pure Number 705

Latitude 43.51623

Longitude -84.47284

THE PURE OIL COMPANY

Date March 21, 1945 Corrected LOCATION REPORT A.F.E. No. _____

Division Mich. Producing District _____ Lease J. W. Campbell

Acres _____ Lease No. _____ Elevation _____ Well No. 8 (Serial No. 705)

Quadrangle NW NE SE Sec. 18 Twp. 13 N Rge. 1 W ~~XXX~~ ~~XXX~~ Porter

Survey _____ County Midland State Michigan

Operator Evaluation & Sales Service Map Porter Township, Midland County

Feet from North Line of Lease
" " East " " "
" " South " " "
" " West " " "
Feet from North Line of Section
" " East " " "
" " South " " "
" " West " " "

- LEGEND
- Location
- ☼ Gas Well
- Oil Well
- ☼ Gas - Distillate Well
- or ○ Dry Hole
- Dry Showing Oil
- ☼ Dry Showing Gas
- ☼ Abandoned Location
- ☼ or ☼ Abandoned Gas Well
- or ● Abandoned Oil Well
- or ○ Input Well

See plat - Midland #705.

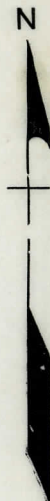

Remarks: Change of operator. Scale _____

Submitted by Scouting Department Approved by _____ Division Manager

Approved by _____ Vice-President - General Manager

Date March 27 1934 Collected
DATE 9/6/34
STATE Mich COUNTY Midland DIST. Porter TWP. Porter SEC. 18 TOWN 13N RANGE 1W
WELL No. 8 (SERIAL No. 705) FARM J.W. Campbell
NAME OF STREAM OR WATERS QUADRANGLE NW-NE-SE
OPERATOR Strange & Fortney MAP Porter Township, Midland County
Porter Twp. - Midland Co.

Feet from North Line of Farm
" " East " " "
" " South " " "
" " West " " "
330 330 Feet from North Line of Section
990 990 " " East " " "
" " South " " "
" " West " " "

- LEGEND
- | | |
|------------------|----------------------|
| O LOCATION | ✦ DRY HOLE |
| ① RIG | ✦ DRY SHOWING OIL |
| ⊕ DRILLING | ✦ DRY SHOWING GAS |
| ⊗ GAS WELL | ⊗ ABANDONED LOCATION |
| ● OIL WELL | ⊗ ABANDONED GAS WELL |
| ⬮ SMALL OIL WELL | ⬮ ABANDONED OIL WELL |

NOTE: Below make tracing from map, (when no map is obtainable make sketch) showing farm, center of section, this location with measurements and also wells, dry holes, or other locations in the vicinity of this location. Make copy to keep for reference and send original to Columbus office.

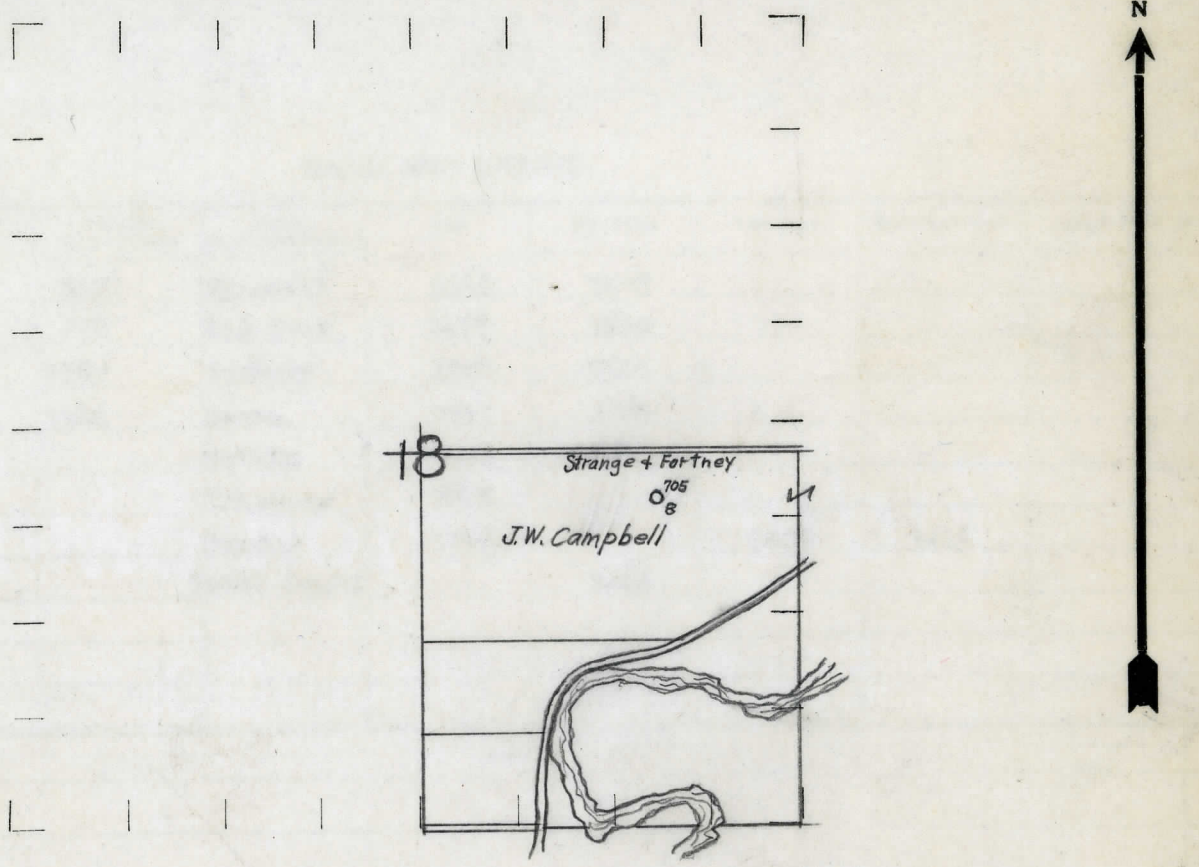

REMARKS:

SIGNED R.L. Meyer
Superintendent or Foreman.
Per # 2163

