



Western Michigan University
ScholarWorks at WMU

Legacy Scout Tickets from Pure Oil Company

8-20-2021

MGRRE_PureOilScoutTickets_Campbell_8_21111024170000

MGRRE

Western Michigan University

Follow this and additional works at: <https://scholarworks.wmich.edu/pure>



Part of the Geology Commons

WMU ScholarWorks Citation

MGRRE, "MGRRE_PureOilScoutTickets_Campbell_8_21111024170000" (2021). *Legacy Scout Tickets from Pure Oil Company*. 5615.

<https://scholarworks.wmich.edu/pure/5615>

This Document is brought to you for free and open access via ScholarWorks at WMU. It has been accepted for inclusion in Legacy Scout Tickets from Pure Oil Company by an authorized administrator of ScholarWorks at WMU. See the National Digital Catalogue - Science Base Catalogue for more collections submitted by MGRRE.



MGRRE_PureOilScoutTickets_Campbell_8_21111024170000

API 21111024170000

Permit Number 2417

Lease Name Campbell

Well Number 8

County Midland

Township 13N

Range 01W

Section 17

2021 DEQ or Pure co_name Roosevelt Oil Company

Pure Number 772

Latitude 43.52005

Longitude -84.46116

THE PURE OIL COMPANY

DATE July 12, 1938

LOCATION REPORT

No. 772STATE Michigan COUNTY Midland DIST Porter TWP Porter SEC. 17 TOWN 13 N RANGE 1 WWELL No. 8 (SERIAL No. 772²) FARM J. W. Campbell ACRESNAME OF STREAM OR WATERS QUADRANGLE NW SE NWOPERATOR Roosevelt Oil Company Map Porter Township, Midland County

Feet from North Line of Farm

" " East " " "

" " South " " "

" " West " " "

Feet from North Line of Section

" " East " " "

" " South " " "

" " West " " "

LEGEND

○ LOCATION

① RIG

⊕ DRILLING

☀ GAS WELL

● OIL WELL

⬮ SMALL OIL WELL

⊖ DRY HOLE

⬮ DRY SHOWING OIL

⊖ DRY SHOWING GAS

⊖ ABANDONED LOCATION

⬮ ABANDONED GAS WELL

⬮ ABANDONED OIL WELL

NOTE: Below make tracing from map, (when no map is obtainable make sketch) showing farm, center of section, this location with measurements and also wells, dry holes, or other locations in the vicinity of this location.

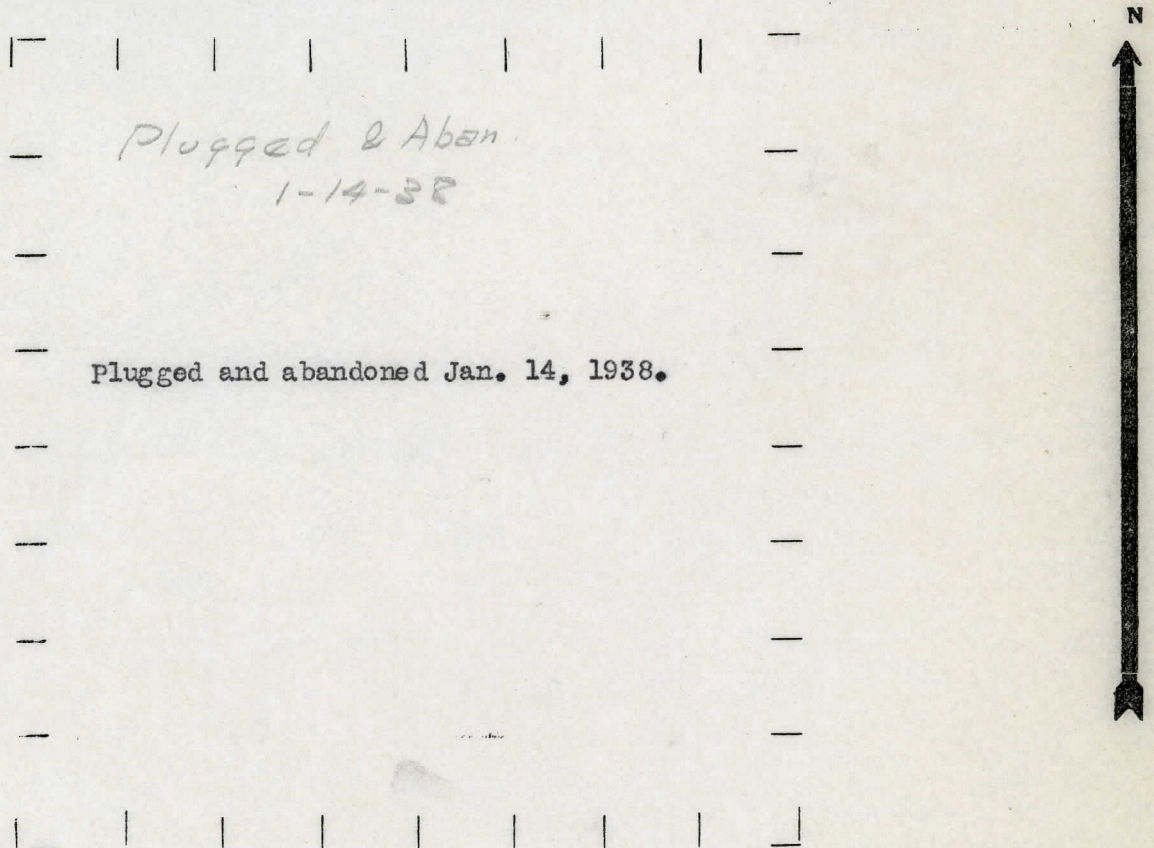

REMARKS:

SIGNED

Superintendent or Foreman.

DATE April 18, 1935 LOCATION Porter NO. 772

STATE Michigan COUNTY Midland DIST. Porter SEC. 17 TOWN 13N RANGE 1W

WELL No. 8 (SERIAL No. 772) FARM J. W. Campbell ACRES

NAME OF STREAM OR WATERS QUADRANGLE NE-SE-NW
NE-SE-NW

OPERATOR Roosevelt Oil Company Map Porter Township, Midland County
Roosevelt Oil Co. Porter - Mid.

Feet from North Line of Farm

810	810	"	"	East	"	"	"
960	960	"	"	South	"	"	"
		"	"	West	"	"	"
Feet from North Line of Section							
525	525	"	"	East	"	"	$\frac{1}{4}$ "
1040	1040	"	"	South	"	"	$\frac{1}{4}$ "
		"	"	West	"	"	"

- LEGEND**
- LOCATION
 - ⊕ RIG
 - ⊕ DRILLING
 - ☼ GAS WELL
 - OIL WELL
 - ⊕ SMALL OIL WELL
 - ⊕ DRY HOLE
 - ⊕ DRY SHOWING OIL
 - ⊕ DRY SHOWING GAS
 - ⊕ ABANDONED LOCATION
 - ☼ ABANDONED GAS WELL
 - ⊕ ABANDONED OIL WELL

NOTE: Below make tracing from map, (when no map is obtainable make sketch) showing farm, center of section, this location with measurements and also wells, dry holes, or other locations in the vicinity of this location.

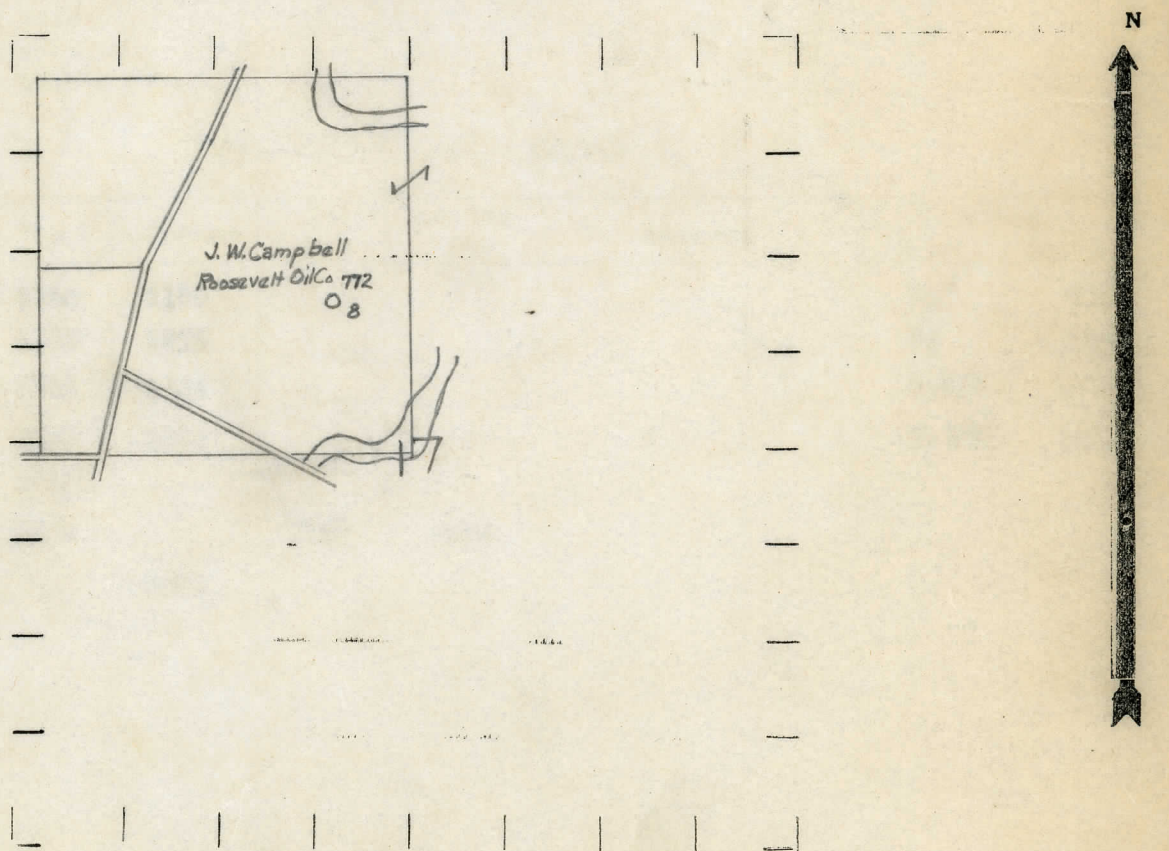

REMARKS:

SIGNED R. L. Meager
Superintendent or Foreman.

DVLE VOLII JO² JO32

PROCLAMATION BY ROBERT

140

Michigan Producing Division

Date 7/5/35 No. 772
State Michigan County Midland Dist.
Twp. Porter Sec. 17 Twp. 13N Rge. 1W
(Serial No.)
Well No. 8 (County No.) 772 Farm J. W. Campbell Acres
Operator Roosevelt Oil Company by
Information secured from Scouting Dept.
Date well started 4/18/35 Date well completed 6/27/35 Elevation 678'

PRODUCTION RECORD

1st 24 hours natural	120 bbls.				
2nd 24 hours natural					
Date of shot	No. of quarts	From	to	From	to
Date of acid	No. of gallons				
1st 24 hours after acid	shot				
2nd 24 hours after acid	shot				

FORMATION AND CASING RECORD

[illegible]

Remarks

Signed

Signed *Otto Ottersky*