



Western Michigan University
ScholarWorks at WMU

Legacy Scout Tickets from Pure Oil Company

8-20-2021

MGRRE_PureOilScoutTickets_Bernard, Ed_1_21111029890000

MGRRE

Western Michigan University

Follow this and additional works at: <https://scholarworks.wmich.edu/pure>



Part of the Geology Commons

WMU ScholarWorks Citation

MGRRE, "MGRRE_PureOilScoutTickets_Bernard, Ed_1_21111029890000" (2021). *Legacy Scout Tickets from Pure Oil Company*. 5641.

<https://scholarworks.wmich.edu/pure/5641>

This Document is brought to you for free and open access via ScholarWorks at WMU. It has been accepted for inclusion in Legacy Scout Tickets from Pure Oil Company by an authorized administrator of ScholarWorks at WMU. See the National Digital Catalogue - Science Base Catalogue for more collections submitted by MGRRE.



MGRRE_PureOilScoutTickets_Bernard, Ed_1_21111029890000

API 21111029890000

Permit Number 2989

Lease Name Bernard, Ed

Well Number 1

County Midland

Township 14N

Range 02W

Section 10

2021 DEQ or Pure co_name Hubbell, O I L Producing Company

Pure Number 855

Latitude 43.61792

Longitude -84.54605

THE PURE OIL COMPANY

DATE February 1, 1939

LOCATION REPORT

No. 855

STATE Michigan

COUNTY Midland

DIST

Greendale

TWP.

SEC. 10

TOWN 14 N

RANGE 2 W

WELL No. 1 (SERIAL No. 855) FARM

PREC

A. Bernard

ACRES

NAME OF STREAM OR WATERS

QUADRANGLE

CN 1/2 NW SW

OPERATOR Hubbell Oil Producing Company

Map

Greendale Township, Midland County

Hubbell Oil Prod. Co.

Greendale-Mid.

Feet from North Line of Farm

" " East " " "

" " South " " "

" " West " " "

Feet from North Line of Section

" " East " " "

" " South " " "

" " West " " "

LEGEND

O LOCATION

① RIG

⊕ DRILLING

☼ GAS WELL

● OIL WELL

⦿ SMALL OIL WELL

⊖ DRY HOLE

⦿ DRY SHOWING OIL

☼ DRY SHOWING GAS

⊖ ABANDONED LOCATION

☼ ABANDONED GAS WELL

⦿ ABANDONED OIL WELL

NOTE: Below make tracing from map, (when no map is obtainable make sketch) showing farm, center of section, this location with measurements and also wells, dry holes, or other locations in the vicinity of this location.

Plugged & Aban 6-21-38

Plugged and abandoned 6-21-38.

N



REMARKS:

SIGNED

Superintendent or Foreman.

DYLE REGISTRATION T. 1292

DATE 12-26-35

LOCATION REPORT

No. 855

STATE Mich. COUNTY Midland DIST. Greendale SEC. 10 TOWN 14 N. RANGE 2 W.
WELL No. 1 (SERIAL No. 855) FARM A. Bernard

NAME OF STREAM OR WATERS QUADRANGLE C-14-NW-SW

OPERATOR Hubbell Oil Prdco. Co. Map Greendale Twp., Midland County
330 330 Feet from North Line of Farm Greendale Twp - Mid. Co.

660 660 Feet from North Line of Section
330 330 Feet from North Line of Section
660 660 Feet from North Line of Section

- LEGEND
- O LOCATION
 - ① RIG
 - ⊕ DRILLING
 - ☼ GAS WELL
 - OIL WELL
 - ⬮ SMALL OIL WELL
 - ⊙ DRY HOLE
 - ⬮ DRY SHOWING OIL
 - ☼ DRY SHOWING GAS
 - ⊙ ABANDONED LOCATION
 - ☼ ABANDONED GAS WELL
 - ⬮ ABANDONED OIL WELL

NOTE: Below make tracing from map, (when no map is obtainable make sketch) showing farm, center of section, this location with measurements and also wells, dry holes, or other locations in the vicinity of this location.

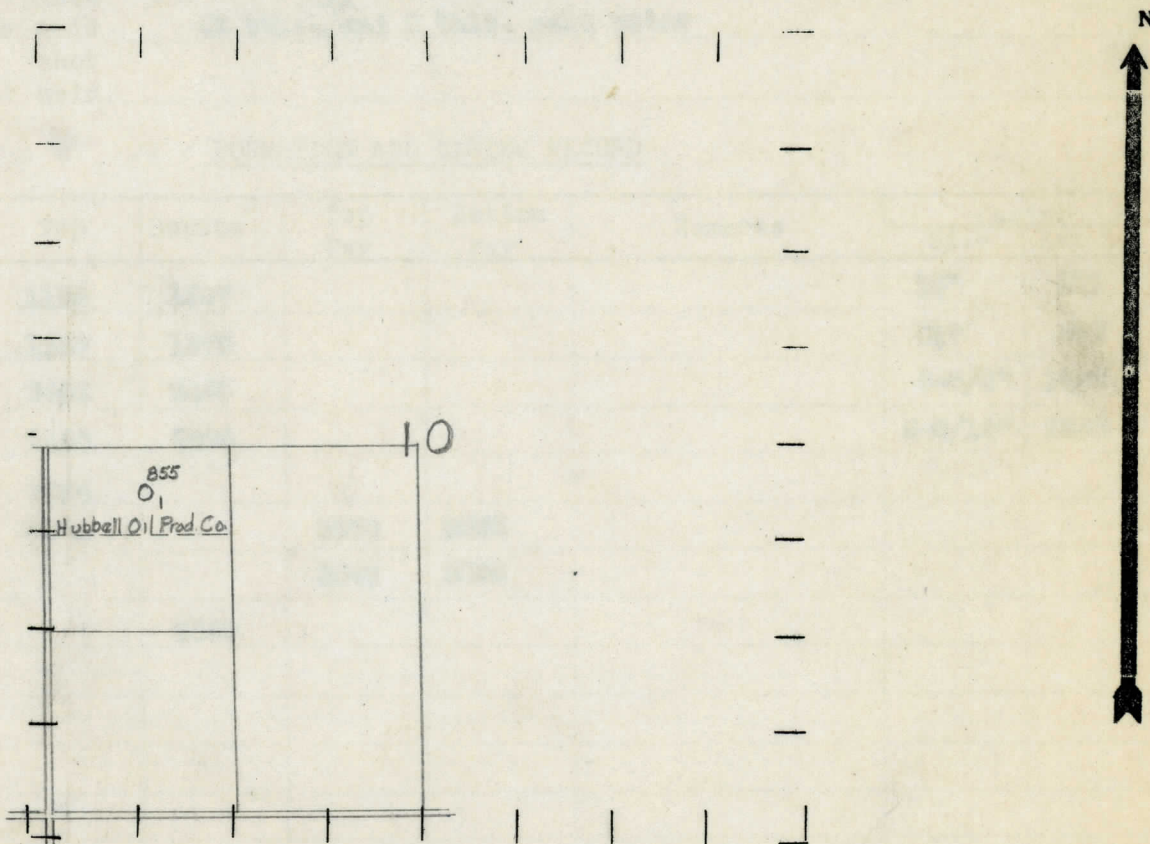

REMARKS:

SIGNED

R.L. Yeager
Superintendent or Foreman.

Michigan Producing Division

No. 855

Dist.
Twp. **Greendale**

Sec. 10

Twp. 14 N Rge. 2 W

Farm E. Barnard

Acres

by

Date well started 12-25-35 Date well completed 5-14-36 Elevation 688.8

PRODUCTION RECORD

2nd 24 hours natural

[illegible]

Date of acid 5-15-36 No. of gallons 1000

1st 24 hours after acid shot oil
45 bbls./and 5 bbls. salt water

2nd 24 hours after acid shot

FORMATION AND CASING RECORD

[illegible]

Remarks

Signed

G. A. Bell