



Western Michigan University
ScholarWorks at WMU

Legacy Scout Tickets from Pure Oil Company

8-20-2021

MGRRE_PureOilScoutTickets_Cassidy_1_21111039500000

MGRRE

Western Michigan University

Follow this and additional works at: <https://scholarworks.wmich.edu/pure>



Part of the Geology Commons

WMU ScholarWorks Citation

MGRRE, "MGRRE_PureOilScoutTickets_Cassidy_1_21111039500000" (2021). *Legacy Scout Tickets from Pure Oil Company*. 5687.

<https://scholarworks.wmich.edu/pure/5687>

This Document is brought to you for free and open access via ScholarWorks at WMU. It has been accepted for inclusion in Legacy Scout Tickets from Pure Oil Company by an authorized administrator of ScholarWorks at WMU. See the National Digital Catalogue - Science Base Catalogue for more collections submitted by MGRRE.



MGRRE_PureOilScoutTickets_Cassidy_1_21111039500000

API 21111039500000

Permit Number 3950

Lease Name Cassidy

Well Number 1

County Midland

Township 14N

Range 02W

Section 16

2021 DEQ or Pure co_name Jorgensen, M. L.

Pure Number 977

Latitude 43.60781

Longitude -84.5622

THE PURE OIL COMPANY

DATE 2-2-38

LOCATION REPORT

No. 977STATE MichiganCOUNTY MidlandDIST. GreendaleTWP. GreendaleSEC. 16TOWN 14-NRANGE 2-WWELL No. 1 (SERIAL No. 977) FARM W. A. Cassidy

ACRES

NAME OF STREAM OR WATERS

QUADRANGLE CW₁-E₁-NW₁
C-W₂-E₁-NW₁OPERATOR M. L. JorgensenMap Greendale Twp., Midland Co.M. L. JorgensenGreendale-Mid

Feet from North Line of Farm

" " East " " "

" " South " " "

" " West " " "

Feet from North Line of Section

" " East " " "

" " South " " "

" " West " " "

LEGEND

○ LOCATION

① RIG

⊕ DRILLING

☼ GAS WELL

● OIL WELL

⦿ SMALL OIL WELL

⊙ DRY HOLE

⦿ DRY SHOWING OIL

⊙ DRY SHOWING GAS

⊙ ABANDONED LOCATION

☼ ABANDONED GAS WELL

⦿ ABANDONED OIL WELL

NOTE: Below make tracing from map, (when no map is obtainable make sketch) showing farm, center of section, this location with measurements and also wells, dry holes, or other locations in the vicinity of this location.

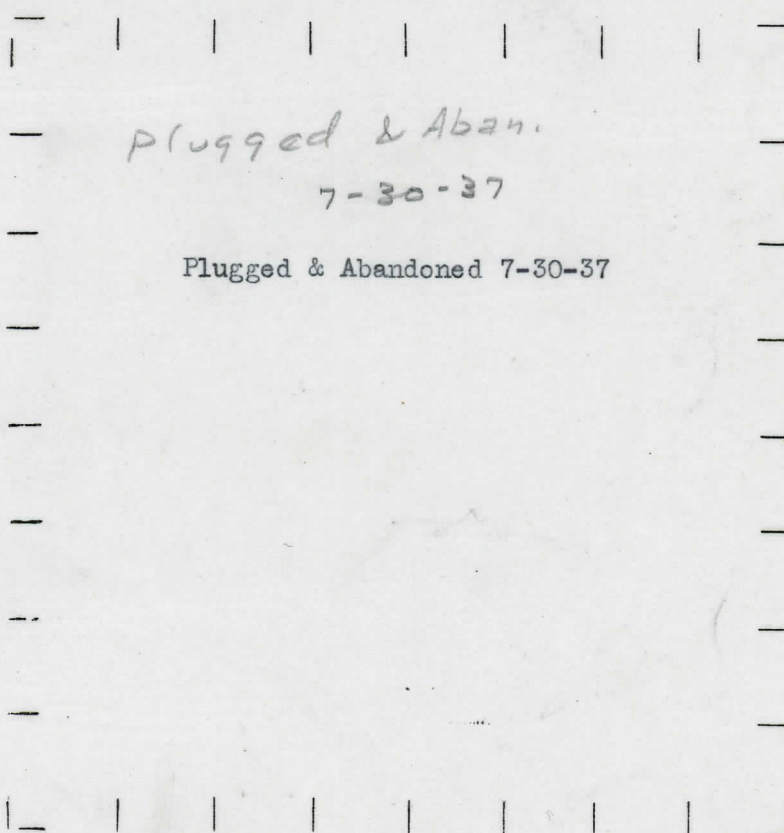

REMARKS:

SIGNED

R. L. Yager
 Superintendent or Foreman.

DATE March 18, 1937

LOCATION REPORT

No. 977

STATE Michigan

COUNTY

Midland

DIST.

Greendale

TWP.

Greendale

SEC.

16

TOWN

14 N

RANGE

2 W

WELL No. 1

(SERIAL No. 977)

FARM

PREC.

W. A. Cassidy

ACRES

NAME OF STREAM OR WATERS

QUADRANGLE

CW 1/2 E 1/2 NW

OPERATOR M. L. Jorgensen

Map

Greendale Township, Midland County

660 660

Feet from North Line of Farm

330 330

" " East " " "

" " South " " "

330 330

" " West " " "

1320 1320

Feet from North Line of Section

990 990

" " East " 1/4 "

" " South " " "

" " West " " "

LEGEND

○ LOCATION

⊕ RIG

⊕ DRILLING

⊗ GAS WELL

● OIL WELL

⊕ SMALL OIL WELL

⊗ DRY HOLE

⊕ DRY SHOWING OIL

⊗ DRY SHOWING GAS

⊗ ABANDONED LOCATION

⊗ ABANDONED GAS WELL

⊗ ABANDONED OIL WELL

NOTE: Below make tracing from map, (when no map is obtainable make sketch) showing farm, center of section, this location with measurements and also wells, dry holes, or other locations in the vicinity of this location.

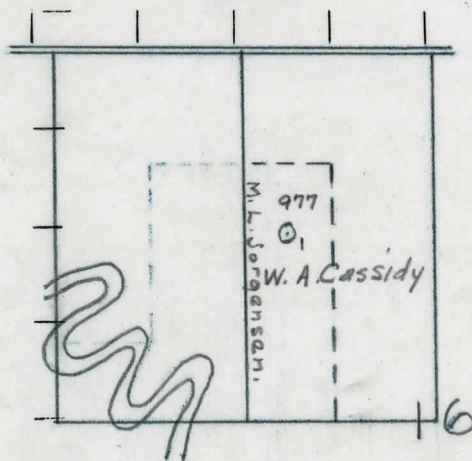

REMARKS:

SIGNED

R. L. Yeager
Superintendent or Foreman.

COMPLETION RECORD OF WELLS DRILLED BY OTHER OPERATORS

Michigan Producing Division

Date May 28, 1937 No. 977
State Michigan County Midland Dist. Greendale
Twp. 16 Sec. 14 Twp. 14 N Rge. 2 W
Well No. 1 (Serial No.)
(County No.) 977 Farm Cassidy Acres
Operator M. L. Jorgensen by Scouting Department
Information secured from
Date well started 3-26-37 Date well completed 5-19-37 Elevation 675.6

PRODUCTION RECORD

1st 24 hours natural Filled up 600 ft.

2nd 24 hours natural

Date of shot	No. of quarts	From	to	From	to
--------------	------------------	------	----	------	----

Date of acid **5-20-37** No. of gallons **1000**

1st 24 hours after acid **56 Barrels**

2nd 24 hours after acid

FORMATION AND CASING RECORD

[illegible]

Remarks

Signed

Dean C. Shackelford