



Western Michigan University
ScholarWorks at WMU

Legacy Scout Tickets from Pure Oil Company

8-20-2021

MGRRE_PureOilScoutTickets_Porter Ranch_1_unk

MGRRE

Western Michigan University

Follow this and additional works at: <https://scholarworks.wmich.edu/pure>



Part of the Geology Commons

WMU ScholarWorks Citation

MGRRE, "MGRRE_PureOilScoutTickets_Porter Ranch_1_unk" (2021). *Legacy Scout Tickets from Pure Oil Company*. 5822.

<https://scholarworks.wmich.edu/pure/5822>

This Document is brought to you for free and open access via ScholarWorks at WMU. It has been accepted for inclusion in Legacy Scout Tickets from Pure Oil Company by an authorized administrator of ScholarWorks at WMU. See the National Digital Catalogue - Science Base Catalogue for more collections submitted by MGRRE.



MGRRE_PureOilScoutTickets_Porter Ranch_1_unk

API unk

Permit Number unk

Lease Name Porter Ranch

Well Number 1

County Missaukee

Township 22N

Range 5W

Section 12

2021 DEQ or Pure co_name M. R. Forkapa

Pure Number 1

Latitude 44.313371

Longitude -84.8637309

THE PURE OIL COMPANY

DATE Oct. 11, 1929

LOCATION REPORT

No. 1

STATE Michigan COUNTY Butterfield DIST. Missaukee SEC. 12 TOWN 22N RANGE 5W

WELL No. 1 (SERIAL No. 1) FARM Porter Ranch ACRES _____

NAME OF STREAM OR WATERS _____ QUADRANGLE SE - SW

OPERATOR M. R. Forkopa MAP Butterfield Twp., Missaukee County

Feet from North Line of Farm

990 " " East " " "

1650 " " South " " "

1650 " " West " " "

Feet from North Line of Section

990 " " East " " "

1650 " " South " " "

1650 " " West " " "

LEGEND

- LOCATION
- ⊕ RIG
- ⊕ DRILLING
- ⊗ GAS WELL
- OIL WELL
- ⊕ SMALL OIL WELL
- ⊗ DRY HOLE
- ⊕ DRY SHOWING OIL
- ⊗ DRY SHOWING GAS
- ⊗ ABANDONED LOCATION
- ⊗ ABANDONED GAS WELL
- ⊗ ABANDONED OIL WELL

NOTE: Below make tracing from map, (when no map is obtainable make sketch) showing farm, center of section, this location with measurements and also wells, dry holes, or other locations in the vicinity of this location. Make copy to keep for reference and send original to Columbus office.

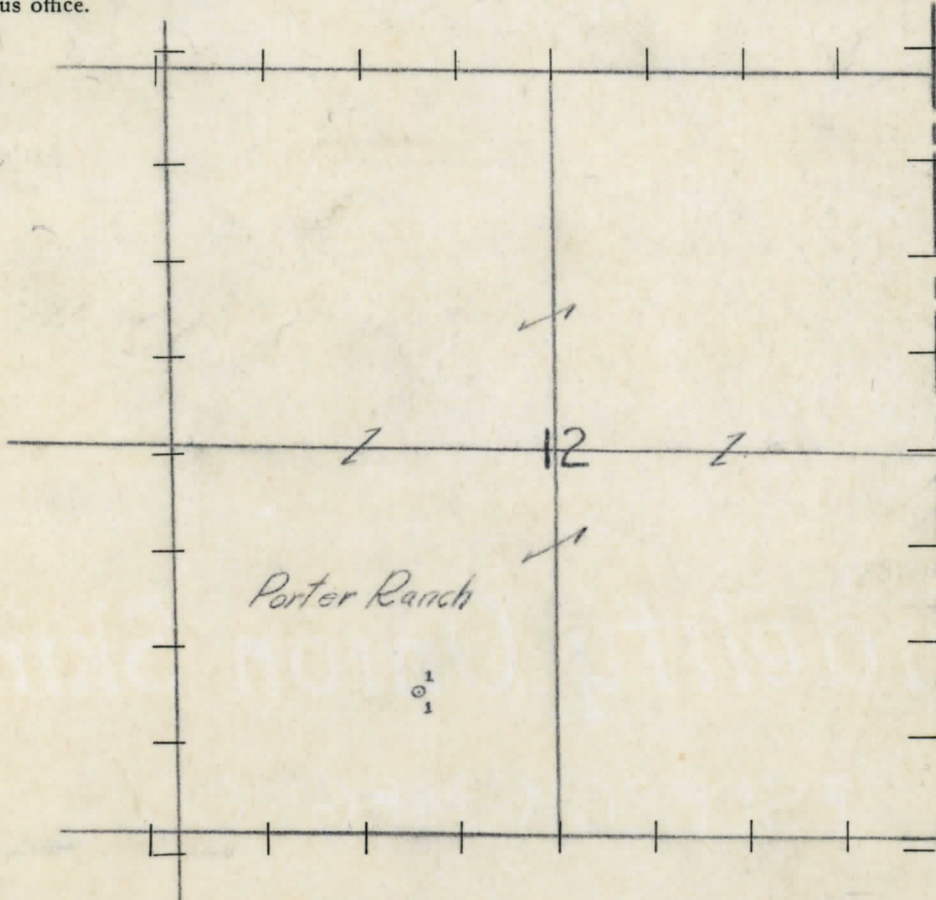

REMARKS: _____

SIGNED _____

Superintendent or Foreman.

Well Map file

THE PURE OIL COMPANY

Michigan Producing DIVISION

DATE March 15th, 1930.

COMPLETION RECORD

No. -1-

STATE Michigan COUNTY Missaukee DIST. Butterfield TWP. Butterfield SEC. 12 TOWN 22 RANGE 5 W

WELL No. 1 (SERIAL No. 1) FARM Porter Ranch ACRES _____

NAME OF STREAM OR WATERS _____ QUADRANGLE _____

OPERATOR M.R.Forkaps MAP Butterfield Twp., Missaukee Co.

LOCATION REPORT SENT IN (DATE) Oct. 11th, 1929.

WELL STARTED (DATE) _____ WELL COMPLETED (DATE) _____

~~WELL~~

~~GAS WELL~~

~~DRY HOLE~~

~~ABANDONED WELL~~

CROSS OUT THREE OF THE ABOVE
WELL RECORD

DATE OF SHOT	NUMBER OF QUARTS	BARRELS OR FEET
1st 24 HOURS PRODUCTION		
2nd " " "		" " "
3rd " " "		" " "
4th " " "		" " "
5th " " "		" " "

SAND AND CASING

CASING SIZE	WEIGHT	CASING Feet Inches	SAND Name and Nature	TOP	BOTTOM	TOP PAY	BOTTOM PAY	SALT WATER

REMARKS Abandoned location.

NOTE:—MAKE COPY TO KEEP FOR REFERENCE AND SEND ORIGINAL TO CHICAGO OFFICE. LIST MATERIAL CHARGEABLE TO WELL ON OTHER SIDE.

SIGNED _____ SUPT. OR FOREMAN