



Western Michigan University
ScholarWorks at WMU

Legacy Scout Tickets from Pure Oil Company

8-20-2021

**MGRRE_PureOilScoutTickets_Schetenhelm et
al_1_21113048790000**

MGRRE

Western Michigan University

Follow this and additional works at: <https://scholarworks.wmich.edu/pure>



Part of the Geology Commons

WMU ScholarWorks Citation

MGRRE, "MGRRE_PureOilScoutTickets_Schetenhelm et al_1_21113048790000" (2021). *Legacy Scout Tickets from Pure Oil Company*. 5829.

<https://scholarworks.wmich.edu/pure/5829>

This Document is brought to you for free and open access via ScholarWorks at WMU. It has been accepted for inclusion in Legacy Scout Tickets from Pure Oil Company by an authorized administrator of ScholarWorks at WMU. See the National Digital Catalogue - Science Base Catalogue for more collections submitted by MGRRE.



MGRRE_PureOilScoutTickets_Schetenhelm et al_1_21113048790000

API 21113048790000

Permit Number 4879

Lease Name Schetenhelm et al

Well Number 1

County Missaukee

Township 23N

Range 07W

Section 36

2021 DEQ or Pure co_name Moser Oil Company

Pure Number 8

Latitude 44.33891

Longitude -85.09736

THE PURE OIL COMPANY
COMPLETION RECORD OF WELLS DRILLED BY OTHER OPERATORS
LOCATION REPORT

DATE March 24, 1938 No. 8
STATE Michigan COUNTY Missaukee DIST. Forrest SEC. 36 TOWN 23 N RANGE 7 W
WELL No. 1 (SERIAL No. 8) FARM Benjamin Schetenhelm, et al. ACRES
NAME OF STREAM OR WATERS _____ QUADRANGLE SE-SE-SE
SE SE SE

OPERATOR Moser Oil Company Map Forrest Township, Missaukee County
Moser Oil Co. Forrest - Miss.

Feet from North Line of Farm
450 " " East " " "
3330 " " South " " "
" " West " " "
Feet from North Line of Section
450 " " East " " "
3330 " " South " " "
" " West " " "

- LEGEND**
- LOCATION
 - ⊙ RIG
 - ⊕ DRILLING
 - ☀ GAS WELL
 - OIL WELL
 - ⬮ SMALL OIL WELL
 - ⊖ DRY HOLE
 - ⬮ DRY SHOWING OIL
 - ☀ DRY SHOWING GAS
 - ⊖ ABANDONED LOCATION
 - ☀ ABANDONED GAS WELL
 - ⬮ ABANDONED OIL WELL

NOTE: Below make tracing from map, (when no map is obtainable make sketch) showing farm, center of section, this location with measurements and also wells, dry holes, or other locations in the vicinity of this location.

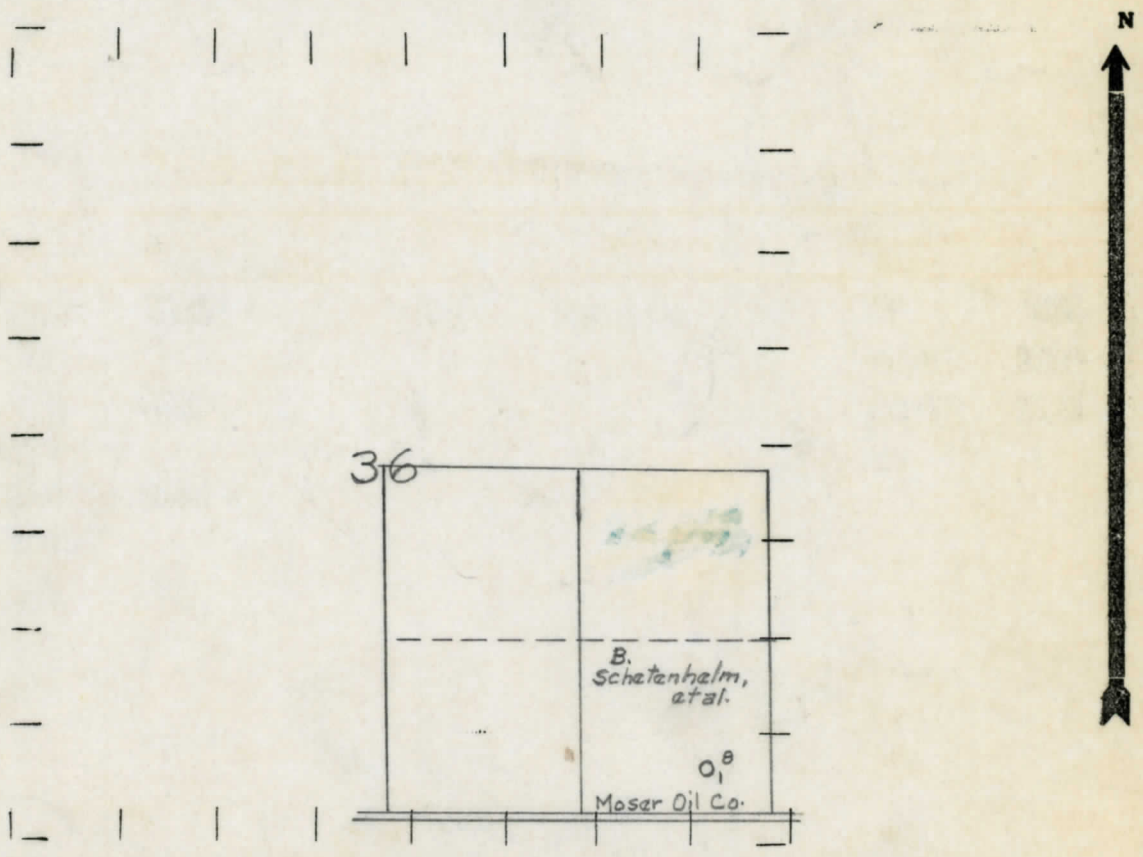

REMARKS:

SIGNED R. L. Young
Superintendent or Foreman.

Michigan Producing Division

Date January 5, 1939 No. 8
 State Mich. County Missaukee Dist. Forrest
 Twp. Forrest Sec. 36 Twp. 23 N Rge. 7 W
 Well No. 1 (Serial No.) 8 Farm Schetonhelm, et al Acres _____
 Operator Moser Oil Company Information secured ~~from~~ Scouting Department
 Date well started 3-24-38 Date well completed 12-30-38 Elevation 1205.0

PRODUCTION RECORD

1st 24 hours natural Dry Hole
 2nd 24 hours natural _____
 Date of shot _____ No. of quarts _____ From _____ to _____
 Date of acid _____ No. of gallons _____
 1st 24 hours after acid shot _____
 2nd 24 hours after acid shot _____

FORMATION AND CASING RECORD

Formation	Top	Bottom	Top Pay	Bottom Pay	Remarks	Casing	
						Size	Set at
Stray	1185	1260		1190	H.F.S.W.	10"	645
Marshall	1305					8-1/4"	1024
Red Rock	1414	1430				6-5/8"	1516
Sunbury	2295 ?						
Berea	2335	2350 ?					
Antrim	2350						
Traverse	3075	C.T.M.					
Dundee	3792	S.L.M.					
Monroe	3997 ?		4096	4100	Salt water-350 ft.		
Total Depth		4100					

Remarks 3793' C.T.M. equals 3801' S.L.M.

Signed D. C. Shackelford