



Western Michigan University
ScholarWorks at WMU

Legacy Scout Tickets from Pure Oil Company

8-20-2021

MGRRE_PureOilScoutTickets_Community Lease_1_21113074390000

MGRRE
Western Michigan University

Follow this and additional works at: <https://scholarworks.wmich.edu/pure>



Part of the Geology Commons

WMU ScholarWorks Citation

MGRRE, "MGRRE_PureOilScoutTickets_Community Lease_1_21113074390000" (2021). *Legacy Scout Tickets from Pure Oil Company*. 5854.
<https://scholarworks.wmich.edu/pure/5854>

This Document is brought to you for free and open access via ScholarWorks at WMU. It has been accepted for inclusion in Legacy Scout Tickets from Pure Oil Company by an authorized administrator of ScholarWorks at WMU. See the National Digital Catalogue - Science Base Catalogue for more collections submitted by MGRRE.



MGRRE_PureOilScoutTickets_Community Lease_1_21113074390000

API 21113074390000

Permit Number 7439

Lease Name Community Lease

Well Number 1

County Missaukee

Township 23N

Range 05W

Section 31

2021 DEQ or Pure co_name Teater, C, W.

Pure Number 32

Latitude 44.33975

Longitude -84.95986

THE PURE OIL COMPANY

DATE March 13, 1940

LOCATION REPORT

No. 32

STATE Michigan COUNTY Missaukee DISTRICT Enterprise TWP. Enterprise SEC. 31 TOWN 23 N RANGE 5 W
WELL No. 1 (SERIAL No. 32) FARM Community Lease ACRES

NAME OF STREAM OR WATERS _____ QUADRANGLE C SE 1/4

OPERATOR C. W. Teater Map Enterprise Township, Missaukee County
C. W. Teater Enterprise - Missaukee

Feet from North Line of Farm
1320 1320 " " East " " "
1320 1320 " " South " " "
" " West " " "

Feet from North Line of Section
1320 1320 " " East " " 1/4
1320 1320 " " South " " 1/4
" " West " " "

LEGEND

- LOCATION
- ⊕ DRILLING
- ☀ GAS WELL
- OIL WELL
- ⬮ SMALL OIL WELL
- ⊖ DRY HOLE
- ◆ DRY SHOWING OIL
- ⊖ DRY SHOWING GAS
- ⊖ ABANDONED LOCATION
- ☀ ABANDONED GAS WELL
- ⬮ ABANDONED OIL WELL

NOTE: Below make tracing from map, (when no map is obtainable make sketch) showing farm, center of section, this location with measurements and also wells, dry holes, or other locations in the vicinity of this location.

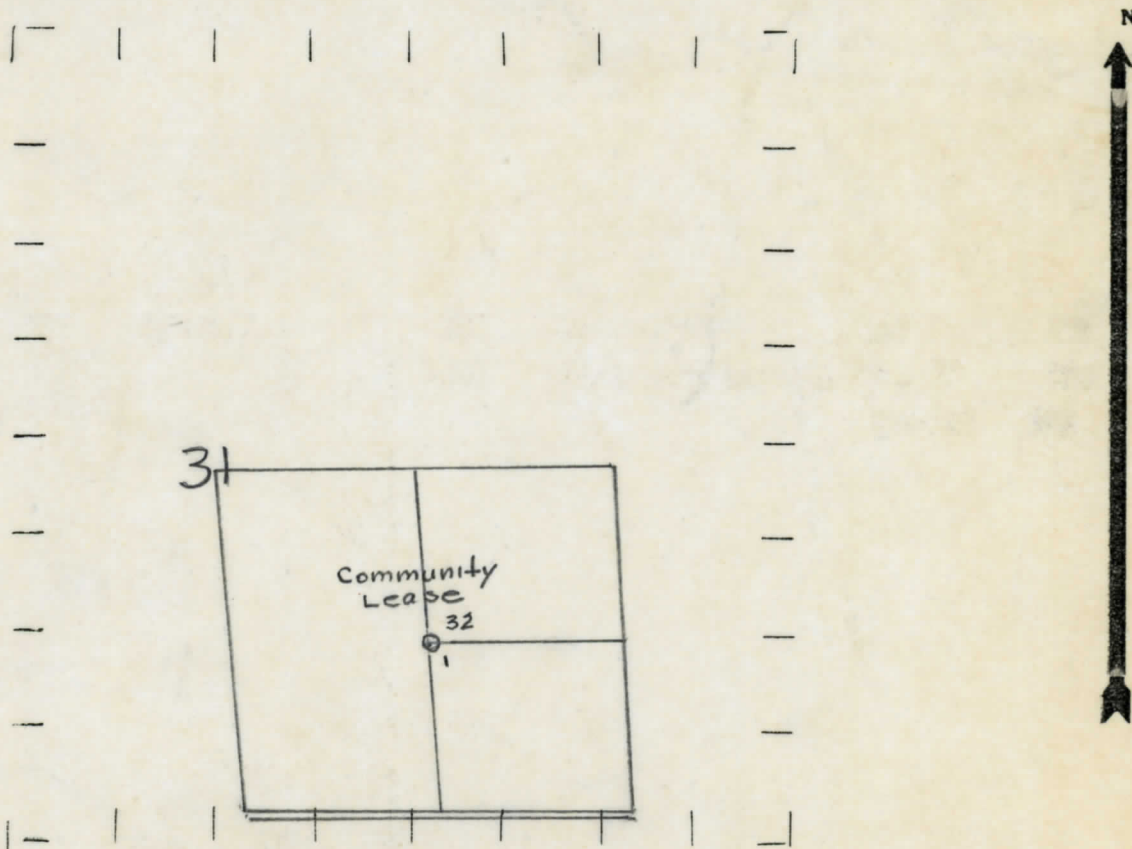

REMARKS:

SIGNED

C. W. Teater
Superintendent or Foreman.

THE PURE OIL COMPANY
The Pure Oil Company

COMPLETION RECORD OF WELLS DRILLED BY OTHER OPERATORS

Michigan Producing Division

Date **March 20, 1940** No. **32**

State **Mich.** County **Missaukee** ~~Enterprise~~ Twp. **Enterprise** Sec. **31** Twp. **23 N** Rge. **5 W**

Well No. **1** (Serial No.) **32** (County No.) Farm **Community Lease** Acres

Operator **C. W. Teater** Information secured ~~from~~ By **Scouting Department**

Date well started **3-3-40** Dated well completed **3-18-40** Elevation **1143.7**

PRODUCTION RECORD

1st 24 hours natural **Dry Hole**

2nd 24 hours natural

Date of shot No. of quarts From to From to

Date of acid No. of gallons

1st 24 hours after acid shot

2nd 24 hours after acid shot

FORMATION AND CASING RECORD

Formation	Top	Bottom	Top Pay	Bottom Pay	Remarks	Casing	
						Size	Set at
Stray	997	S.L.M.		997	Salt water.	10"	476
				1001	Black salt water.	6-5/8"	780
Total Depth		1005				5-3/16"	998

Remarks

Signed **D. C. Shackelford**