



Western Michigan University
ScholarWorks at WMU

Legacy Scout Tickets from Pure Oil Company

8-20-2021

**MGRRE_PureOilScoutTickets_Jager, Bogard,
Vanderheide_37_21113079530000**

MGRRE
Western Michigan University

Follow this and additional works at: <https://scholarworks.wmich.edu/pure>



Part of the Geology Commons

WMU ScholarWorks Citation

MGRRE, "MGRRE_PureOilScoutTickets_Jager, Bogard, Vanderheide_37_21113079530000" (2021). *Legacy Scout Tickets from Pure Oil Company*. 5859.
<https://scholarworks.wmich.edu/pure/5859>

This Document is brought to you for free and open access via ScholarWorks at WMU. It has been accepted for inclusion in Legacy Scout Tickets from Pure Oil Company by an authorized administrator of ScholarWorks at WMU. See the National Digital Catalogue - Science Base Catalogue for more collections submitted by MGRRE.



MGRRE_PureOilScoutTickets_Jager, Bogard, Vanderheide_37_21113079530000

API 21113079530000

Permit Number 7953

Lease Name Jager, Bogard, Vanderheide

Well Number 37

County Missaukee

Township 21N

Range 07W

Section 26

2021 DEQ or Pure co_name Taggart Brothers Company

Pure Number 38

Latitude 44.18242

Longitude -85.1183

THE PURE OIL COMPANY

LOCATION REPORT

No. 38

DATE August 28, 1940

STATE Michigan COUNTY Missaukee DIST. Riverside TWP. Riverside SEC. 26 TOWN 21 N RANGE 7 W
WELL No. 37 (SERIAL No. 38) FARM Jager-Bogard-Vanderheide ACRES

NAME OF STREAM OR WATERS QUADRANGLE C 58 F

OPERATOR Taggart Brothers, Inc. Map Riverside Township, Missaukee County
Taggart Bros., Inc. Riverside - Missaukee

Feet from North Line of Farm

1320 1320 " " East " " "

1320 1320 " " South " " "

" " West " " "

1320 1320 Feet from North Line of Section 1/4 1/4

" " East " " "

" " South " " "

1320 1320 " " West " " "

1370
53/16
8 1/4 450

LEGEND

- LOCATION
- ⊙ RIG
- ⊕ DRILLING
- ☀ GAS WELL
- OIL WELL
- ◆ SMALL OIL WELL
- ⊖ DRY HOLE
- ◆ DRY SHOWING OIL
- ⊖ DRY SHOWING GAS
- ⊖ ABANDONED LOCATION
- ☀ ABANDONED GAS WELL
- ◆ ABANDONED OIL WELL

NOTE: Below make tracing from map. (when no map is obtainable make sketch) showing farm, center of section, this location with measurements and also wells, dry holes, or other locations in the vicinity of this location.

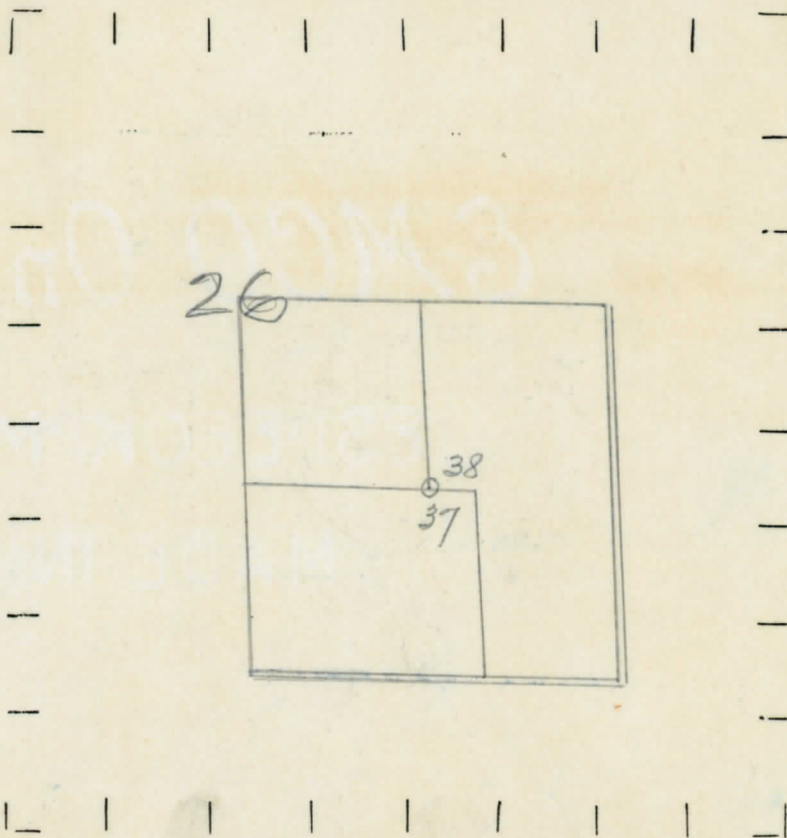

REMARKS:

SIGNED

Superintendent or Foreman.

Michigan Producing Division

Date September 5, 1940 No. 38
 State Mich. County Missaukee ~~Dubuque~~ Twp. Riverside Sec. 26 Twp. 21 N Rge. 7 W
 Well No. 37 (~~County No.~~) 38 Farm Jager-Bogard-Vanderheide Acres _____
 Operator Taggart Brothers, Inc. Information secured ~~from~~ By Scouting Department
 Date well started 8-24-40 Dated well completed 8-29-40 Elevation 1169.5

PRODUCTION RECORD

1st 24 hours natural Dry Hole
 2nd 24 hours natural _____
 Date of shot _____ No. of quarts _____ From _____ to _____ From _____ to _____
 Date of acid _____ No. of gallons _____
 1st 24 hours after acid shot _____
 2nd 24 hours after acid shot _____

FORMATION AND CASING RECORD

Formation	Top	Bottom	Top Pay	Bottom Pay	Remarks	Casing	
						Size	Set at
<u>Stray</u>	<u>1381</u>		<u>1395</u>	<u>1400</u>	<u>Water.</u>	<u>8-1/4"</u>	<u>450</u>
<u>Total Depth</u>		<u>1400</u>				<u>5-3/16"</u>	<u>1370</u>

Remarks _____

Signed D. C. Shackelford