



Western Michigan University  
ScholarWorks at WMU

---

Legacy Scout Tickets from Pure Oil Company

---

8-20-2021

**MGRRE\_PureOilScoutTickets\_De Bree, Bert\_1\_21113084680000**

MGRRE

*Western Michigan University*

Follow this and additional works at: <https://scholarworks.wmich.edu/pure>



Part of the Geology Commons

---

#### **WMU ScholarWorks Citation**

MGRRE, "MGRRE\_PureOilScoutTickets\_De Bree, Bert\_1\_21113084680000" (2021). *Legacy Scout Tickets from Pure Oil Company*. 5864.

<https://scholarworks.wmich.edu/pure/5864>

This Document is brought to you for free and open access via ScholarWorks at WMU. It has been accepted for inclusion in Legacy Scout Tickets from Pure Oil Company by an authorized administrator of ScholarWorks at WMU. See the National Digital Catalogue - Science Base Catalogue for more collections submitted by MGRRE.



---

**MGRRE\_PureOilScoutTickets\_De Bree, Bert\_1\_21113084680000**

API 21113084680000

Permit Number 8468

Lease Name De Bree, Bert

Well Number 1

County Missaukee

Township 21N

Range 07W

Section 23

2021 DEQ or Pure co\_name Turner Petroleum Corporation

Pure Number 43

Latitude 44.20132

Longitude -85.11629

THE PURE OIL COMPANY  
The Pure Oil Company  
LOCATION REPORT

DATE March 12, 1941

No. 43

STATE Michigan COUNTY Missaukee DISTRICT Riverside TWP. Riverside SEC. 23 TOWN 21/N RANGE 7/W

WELL No. 1 (SERIAL No. 43) FARM Bert DeBree Brce ACRES

NAME OF STREAM OR WATERS QUADRANGLE C S 2 SE NE

OPERATOR Turner Petroleum Corporation Map Riverside Township, Missaukee County  
Turner Pet. Co Riverside Missaukee

Feet from North Line of Farm

660	660	"	"	East	"	"	"
330	330	"	"	South	"	"	"
660	660	"	"	West	"	"	"

Feet from North Line of Section

660	660	"	"	East	"	<u>1/4</u>	"
330	330	"	"	South	"	"	"
		"	"	West	"	"	"

- LEGEND
- LOCATION
  - ⊙ RIG
  - ⊕ DRILLING
  - ☀ GAS WELL
  - OIL WELL
  - ⦿ SMALL OIL WELL
  - ⊖ DRY HOLE
  - ⦿ DRY SHOWING OIL
  - ⊖ DRY SHOWING GAS
  - ⊖ ABANDONED LOCATION
  - ☀ ABANDONED GAS WELL
  - ⦿ ABANDONED OIL WELL

NOTE: Below make tracing from map, (when no map is obtainable make sketch) showing farm, center of section, this location with measurements and also wells, dry holes, or other locations in the vicinity of this location.

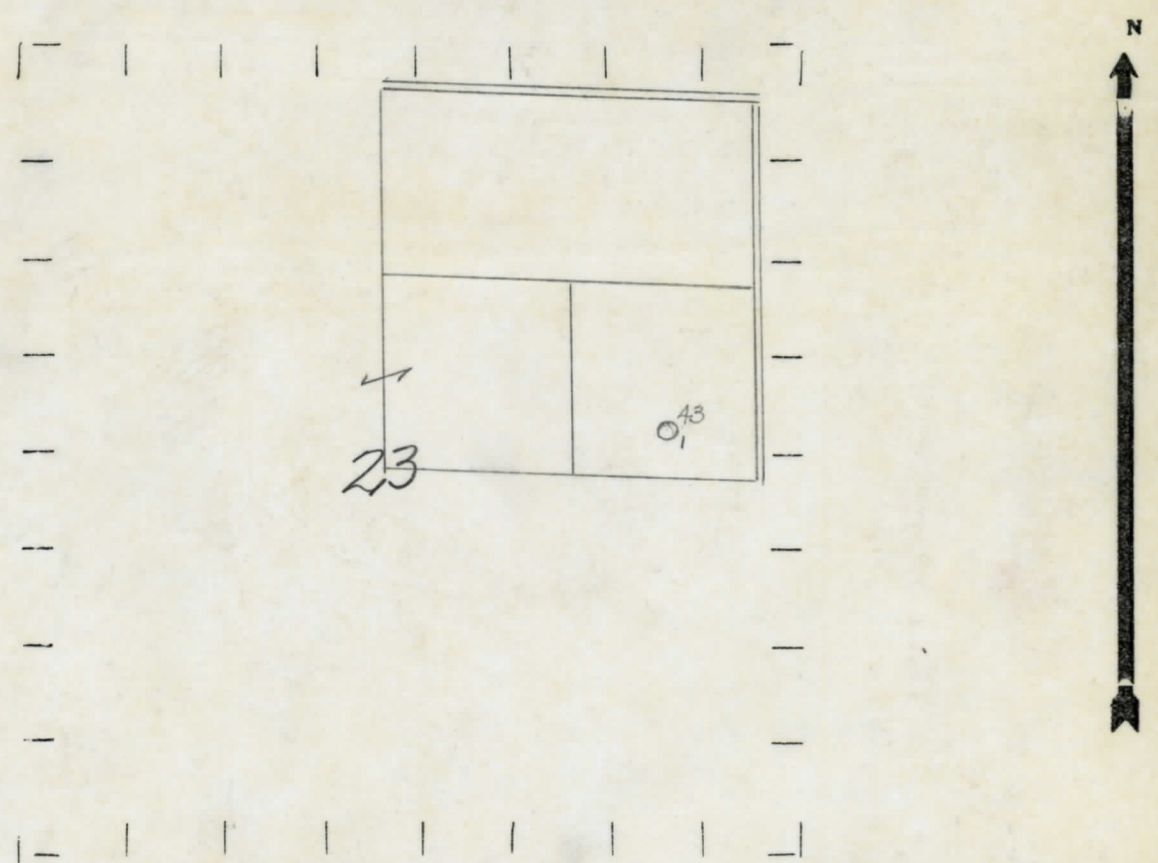

REMARKS:

---



---

SIGNED \_\_\_\_\_  
Superintendent or Foreman.

Date May 28, 1941 No. 43  
 State Mich. County Missaukee Dist. Riverside Twp. 21 N Rge. 7 W  
 Well No. 1 (Serial No.) 43 Farm Bert DeBree Acres \_\_\_\_\_  
 Operator Turner Petroleum Corporation Information secured from Scouting Department  
 Date well started 4-3-41 Date well completed 5-23-41 Elevation 1188.3

PRODUCTION RECORD

1st 24 hours natural Dry Hole  
 2nd 24 hours natural \_\_\_\_\_  
 Date of shot \_\_\_\_\_ No. of quarts \_\_\_\_\_ From \_\_\_\_\_ to \_\_\_\_\_  
 Date of acid \_\_\_\_\_ No. of gallons \_\_\_\_\_  
 1st 24 hours after acid \_\_\_\_\_ shot  
 2nd 24 hours after acid \_\_\_\_\_ shot

FORMATION AND CASING RECORD

Formation	Top	Bottom	Top Pay	Bottom Pay	Remarks	Casing	
						Size	Set at
Stray	1381	(Sample)				10"	70
Marshall	1477	"				6-5/8"	1652
Red Rock		1645 ?					
Sunbury	2462	2484					
Berea	2496						
Antrim	2507	(Sample)					
Traverse Form.	3231	C.T.M.					
Traverse Lime	3241 3234	S.L.M. C.T.M.					
Dolomitic Dundee	3913		3913	3915	Small show oil and gas.		
			3916 1/2	3935	Water-1000 ft.		
Total Depth		3935					

Remarks 1759' C.T.M. equals 1751' S.L.M.; 3449' C.T.M. equals 3456' S.L.M.; 3907' C.T.M. equals 3912' S.L.M.

Signed D. C. Shackelford