



Western Michigan University  
ScholarWorks at WMU

---

Legacy Scout Tickets from Pure Oil Company

---

8-20-2021

**MGRRE\_PureOilScoutTickets\_Blue, C\_1\_21113088700000**

MGRRE

*Western Michigan University*

Follow this and additional works at: <https://scholarworks.wmich.edu/pure>



Part of the Geology Commons

---

#### **WMU ScholarWorks Citation**

MGRRE, "MGRRE\_PureOilScoutTickets\_Blue, C\_1\_21113088700000" (2021). *Legacy Scout Tickets from Pure Oil Company*. 5873.

<https://scholarworks.wmich.edu/pure/5873>

This Document is brought to you for free and open access via ScholarWorks at WMU. It has been accepted for inclusion in Legacy Scout Tickets from Pure Oil Company by an authorized administrator of ScholarWorks at WMU. See the National Digital Catalogue - Science Base Catalogue for more collections submitted by MGRRE.



---

**MGRRE\_PureOilScoutTickets\_Blue, C\_1\_21113088700000**

API 21113088700000

Permit Number 8870

Lease Name Blue, C

Well Number 1

County Missaukee

Township 22N

Range 06W

Section 33

2021 DEQ or Pure co\_name Turner Petroleum Corporation

Pure Number 52

Latitude 44.25679

Longitude -85.05151

THE PURE OIL COMPANY

DATE August 20, 1941

LOCATION REPORT

No. 52

COMPLETION RECORD OF WELLS DRILLED BY OTHER OPERATORS

STATE Michigan COUNTY Missaukee DIST. Aetna TWP. Aetna SEC. 33 TOWN 22 N RANGE 6 W  
WELL No. 1 (SERIAL No. 52) FARM C. Blue

NAME OF STREAM OR WATERS QUADRANGLE C N 1/2 TWP SW - SW ACRES

OPERATOR Turner Petroleum Corporation Map Aetna Township, Missaukee County  
330 Turner Pet. Corp. Aetna Missaukee  
330 Feet from North Line of Farm

602 602 East " " "  
330 330 West " " "  
330 330 Feet from North Line of Section 1/4/4  
602 602 East " " "  
602 602 South " " "  
602 602 West 2/4 "

LEGEND

- LOCATION
- ⊕ RIG
- ⊕ DRILLING
- ☀ GAS WELL
- OIL WELL
- ♣ SMALL OIL WELL
- ⊖ DRY HOLE
- ◆ DRY SHOWING OIL
- ⊖ DRY SHOWING GAS
- ⊖ ABANDONED LOCATION
- ☀ ABANDONED GAS WELL
- ♣ ABANDONED OIL WELL

NOTE: Below make tracing from map, (when no map is obtainable make sketch) showing farm, center of section, this location with measurements and also wells, dry holes, or other locations in the vicinity of this location.

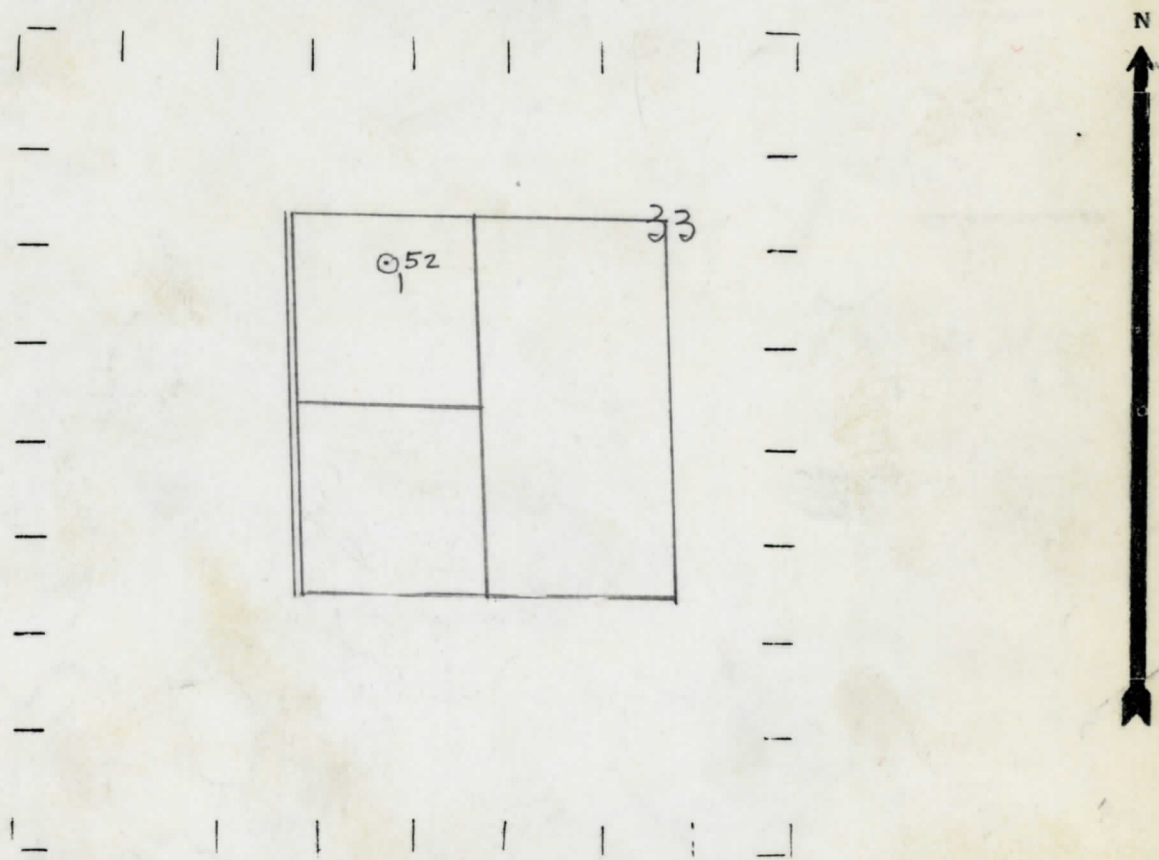

REMARKS:

SIGNED

W

Superintendent or Foreman.

Form 21-10M-1-25-40 1900-1900  
 330  
 OBEVYLOB  
 NAME OF OPERATOR OR MAINTENANCE  
 STATE  
 COUNTY  
 TWP. Aetna  
 SEC. 33  
 TOWN  
 RANGE  
 SECTION  
 TOWNSHIP  
 COUNTY  
 STATE  
 DATE  
 LOCATION  
 WELL NO.  
 (SERIAL NO.)  
 (COUNTY NO.)  
 FARM  
 ACRES  
 INFORMATION SECURED BY  
 DATE WELL STARTED  
 DATE WELL COMPLETED  
 ELEVATION

Date 10-22-41 No. 52  
 State Mich. County Missaukee Dist. Aetna  
 Twp. Aetna Sec. 33 Twp. 22-N Rge. 6-W  
 Well No. 1 (Serial No.)  
 (County No.) 52 Farm C. Blue Acres  
 Operator Turner Petroleum Corp. Information secured By Scouting Department  
 Date well started 8-21-41 Date well completed 10-14-41 Elevation 1178.3

PRODUCTION RECORD

1st 24 hours natural Dry Hole  
 2nd 24 hours natural  
 Date of shot No. of quarts From to From to  
 Date of acid No. of gallons  
 1st 24 hours after acid shot  
 2nd 24 hours after acid shot

FORMATION AND CASING RECORD

Formation	Top	Bottom	Top Pay	Bottom Pay	Remarks	Casing	
						Size	Set at
Brown Dolomite	1162					10"	667'
Mich. Stray	1317					8-1/4"	1032'
Marshall	1441	1565				6-5/8"	1581'
Sunbury	2450	2490				RH 5-3/16"	3854'
Antrim	2505						
Traverse Lime	3190	CTM			Show oil & gas at 3215. 6 bailers S.W. /Hr. at 3260		
Dundee	3897				Show oil & gas at 3900-04. 800' S.W. in 2 hrs. at 3955		
Total Depth		3955					

Remarks

Signed Dean C. Shackelford