



Western Michigan University  
ScholarWorks at WMU

---

Legacy Scout Tickets from Pure Oil Company

---

8-20-2021

## MGRRE\_PureOilScoutTickets\_Young, Smith, Toland, & Meyering\_65\_21113093170000

MGRRE

*Western Michigan University*

Follow this and additional works at: <https://scholarworks.wmich.edu/pure>



Part of the Geology Commons

---

### WMU ScholarWorks Citation

MGRRE, "MGRRE\_PureOilScoutTickets\_Young, Smith, Toland, & Meyering\_65\_21113093170000" (2021).  
*Legacy Scout Tickets from Pure Oil Company*. 5893.  
<https://scholarworks.wmich.edu/pure/5893>

This Document is brought to you for free and open access via ScholarWorks at WMU. It has been accepted for inclusion in Legacy Scout Tickets from Pure Oil Company by an authorized administrator of ScholarWorks at WMU. See the National Digital Catalogue - Science Base Catalogue for more collections submitted by MGRRE.



---

**MGRRE\_PureOilScoutTickets\_Young, Smith, Toland, &  
Meyering\_65\_21113093170000**

API 21113093170000

Permit Number 9317

Lease Name Young, Smith, Toland, & Meyering

Well Number 65

County Missaukee

Township 21N

Range 07W

Section 29

2021 DEQ or Pure co\_name Consumers Energy Company

Pure Number 72

Latitude 44.19

Longitude -85.17863

The Pure Oil Company  
**THE PURE OIL COMPANY**  
LOCATION REPORT

Serial No. 72  
A.F.E. No. \_\_\_\_\_  
*Young-Smith-Toland-Meyering*  
Young-Smith-Toland-Meyering

Date December 17, 1941

Division Mich. Producing District \_\_\_\_\_ Lease \_\_\_\_\_

Acres \_\_\_\_\_ Lease No. \_\_\_\_\_ Elevation \_\_\_\_\_ Well No. 655

Quadrangle C NE Sec. 29 Twp. 21 NW Rge. 7 W Twp. Riverside

Survey \_\_\_\_\_ County Missaukee State Michigan

Operator Taggart Brothers Company Map Riverside Township, Missaukee County

		Feet North of South Line of Lease			
1320	1320	East	West	"	"
1320	1320	South	North	"	"
1320	1320	West	East	"	"
		Feet North of South Line of Section			
1320	1320	East	West	"	"
		South	North	"	"
		West	East	"	"

*Low*

**LEGEND**

- Location
- ☀ Gas Well
- Oil Well
- or ○ Dry Hole
- or ● Dry Showing Oil
- ☀ Dry Showing Gas
- ⊗ Abandoned Location
- ☀ or ☀ Abandoned Gas Well
- or ● Abandoned Oil Well

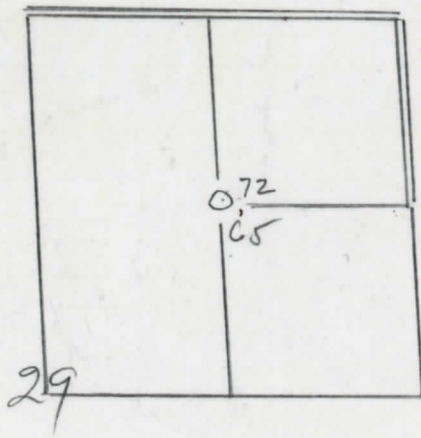

Scale \_\_\_\_\_

Remarks: \_\_\_\_\_  
\_\_\_\_\_  
\_\_\_\_\_

Submitted by W \_\_\_\_\_ Approved by \_\_\_\_\_  
Civil Engineer \_\_\_\_\_ Division Manager \_\_\_\_\_

Approved by \_\_\_\_\_  
Vice-President - General Manager \_\_\_\_\_

