



Western Michigan University
ScholarWorks at WMU

Legacy Scout Tickets from Pure Oil Company

8-20-2021

MGRRE_PureOilScoutTickets_Camlin, John H & Ellis, T M Estates_2_21113098850000

MGRRE

Western Michigan University

Follow this and additional works at: <https://scholarworks.wmich.edu/pure>



Part of the Geology Commons

WMU ScholarWorks Citation

MGRRE, "MGRRE_PureOilScoutTickets_Camlin, John H & Ellis, T M Estates_2_21113098850000" (2021).
Legacy Scout Tickets from Pure Oil Company. 5914.
<https://scholarworks.wmich.edu/pure/5914>

This Document is brought to you for free and open access via ScholarWorks at WMU. It has been accepted for inclusion in Legacy Scout Tickets from Pure Oil Company by an authorized administrator of ScholarWorks at WMU. See the National Digital Catalogue - Science Base Catalogue for more collections submitted by MGRRE.



**MGRRE_PureOilScoutTickets_Camlin, John H & Ellis, T M
Estates_2_21113098850000**

API 21113098850000

Permit Number 9885

Lease Name Camlin, John H & Ellis, T M Estates

Well Number 2

County Missaukee

Township 24N

Range 05W

Section 10

2021 DEQ or Pure co_name Oryx Energy Company

Pure Number 106

Latitude 44.48484

Longitude -84.89551

THE PURE OIL COMPANY LOCATION REPORT

Date December 2, 1942

A.F.E. No. _____

Division Mich. Producing

District _____

Lease John H. Camlin & T. M. Ellis Estates
John H. Camlin & T. M. Ellis Estates

Acres _____ Lease No. 10 Elevation 54N Well No. 2 (Serial No. 106)

Quadrangle C S 1/2 NE SE Sec. 10 Twp. 24 N Rge. 5 W Dist. Norwich
Norwich

Survey Sun Oil Co County Missaukee State Michigan

Operator Sun Oil Company Map Norwich Twp - Missaukee Co
Norwich Township, Missaukee County

<u>990'</u>	<u>990</u>	Feet from North Line of Lease
<u>660'</u>	<u>660</u>	" " East " " "
		" " South " " "
		" " West " " "
<u>990'</u>	<u>990</u>	Feet from North Line of Section <u>1/4</u>
<u>660'</u>	<u>660</u>	" " East " " "
		" " South " " "
		" " West " " "

LEGEND

- Location
- ☀ Gas Well
- Oil Well
- ☀ Gas - Distillate Well
- ∅ or ○ Dry Hole
- Dry Showing Oil
- ☀ Dry Showing Gas
- ⊗ Abandoned Location
- ☀ or ☀ Abandoned Gas Well
- or ● Abandoned Oil Well
- or ○ Input Well

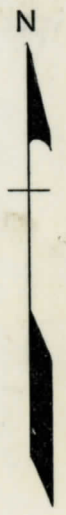
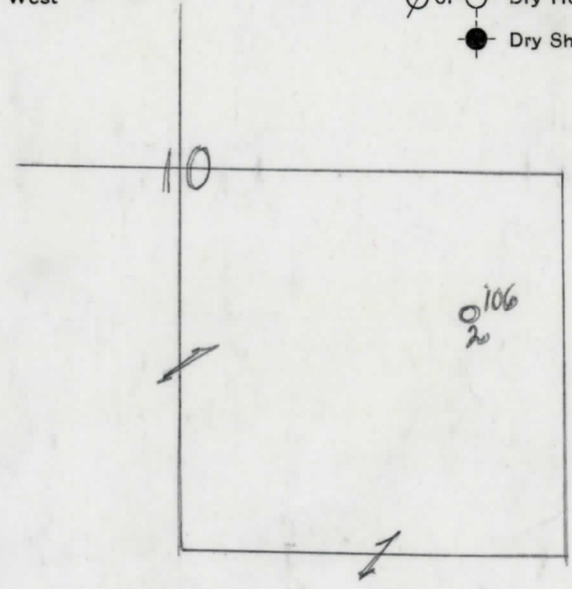

Scale _____

Remarks: _____

Submitted by N _____
Civil Engineer

Approved by _____
Division Manager

Approved by _____
Vice-President - General Manager

THE PURE OIL COMPANY

COMPLETION RECORD OF WELLS DRILLED BY OTHER OPERATORS

TCD

Michigan Producing Division

Date July 21, 1943 No. 106
 State Mich. County Missaukee ~~Dixie~~ Twp. Norwich Sec. 10 Twp. 24 N Rge. 5 W
 Well No. 2 (~~County No.~~) 106 Farm Canlin & Ellis Est. Acres _____
 Operator Sun Oil Company Information secured ~~from~~ Scouting Department
 Date well started 4-22-43 Date well completed 6-27-43 Elevation 1195.3

PRODUCTION RECORD

1st 24 hours natural 10 Barrels (Swabbed)
 2nd 24 hours natural _____
 Date of shot _____ No. of quarts _____ From _____ to _____ From _____ to _____
 Date of acid 6-30-43 No. of gallons 1000
 1st 24 hours after acid ~~XXXX~~ Flows 30 bbls. per day.
 2nd 24 hours after acid _____

FORMATION AND CASING RECORD

Formation	Top	Bottom	Top Pay	Bottom Pay	Remarks	Casing	
						Size	Set at
Marshall	617	780	DSM			14"	43
Traverse Form.	2360					8-1/4"	792
Traverse Lime	2388	SLM			S. Water 3148-3154.	5-3/16"	4361
Dundee	3084				Show oil & gas 4379.		
			4422	4425			
Total Depth		4475					

Remarks

Signed D. C. Shackelford